



OWNER'S MANUAL

www.bestwaycorp.com/support



Instructions for installation and operation
Ages: 5-10 years

IMPORTANT SAFETY INSTRUCTIONS

Read all instructions before assembling this inflatable device and keep instructions for future use.

FAILURE TO FOLLOW THESE INSTRUCTIONS COULD RESULT IN SERIOUS INJURY OR DEATH.

⚠ WARNING

⚠ WARNING

Electrocution Risk



Keep all electrical lines, radios, speakers, and other electrical devices away from inflatable device. Do not place inflatable device near or under overhead electrical lines.

⚠ WARNING

Prevent Drowning



Children under 5, especially toddlers are at highest risk of drowning. Closely watch children who are in or near this inflatable device. Empty inflatable device or prevent access when not in use.

Prevent Young Children from Drowning:

- Install fencing or other approved barrier around all sides of the inflatable device.
- State or local laws or codes may require fencing or other approved barriers. Check state or local laws and codes before setting up the inflatable device.
- Drowning occurs silently and quickly. Assign an adult to supervise the inflatable device.
- Keep children in your direct sight when they are in or near the inflatable device and when you are filling and emptying the inflatable device.
- When searching for a missing child, check the pool first, even if you think your child is in the house.

Be Prepared to Respond to an Emergency:

- Keep a working phone and list of emergency numbers near the inflatable device.
- Become certified in cardiopulmonary resuscitation (CPR) so you can respond to an emergency.

Warning:

- Failure to follow the installation and operating instructions present a risk of serious injury or death.
- Place the inflatable device on level ground, not less than 10ft (3m) in any direction from any structure or obstruction such as a fence, garage, house, overhanging branches, laundry lines, or electrical wires.
- Do not install inflatable device over concrete, asphalt, packed earth, carpet or any other hard surface. A fall onto a hard surface can result in serious injury to the user.
- To be used on soft ground only, the impact absorbing material (eg. Rubber mulch, engineered wood fiber (EWf) etc) shall be at least 6.6ft (2m) from opening in all directions away from the inflatable device.

Item	Age	Maximum number of users	Maximum weight capacity	Critical fall height	Maximum fall height
53302E; 53319E	5-10 years	5	600lbs (270kg)	76in (192cm)	56in (142cm)
53304E	5-10 years	7	840lbs (381kg)	66in (167cm)	56in (142cm)
53306E	5-10 years	9	1081lbs (490kg)	66in (167cm)	56in (142cm)

⚠ AIR-BLOWER SAFETY INFORMATION

- READ AND SAVE THESE INSTRUCTIONS
- USE ONLY ON GFCI PROTECTED RECEPTACLES

WARNING:

- To reduce the risk of fire or electric shock, do not use this air blower with any solid-state speed control device.
- Prevent sharp and hard objects from dropping into and prevent liquid from flowing into the air blower.
- Do not wash the air blower with liquid, you must first unplug it from power source and then wipe it with wet cloth when you clear it.
- Do not draw and pull motor leads, and do not bump the air blower, you'd better use the air blower between negative five and fifty centigrade. If you let the air blower be baked in the high temperature, motor leads enamelled cables and heating bodies will aging and shorten it's life.

KEEP CHILDREN AWAY: Do not allow children to play with or around the unit, in any way, which could result in injury.

PROTECT POWER CORD FROM DAMAGE: Never operate a unit with a damaged power cord, as this may lead to electrical or fire hazards. If the power supply cord is damaged, it must be replaced by a cord of the same type and amperage rating.

OPERATION

Place the air blower on a steady net surface where children can be kept away. This air blower is for use on a nominal 120-volt circuit and has a grounding plug similar to the plug illustrated in sketch (A). Only connect the product to an outlet having the same configuration as the plug. Do not use an adapter with this product.

Keep Unit Grounded: air blower should be grounded. In the event of an electrical short circuit, grounding reduces the risk of electric shock by providing an escape wire for the electric current. This product is equipped with a cord having a grounding wire with an appropriate grounding plug. The plug must be plugged into an outlet that is properly installed and grounded in accordance with all local codes and ordinances.

Warning: Improper installation of the grounding plug is able to result in a risk of electric shock. When repair or replacement of the cord or plug is required, do not connect the grounding wire to either flat blade terminal.

The wire with insulation having an outer surface that is green with or without yellow stripes is the grounding wire.

CAUTION: Check with a qualified electrician or serviceman when the grounding instructions are not completely understood, or when in doubt as to whether the air blower is properly grounded. Do not modify the plug provided. If it will not fit the outlet, have the proper outlet installed by a qualified electrician. The appliance must be positioned so that the plug is accessible. If the supply cord is damaged, it must be replaced by the manufacture or its service agent or a similarly qualified person in order to avoid a hazard.

GROUNDING METHODS Sketch A

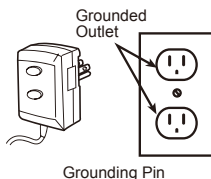

ON/OFF SWITCH
OFF — O
ON — I

GFCI Test

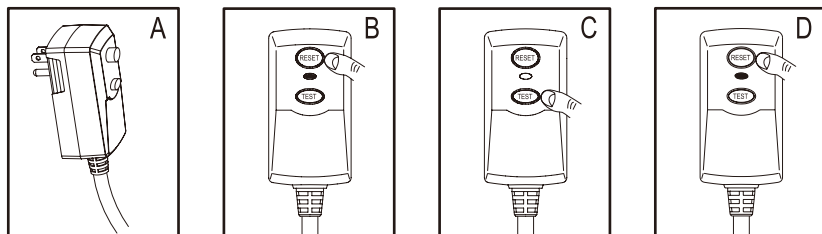

A. To test the GFCI plug, insert it into a grounding type receptacle.

B. Press the "RESET" button; the indicator turns red.

NOTE: If the indicator light is not on, the test has failed.

C. Press the "TEST" button. The indicator turns off.

NOTE: If the indicator light is not off, the test has failed.

D. Press the "RESET" button, the indicator light turns red, and the blower is ready for use.

WARNING: Risk of electric shock. The GFCI must be tested before each use.

WARNING: Do not use the blower if the above test fails. Please contact your local Bestway Customer Service.

Setup Instruction

Placement:

Use on a flat, grassy area only. Do not use on pavement or hard surfaces. Usage area should be free of rocks, bumps, holes, sticks, etc. The water park setup location should have a minimum distance of 10ft (305cm) from any free-standing structures or obstructions. this include: houses, garages, fences, trees, playground equipment, large rocks, etc.

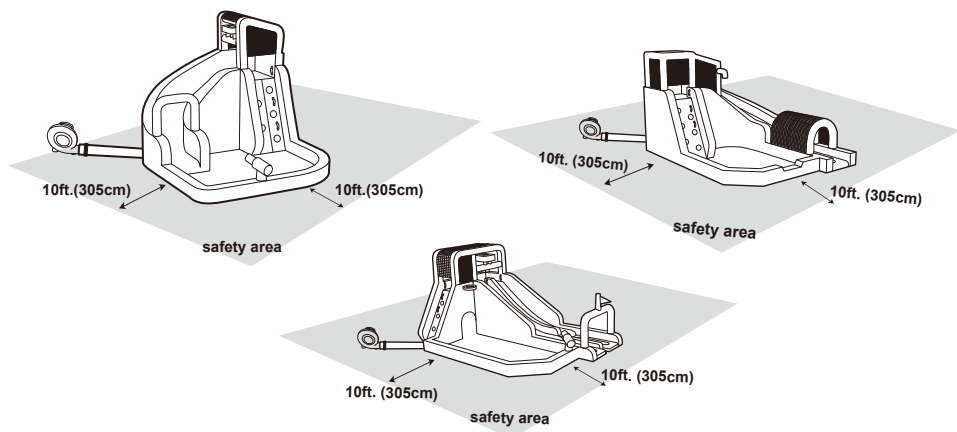

Assembly

Place on level ground and firm grass or soil to allow proper use of stakes.

Do not set up the inflatable device on a slope or incline.

Stakes should be placed at an angle for better anchorage, should be driven under the ground to prevent tripping.

Do not use the product if wind speed exceeds 20 mph.

Do not set up in windy or rainy conditions: sudden gust of wind may lift the product off the ground.

Only the blower provided or other manufacturer specified replacement blower should be used for inflation.

Use only with Ground Fault Circuit Interrupter(GFCI) receptacle.

Do not use extension cords with this product and keep the blower and power cord away from water.

Product shall be fully inflated and anchored before use.

Anchor points: #53302E, #53319E, #53304E: 8; #53306E: 9.

Attention: Each anchor bag should be filled to 40lbs.(18kg) of water. Each anchor bag must be attached while using the park (Only for #53302E, #53319E, #53304E).

After inflation, the blower should run continuously while children are playing.

Draining & Deflation

IMPORTANT: Drain the water park of all water to prevent mold and mildew. Product should be completely dry before storage. Do not fold and store water park if any moisture remains.

IMPORTANT: All children must exit the water park before deflation or draining.

1. Turn off the garden hose and disconnect it from the tube.
2. Turn off the blower motor and unplug it from the outlet. Move the blower to dry ground if it appears that it will get wet from draining water.
3. Open the water valve and drain the water.
4. Remove stakes and drag water park away from the drained water to a dry area.
5. Re-stake the water park and blower, tie the inflation tube to the blower, then reconnect and power up the blower.
6. Leave the water park inflated until all remaining water has evaporated and the water park is dry.
7. Once water park is completely dry, turn off the blower and unplug it from the outlet.
8. Remove and drain the hose assembly from the Water park. Untie the drawstring from the short outlet tube and allow the water park to fully deflate. Remove the hose assembly and wrap it up with no kinks.

WARNING

- Constant, competent adult supervision of children and other young users is required at all times in front of the device where all parts of play areas can be seen.
- Keep the area around the product clean, and clear of objects, to prevent slips and falls.
- Always check all anchors before and during use.
- To prevent electric shock, do not clean the blower with water.
- Children should not wear loose or baggy clothing, scarves, hoods or clothing with drawstrings or long cords while playing in this product.
- Children must remove helmets, loose clothing, scarves, headgear, shoes and glasses, as well as any sharp or hard objects from their pockets, as they may puncture the bounding surface.
- Separation of larger children from smaller children. Do not allow children to play together who are unevenly matched in weight and height.
- Do not allow users to climb or hang on containment walls.
- Do not allow users to do somersaults or rough play.
- Do not allow food, drink or gum inside unit.
- Children must not slide down head first on their stomach.
- Keep pets away from product.
- Do not attach items to the inflatable device that are not specifically designed for use with the inflatable device, such as, but not limited to, jump ropes, clothesline, pet leashes, cables and chain as they have the potential to cause a strangulation hazard.

MAINTENANCE OF WATER PARK

1. To keep the product clean: wipe the inflatable device using a dry cloth or a cloth dampened with a neutral, non-flammable, non-toxic cleaning and sanitizing solution or pure water.
2. If applicable, remove water and debris from pocket steps after each play cycle.
3. As an outdoor product, the inflatable device is subject to wear and deterioration. Inspect for signs of fabric failure; weak or torn surface must be repaired promptly.

MAINTENANCE OF AIR BLOWER

1. Conveyance: During conveying the air-blower, you don't collide and shake seriously; Please prevent sour, alkali, oil and water from entering the air-blower, the air-blower need damp proof.
2. DANGER! Unplug or disconnect the appliance from the power supply before servicing. When the air-blower have run about half of one year, it need to be maintained, and you should get rid of dust, dirt and the other things on the inlet, impeller and in the volute, the source of electrical supply must be disconnected prior to the beginning of any such servicing or cleaning operation.
3. Clear Motor: Please replace lubricating oil on the bearing regularly. If the bearing has worn down, you may replace it.

Storage

IMPORTANT:

1. Never store the water park when wet. Allow to dry before folding for storage. Follow all previous instructions each use.
2. Store park in a secure place away from children to prevent suffocation hazards. Never leave either the park or the blower outside when not in use.
3. Please place it the dry and ventilated position where is not sour, not alkali and not corrosive gases. After having used it in outdoors, you should place it in a dry and ventilated room in time. Do not let water into the air-blower.

1

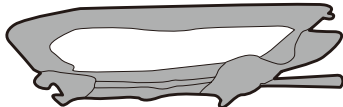

Fold all pieces of the water park toward the center.
Note: If bottom surface is still moist, allow it to air dry prior to folding.

2



Note: Do not place the water spray tubing inside the water park when rolling it up

Roll up the water park tightly and compress the fabric to expel all of the remaining air.

3

Slip the carrying bag over the rolled-up inflatable park. Flip the bag and the park over, close the bag, and store the park and the blower in a dry place.

To extend the life of the water spraying hose assembly, store it in a adequately ventilated area. Do not store them together with the park.

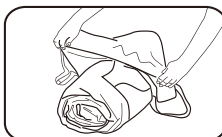

Repair Patch Instructions

1

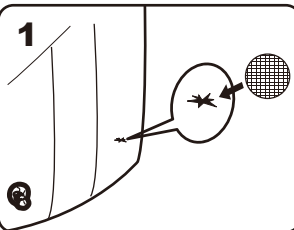

2

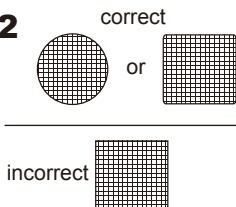

1. Defalte the item, clean the area and allow to dry thoroughly.
2. Cut a portion of the patch to the size needed and round the corners. (See Fig.1&2).
3. Apply the repair patch:
Option #1: Using the vinyl patch.
Remove the adhesive backing from the patch material, position the patch over the damaged area and smooth out any bubbles.
Option #2: Using the fabric patch and the glue (not included).
Apply only the amount of glue(not included) needed to cover the repair site and press patch firmly over the puncture.
4. Allow to sit for 30 minutes before re-inflating.

Warning: Repair patched must be applied by an adult only. Keep out of children.

Troubleshooting

PROBLEM	CAUSE
Motor won't run	<ol style="list-style-type: none"> 1. Switch not turned on. 2. The circuit is opened or it is poor contact. 3. Electric capacity is damaged. 4. Choked up by hard objects.
Motor runs but wheel makes a scraping noise	<ol style="list-style-type: none"> 1. Screws on the vaned wheel are loose. 2. Foreign objects in air-blower.
Motor is unable to run normally	<ol style="list-style-type: none"> 1. The voltage is unstable. 2. Motor is affected with damp. 3. Electric capacity is failure. 4. The impeller is loose.

#53302E

001	P62047	1
002	P62035	1
003	P62042	4
004	P62044	1
005	P5J727	8
006	P62050	1
007	/	1
008	P62053	1



001



002



003



004



005

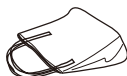

006



007



008

#53319E

001	P00331	1
002	P62035	1
003	P62042	4
004	P00332	1
005	P5J727	8
006	P62050	1
007	/	1
008	P62053	1



001



002



003



004



005



006



007



008

#53304E

001	P62048	1
002	P62040	1
003	P62043	2
004	P62045	1
005	P5J727	8
006	P62051	1
007	/	1
008	P62053	1
009	P62054	1



001



002



003



004



005



006



007



008



009

#53306E

001	P62049	1
002	P62036	1
003	P62043	2
004	P62046	1
005	P5J727	9
006	P62052	1
007	/	1
008	P62055	2
009	P62056	1



001



002



003



004



005



006



007



008



009

#53302E / #53319E

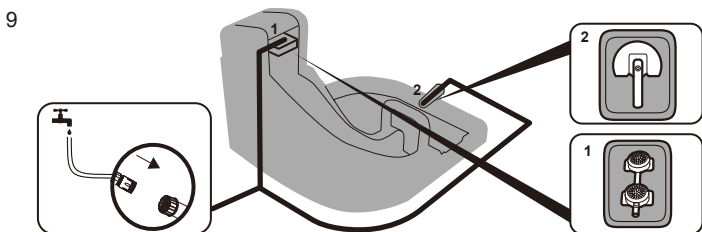
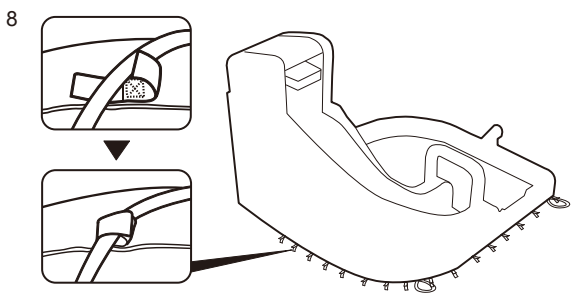
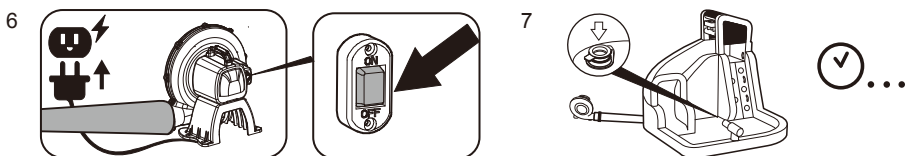
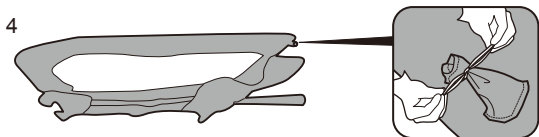

10

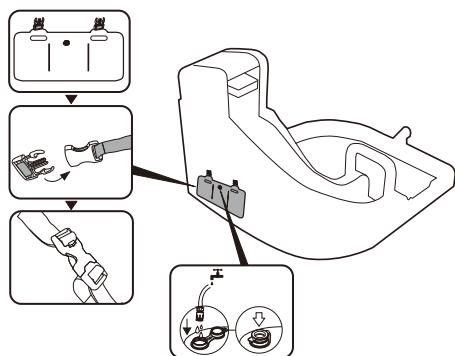

11

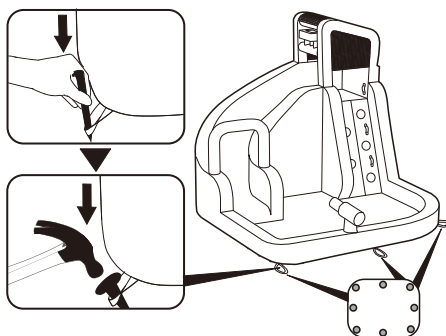

#53304E

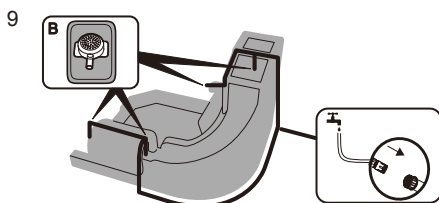
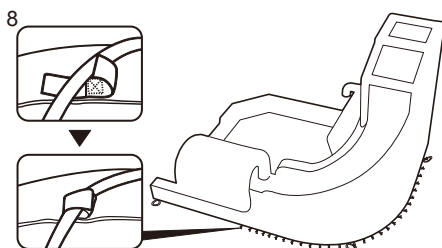
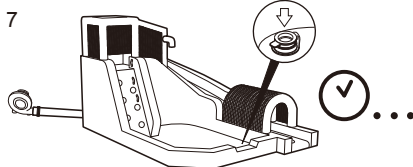
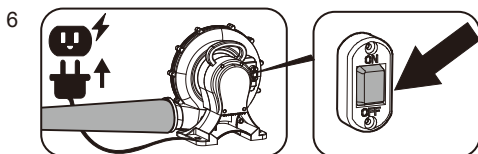
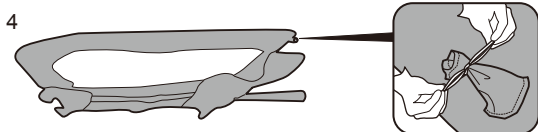

10

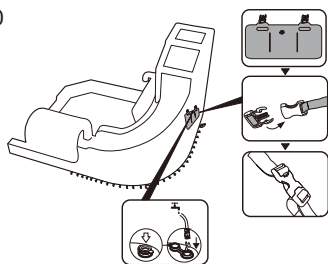

11

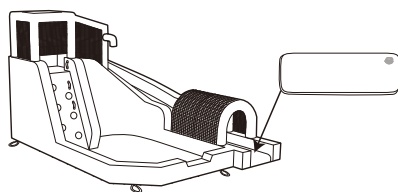

12

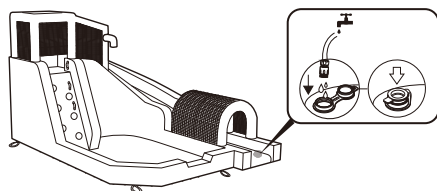

13

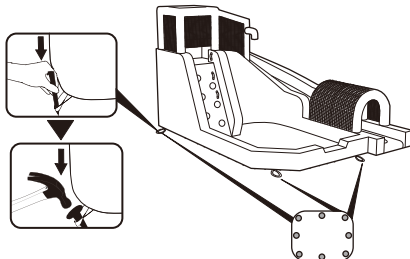

#53306E

1



2

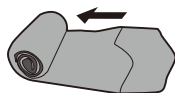

3



4

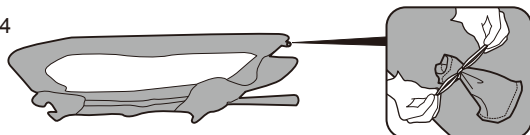

5



6

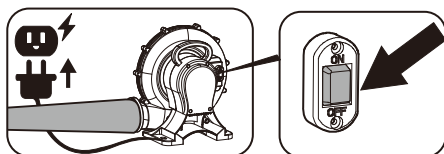

7

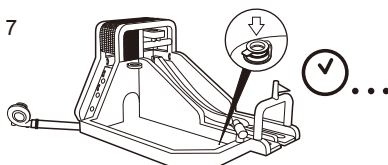

8

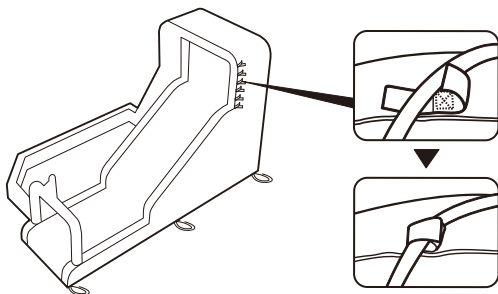

9

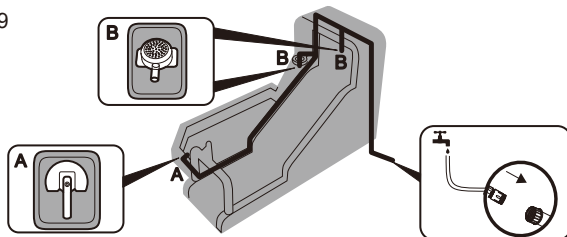

10

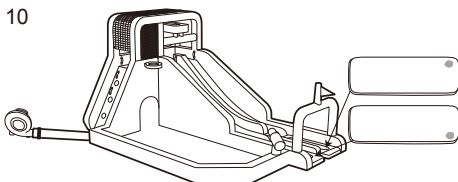

11

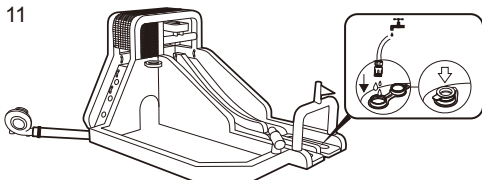

12

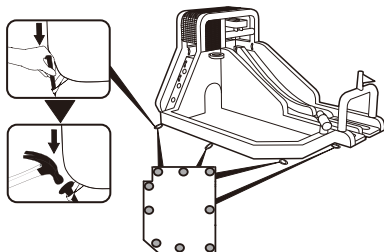

For support please visit us at:
www.bestwaycorp.com/support

©2018 Bestway Inflatables & Material Corp.

All rights reserved/Tous droits réservés / Todos los derechos reservados / Alle Rechte vorbehalten / Tutti i diritti riservati

®™ Trademarks used in some countries under license to/ Marques ®™ utilisées dans certains pays sous la licence de /
 Marcas comerciales ®™ utilizadas en algunos países bajo la licencia de / ®™ Die Warenzeichen werden in einigen Ländern verwendet unter Lizenz der /
 ®™ Marchi utilizzati in alcuni paesi concessi in licenza a

Bestway Inflatables & Material Corp., No.3065 Cao An Road, Shanghai, 201812, China.

Manufactured, distributed and represented in the European Union by/Fabriqués, distribués et représentés dans l'Union Européenne par/
 Fabricado, distribuido y representado en la Unión Europea por/Hergestellt, vertrieben und in der Europäischen Union vertreten von /
 Prodotto, distribuito e rappresentato nell'Unione Europea da

Bestway (Europe) S.r.l., Via Resistenza, 5, 20098 San Giuliano Milanese (Milano), Italy

Distributed in North America by/Distribúes en Amérique du Nord par/Distribuido en Norteamérica por

Bestway (USA) Inc., 3411 E. Harbour Drive, Phoenix, Arizona 85034, United States of America

Tel: 1-855-838-3888 (For U.S. and Canada)

Distributed in Latin America by/Distribué en Amérique latine par/Distribuido en Latinoamérica por/Distribuido na América Latina por

Bestway Central & South America Ltda, Salar Ascotan 1282, Parque Enea, Pudahuel, Santiago, Chile

Distributed in Australia & New Zealand by **Bestway Australia Pty Ltd, 98-104 Carnarvon Street, Silverwater, NSW 2128, Australia**

www.bestwaycorp.com

Made in China / Fabriqué en Chine / Fabricado en China / Hergestellt in China / Prodotto in Cina

Bestway