

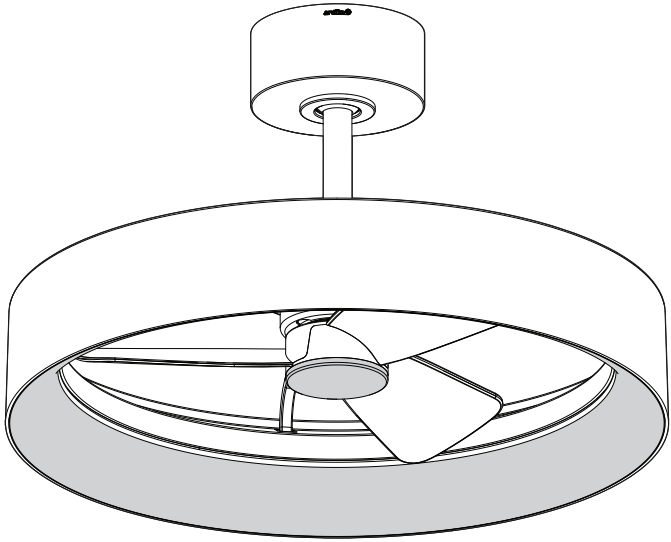

ITM. / 貨號 1806207

Model / 型號: FAN-AUR-C10BL



LED Ceiling Fan - Austin™

INSTRUCTION MANUAL

IMPORTANT, KEEP FOR FUTURE REFERENCE:
PLEASE READ CAREFULLY.

The light source contained in this luminaire shall only be replaced by the manufacturer or his service agent or a similar qualified person.

LED 吊扇 - Austin™

說明書

重要事項，請妥善保存以備日後參考：
請仔細閱讀

本燈具所含的光源僅可由製造商或其服務代理商或類似的合資格人員更換。

100-240 V~; 50-60 Hz; Max. 70 W; Class I; IP20;

Lamp power 40

Rev. 10-31-2025



Made in China
Residential use only
Indoor use only

中國製造
僅供住宅使用
僅限室內使用

INCLUDED HARDWARE
内含安装工具

ITEM 配件	DESCRIPTION 描述	QUANTITY 数量
A 	Wall anchor 膨脹螺絲	× 3
B 	L Bracket L型支架	× 1
C 	Mounting bracket 安裝支架	× 1
D 	Canopy screw 頂蓋螺絲	× 2
E 	Retaining screw 固定螺絲	× 3
F 	Main rod 主桿	× 1
G 	Security Hook 安全掛鉤	× 1
H 	Canopy 頂蓋	× 1
I 	Canopy cover 頂蓋罩	× 1

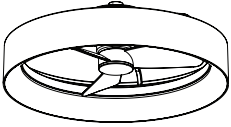
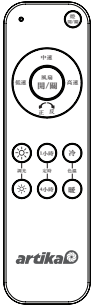
INCLUDED HARDWARE
内含安装工具

ITEM 配件	DESCRIPTION 描述	QUANTITY 数量
J 	Coupling cover 接頭罩	× 1
K 	LED Ceiling Fan LED吊扇	× 1
	Remote 遙控器	× 1
	Battery 電池	× 1
	Small flat screwdriver 小型平頭螺絲刀	× 1

CAUTION
注意



WARNING:

Risk of electrical shock.
Turn off breaker
at the panel.

警告：

電擊風險。
關掉電板上的電路器。

Do not use outdoor.

請勿用於戶外。

CAUTION

Do not use with dimmer.

注意

請勿與調光器一起使用。

IMPORTANT

The installer and/or user must read, understand and follow these instructions before installing the product. This product must be properly installed before it is used. If instructions are not followed, the manufacturer will not be held responsible for any problems or product malfunction. Failure to follow installation and/or operating instructions voids the warranty.

We recommend that this product be installed by a certified electrician. In some states or provinces, it is a legal requirement for this type of product to be installed by a certified electrician, according to the electrical and building codes effective in the region where the unit is used.

重要事項

安裝者或者用戶須知，安裝產品前必須閱讀理解和遵守以下指令。產品須被正確安裝方可使用。如未遵守說明，廠商將不對任何問題或產品故障負責。未遵守安裝或操作說明將無法獲得產品保修服務。

我們建議由有資質的電工來安裝本產品。在某些使用這些產品地區的州或省份，根據生效的電工和建築法規，需由持證電工來安裝該等產品是法定要求。

CARE OF YOUR FAN 風扇維護



Here are some suggestions to help maintain your fan.

1. Because of the fan's natural movement some connections may become loose. Check the support connections, brackets and blade attachments twice a year. Make sure they are secure. (It is not necessary to remove fan from the ceiling).
2. Clean your fan periodically to help maintain its new appearance over the year. CAUTION many common household cleaning products contain chemicals that could damage the finish of your fan. Use only a soft lint free cloth and soapy water.
3. Use a lint free lightly damp cloth or duster to remove dust from the blades.
4. There is no need to oil your fan. The motor has permanently lubricated bearings.

以下是一些幫助維護風扇的建議。

1. 由於風扇的自然運轉，有些連接可能會鬆動。每年檢查兩次支撐連接件、支架和扇葉附件。確保其安全固定。（無需將風扇從天花板上拆下。）
2. 定期清潔風扇，以幫助保持其全年如新的外觀。請注意，許多常見家用清潔產品含有可能損壞風扇表面的化學物質。
只能使用無絨的軟布和肥皂水。
3. 使用無絨的微濕布或除塵刷清除扇葉片上的灰塵。
4. 風扇無需上油。馬達具有永久性潤滑的軸承。

WARNING:

MAKE SURE THE POWER IS OFF AT THE ELECTRICAL PANEL BOX BEFORE YOU ATTEMPT ANY REPAIRS. REFER TO THE SECTION ELECTRICAL CONNECTIONS.

警告：

在試圖進行任何維修之前，請確保配電箱的電源已經關閉。

請參閱「電氣連接」部分

WARNING

警告



Ensure that the fan is switched off from the supply mains before maintenance or cleaning.

The appliance is not to be used by persons (including children) with reduced physical, sensory or mental capabilities, or lack of experience and knowledge, unless they have been given supervision or instruction.

Children being supervised not to play with the appliance.

If unusual oscillating movement is observed, immediately stop using the ceiling fan and contact the manufacturer, its service agent or suitably qualified persons.

The replacement of parts of the safety suspension system device shall be performed by the manufacturer, its service agent or suitably qualified persons.

This appliance can be used by children aged from 8 years and above and persons with reduced physical, sensory or mental capabilities or lack of experience and knowledge if they have been given supervision or instruction concerning use of the appliance in a safe way and understand the hazards involved.

Children shall not play with the appliance.

Cleaning and user maintenance shall not be made by children without supervision.

在維護或清潔之前，請確保風扇的電源已斷開。

本電器不預期供生理、感知、心智能力、經驗或知識不足之使用者(包含孩童)使用，除非在對其負有安全責任之人員之監護或指下安全使用。孩童應受監護，以確保孩童不嬉玩電器。

如果發現吊扇有異常擺動，請立即停止使用，並聯絡製造商、其服務代理商或合資格人員。

安全懸吊系統裝置的零件更換應由製造商、其服務代理商或合資格人員進行。

年滿8歲的兒童以及身體、感覺或精神能力受損或者缺乏經驗和知識的人士，只能在監督下或已經獲得關於電器安全使用方法的說明以及瞭解相關風險的情況下，可以使用本電器。

兒童不得將本電器作為玩具。

在沒有監督的情況下，兒童不得對電器進行清潔和用戶維護。



No obvious symptoms

- Unfortunately, it is not obvious when a button or coin battery is stuck in a child's esophagus (food pipe).

There are no specific symptoms associated with this. The child might:

- cough, gag or drool a lot;
- appear to have a stomach upset or a virus;
- be sick;
- point to their throat or stomach;
- have a pain in their abdomen, chest or throat;
- be tired or lethargic;
- be quieter or more clingy than usual or otherwise "not themselves";
- lose their appetite or have a reduced appetite; • and not want to eat solid food / be unable to eat solid food.

These sorts of symptoms vary or fluctuate, with the pain increasing and then subsiding.

A specific symptom to button and coin battery ingestion is vomiting fresh (bright red) blood. If the child does this seek immediate medical help.

The lack of clear symptoms is why it is important to be vigilant with "flat" or spare button or coin batteries in the home and the products that use batteries in the home and the products that contain them.

無明顯症狀

- 不幸的是，鈕扣或幣型電池卡在兒童食道（食管）中並不明顯。

沒有相關的具體症狀。兒童可能：

- 經常咳嗽、作嘔或流口水；
- 出現胃部不適或病毒感染症狀；
- 惡心想吐；
- 指向他們的喉嚨或胃部；
- 腹部、胸部或喉嚨疼痛；
- 疲倦或嗜睡；
- 比平時更安靜或更黏人，或在其他方面「變得不像他們自己」；
- 食欲不振或食量減少；
- 以及不想吃固體食物/不能吃固體食物。

這些症狀可能會變化或波動，伴有疼痛加劇後減輕。

吞嚥鈕扣或幣型電池的具體症狀是吐鮮血（鮮紅色）。如果兒童有該症狀，請立即就醫。

由於缺乏明確症狀，因此必須對家中的「無電」或備用鈕扣或幣型電池，以及家中使用電池的產品和含有電池的產品保持警覺。

CAUTION
注意



IMPORTANT

Caution, mount with the lowest parts at least 2.3 meters above the floor or grade level.

The setting screws must be securely tightened before operating the fan.

WARNING:

Do NOT Use This Fan With Any Solid-State Speed Control Device

Date: 12.27

重要事項

注意：安裝時，最低部分應距離地面或樓面至少 2.3米。

操作風扇前，必須將緊固螺絲牢牢擰緊。

警告：

請勿將本風扇與任何固態速度控制裝置一起使用

日期：12月27日

The mounting bracket is not designed to exceed 15.9 kg (35 lbs) of total weight.

安裝支架的設計不可承受超過 15.9 公斤（35 磅）的總重量。

IMPORTANT

This product contains a light source of energy efficiency class F

FAN-AUR-C10BL

重要事項

本產品含有能效F級光源。

FAN-AUR-C10BL

FAN WEIGHT / 風扇重量
4.1 kg / 公斤 (9.04 lbs / 磅)

1 STEP-BY-STEP INSTALLATION

逐步安裝

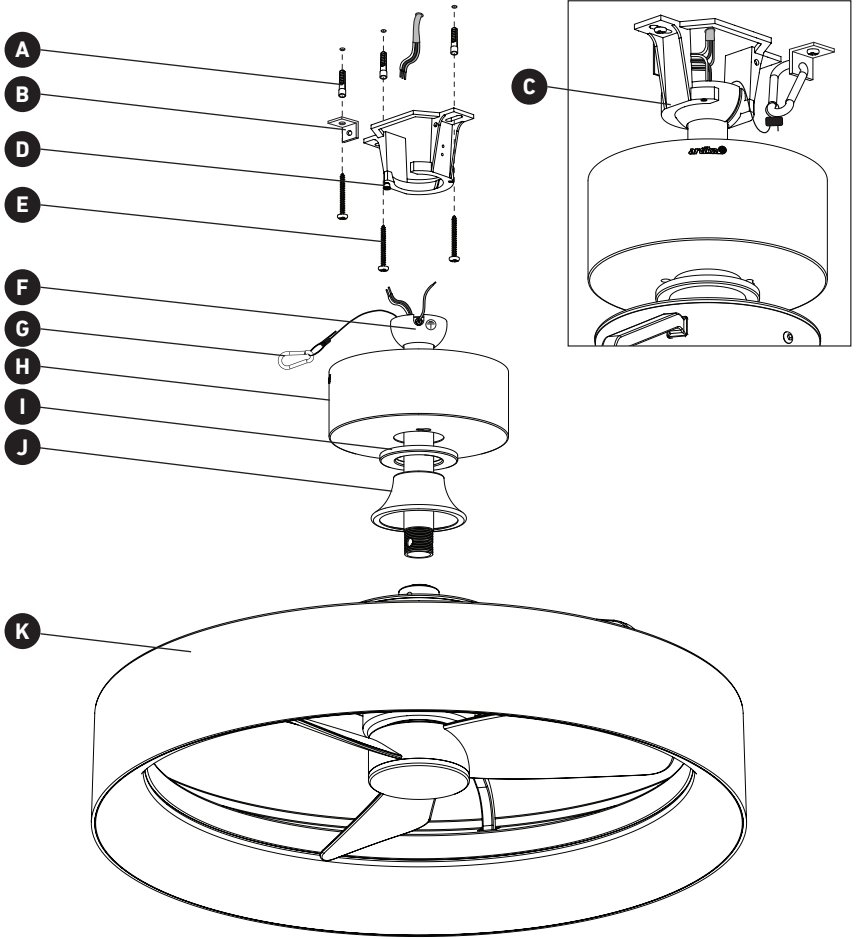

WHAT YOU WILL NEED

所需工具 (不包含)

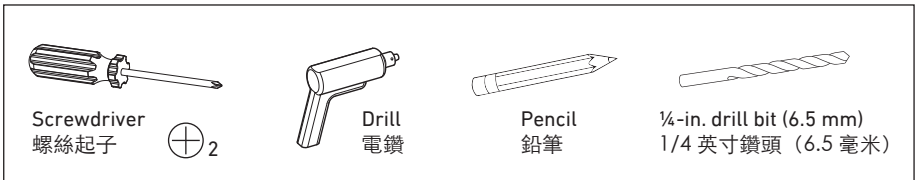

2 MOUNTING BRACKET INSTALLATION 安裝支架安裝

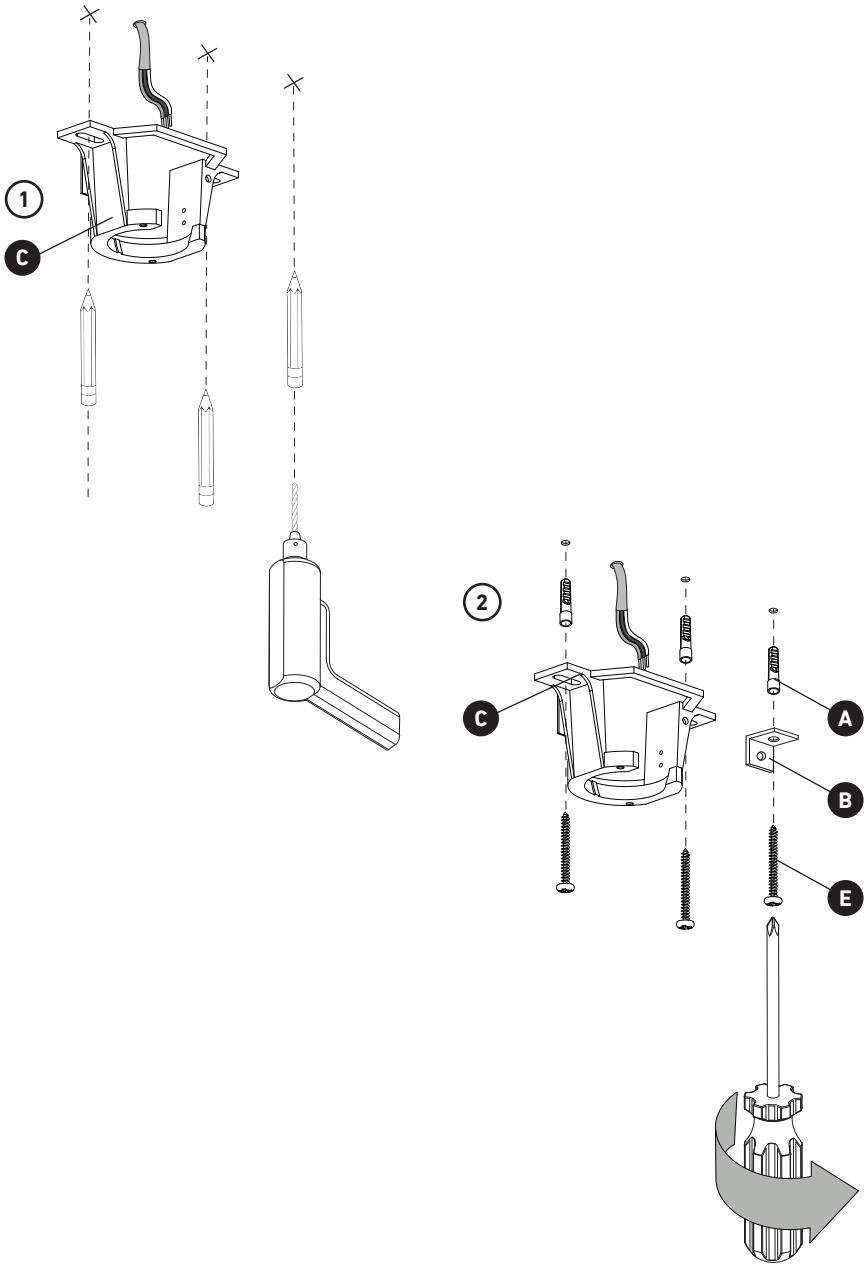

3 MAIN ROD PREPARATION 主桿準備

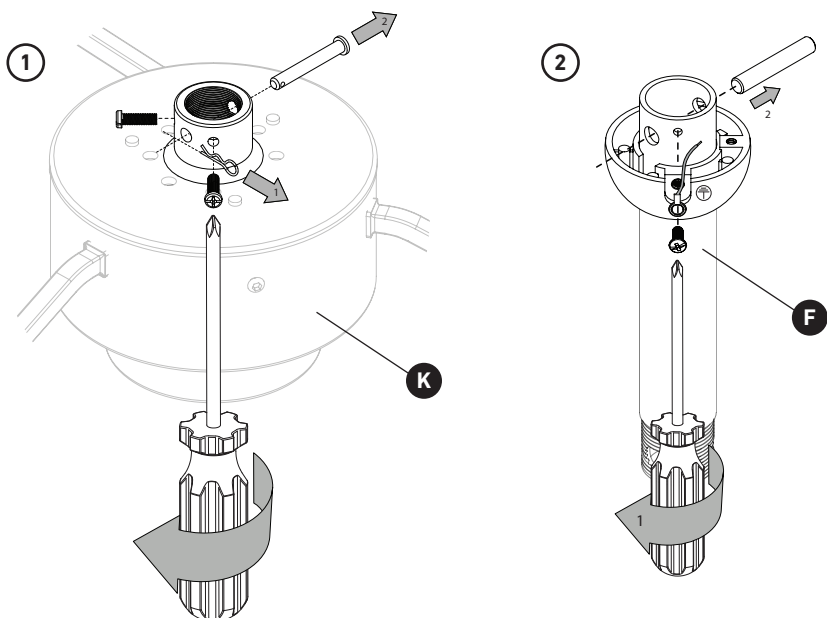

4 MAIN ROD INSTALLATION 主桿安裝

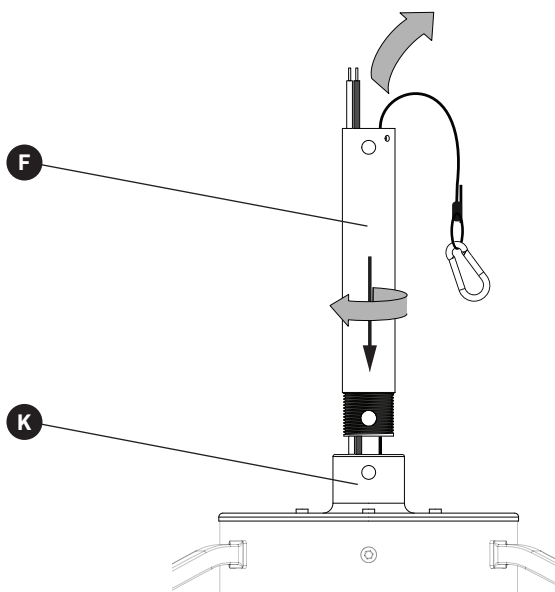

5 FIXTURE ASSEMBLY

燈具安裝

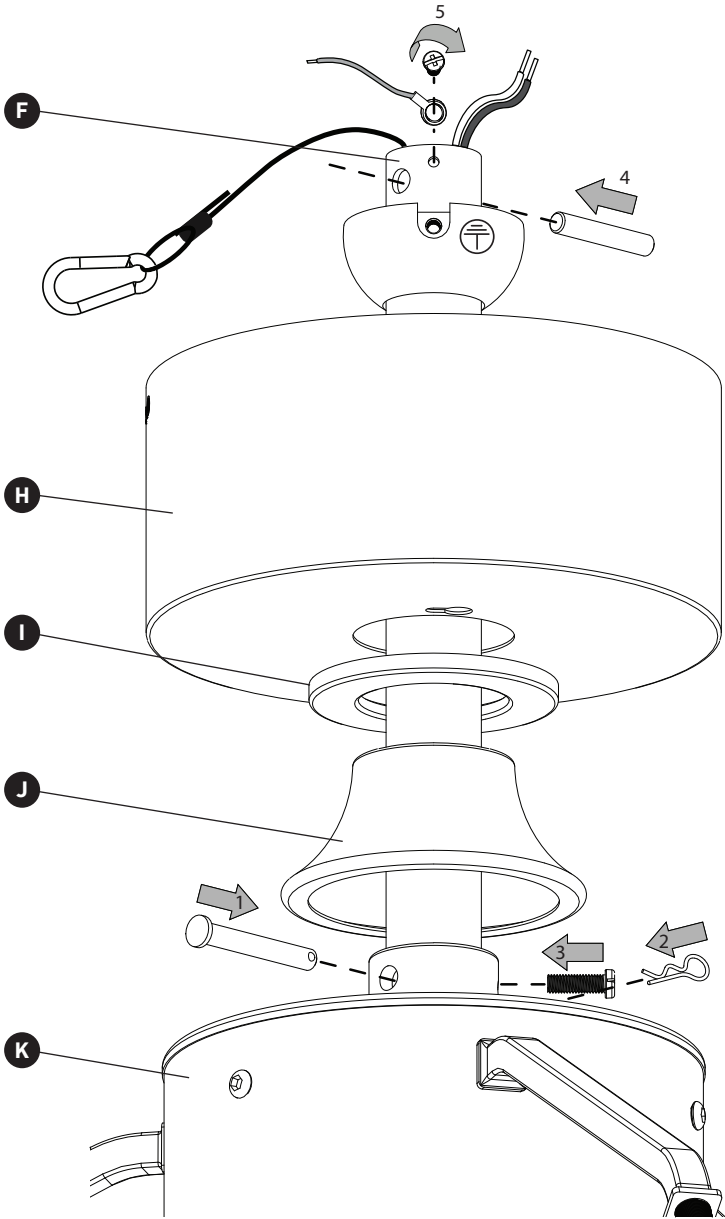

6 FIXTURE ASSEMBLY AND CONNECTION 燈具安裝於連接

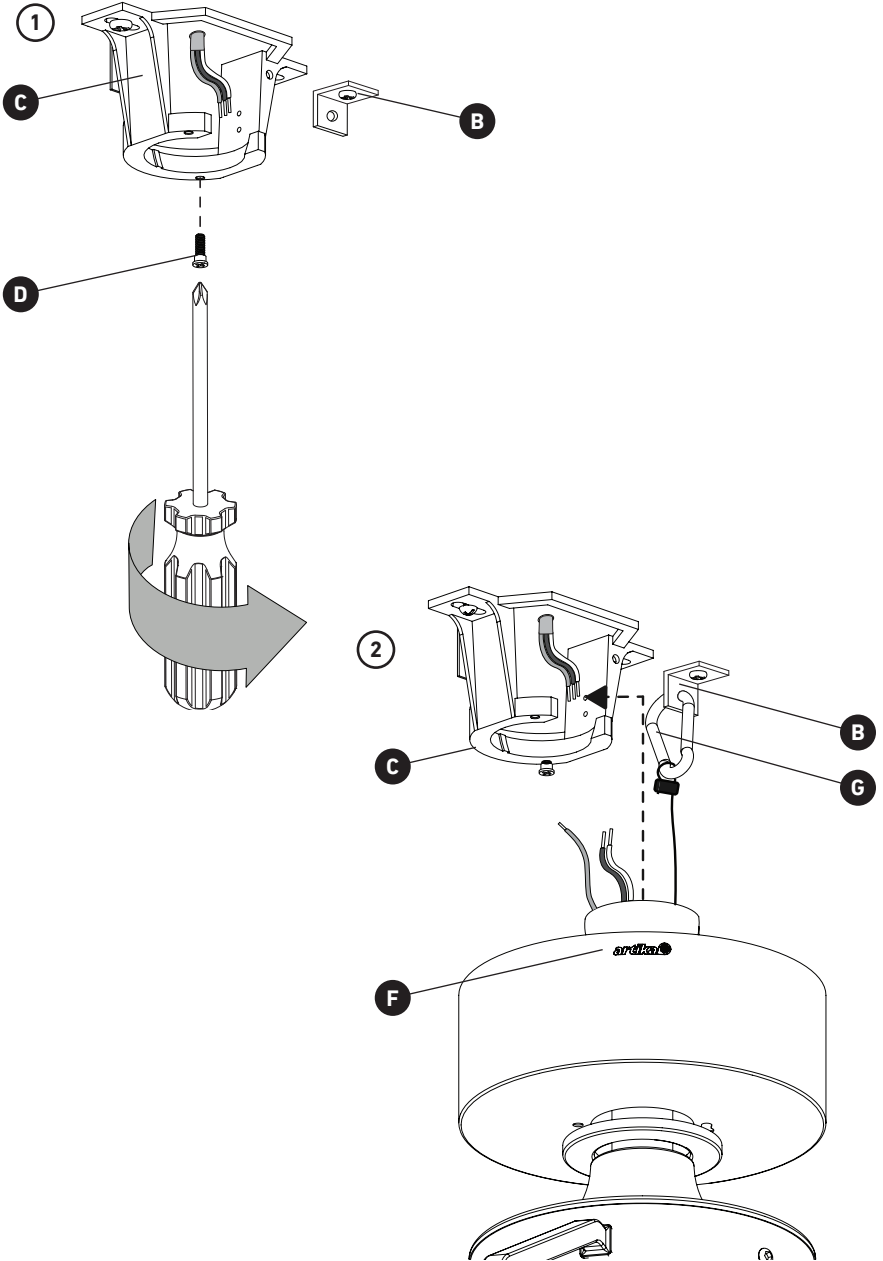

7 CONNECTION

連接

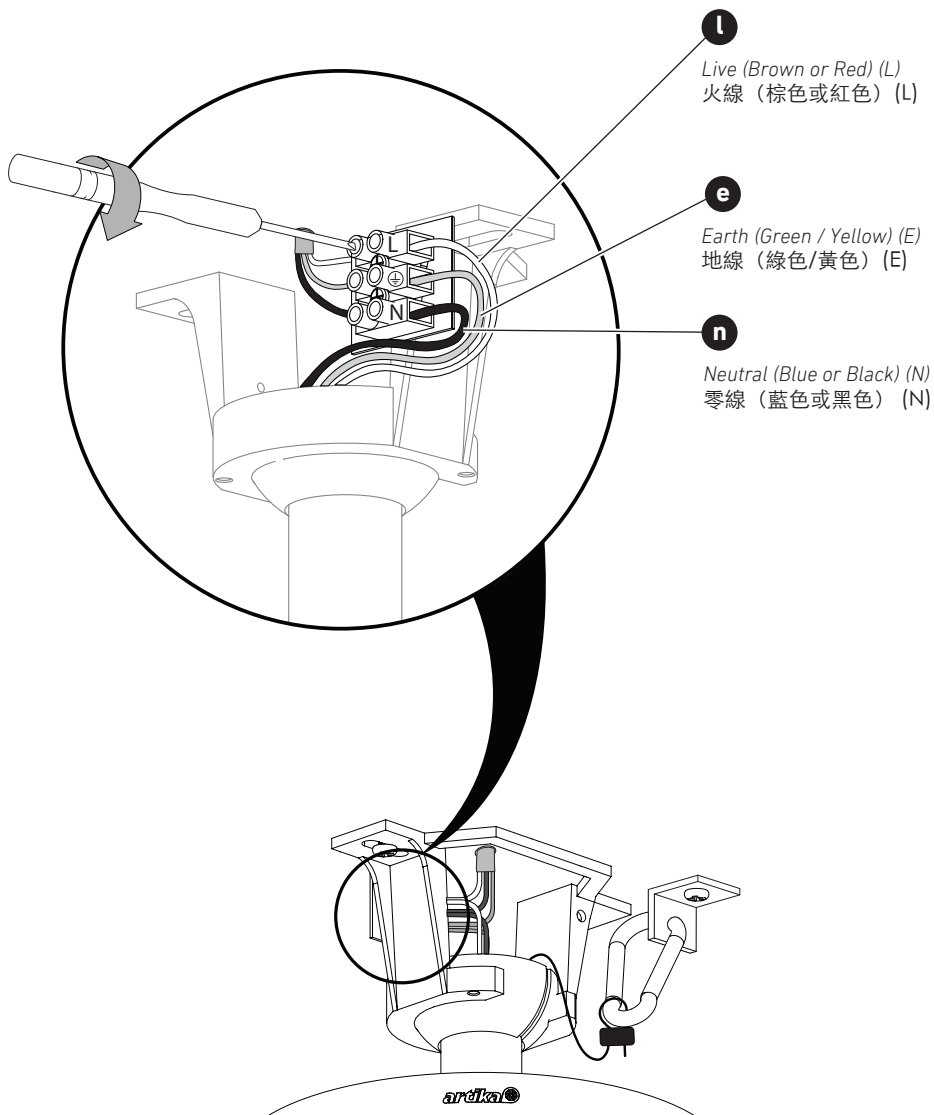

8

FINAL INSTALLATION 最終安裝

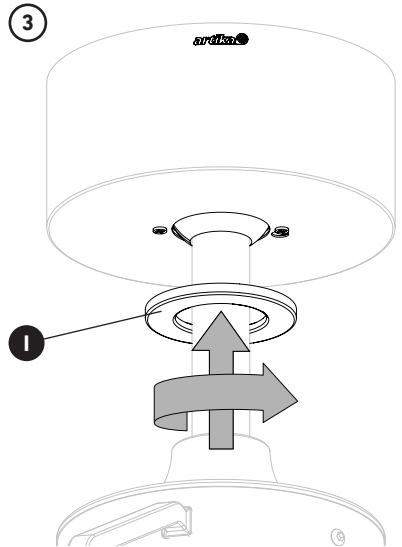
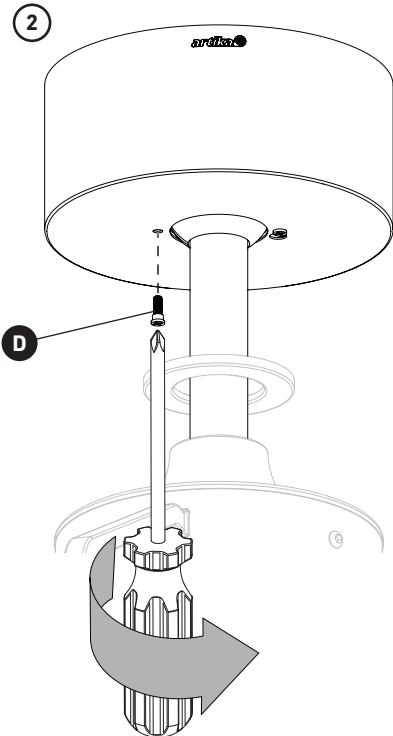
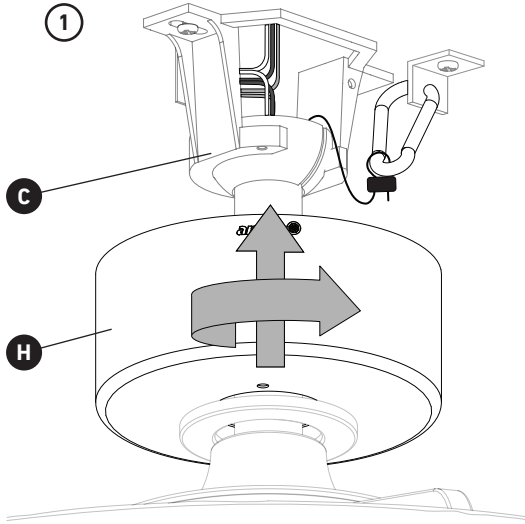

BATTERY INSTRUCTION

電池說明

Always purchase the correct size and grade of battery most suitable for the intended use.

Clean the battery contacts and also those of the device prior to battery installation.

Ensure the batteries are installed correctly with regard to polarity (+ and -).

Remove batteries from equipment that is not to be used for an extended period of time.

Remove used batteries promptly.

請務必購買最適合預期用途的正確尺寸和等級的電池。

安裝電池前，請清潔電池觸點和裝置的觸點。確保電池的極性（+和-）安裝正確。

將長時間不用的設備中的電池取出。

需立刻取出廢舊電池。。



BATTERY WARNING

電池注意事項



KEEP OUT OF REACH OF CHILDREN

Swallowing can lead to chemical burns, perforation of soft tissue, and death, severe burns can occur within 2 hours of ingestion. Seek medical attention immediately.

請勿讓兒童接觸。

吞嚥電池會導致化學灼傷、軟組織穿孔和死亡。吞食後2小時內可能發生嚴重灼傷。請立即就醫。

NOTE - READ AND SAVE THESE INSTRUCTIONS

注意 - 閱讀並妥善保存本說明

NOTE:

- To reduce the risk of electric shock, ensure electricity has been turned off at the circuit breaker or fuse box before beginning.
 - After making electrical connections, spliced conductors should be turned upward and pushed carefully up into the outlet box. The wires should be spread apart with the grounded conductor and the equipment-grounding conductor on one side of the outlet box and ungrounded conductor on the other side of the outlet box.
 - This product contains a lithium button/coin cell battery. If a new or used lithium button/coin cell battery is swallowed or enters the body, it can cause severe internal burns and can lead to death in as little as 2 hours. Always completely secure the battery compartment. If the battery compartment does not close securely, stop using the product, remove the batteries, and keep it away from children. If you think batteries might have been swallowed or placed inside any part of the body, seek immediate medical attention.
 - The cells shall be disposed of properly, including keeping them away from children;
- and
- Even used cells may cause injury.

注意：

- 為降低點擊危險，請確保在開始使用前已關閉斷路器或保險絲盒中的電源。
 - 完成電氣連接後，應將接合的導線向上轉，小心地向上推入插座盒中。電線應分開，將接地導線和設備接地導線置於插座盒的一側，非接地導線置於插座盒的另一側。
 - 本產品包含一顆鋰鈕扣/幣型電池。如果新舊鋰鈕扣/幣型電池被誤吞或進入人體，可能會造成嚴重內部灼傷，且可能會在短短2小時內致人死亡。請務必完全固定電池盒。如果電池盒未關緊，請停止使用本產品，拆除電池，請勿讓兒童接觸本產品。如果您認為電池可能經不慎誤吞或放入體內，請立即求醫。
 - 應妥善處置電池，包括遠離兒童；
- 和
- 即使是廢舊電池也可能造成傷害。



No obvious symptoms

Unfortunately, it is not obvious when a button or coin battery is stuck in a child's esophagus (food pipe).

There are no specific symptoms associated with this. The child might:

- cough, gag or drool a lot;
- appear to have a stomach upset or a virus;
- be sick;
- point to their throat or stomach;
- have a pain in their abdomen, chest or throat;
- be tired or lethargic;
- be quieter or more clingy than usual or otherwise "not themselves";
- lose their appetite or have a reduced appetite; • and not want to eat solid food / be unable to eat solid food.

These sorts of symptoms vary or fluctuate, with the pain increasing and then subsiding.

A specific symptom to button and coin battery ingestion is vomiting fresh (bright red) blood. If the child does this seek immediate medical help.

The lack of clear symptoms is why it is important to be vigilant with "flat" or spare button or coin batteries in the home and the products that use batteries in the home and the products that contain them.

無明顯症狀

不幸的是，鈕扣或幣型電池卡在兒童食道（食管）中並不明顯。沒有相關的具體症狀。兒童可能：

- 經常咳嗽、作嘔或流口水；
- 出現胃部不適或病毒感染症狀；
- 惡心想吐；
- 指向他們的喉嚨或胃部；
- 腹部、胸部或喉嚨疼痛；
- 疲倦或嗜睡；
- 比平時更安靜或更黏人，或在其他方面「變得不像他們自己」；
- 食欲不振或食量減少；
- 以及不想吃固體食物/不能吃固體食物。這些症狀可能會變化或波動，伴有疼痛加劇後減輕。

吞嚥鈕扣或幣型電池的具體症狀是吐鮮血（鮮紅色）。

如果兒童有該症狀，請立即就醫。由於缺乏明確症狀，因此必須對家中的「無電」或備用鈕扣或幣型電池，以及家中使用電池的產品和含有電池的產品保持警覺。

REMOTE CONTROL 遙控器

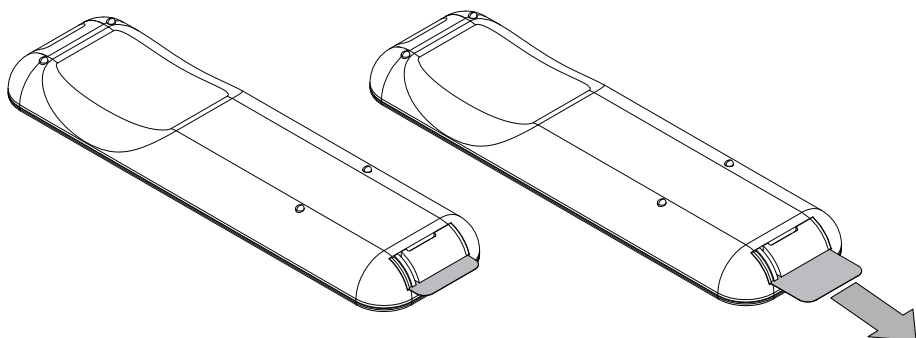

NOTE - READ AND SAVE THESE INSTRUCTIONS

注意：閱讀並妥善保存本說明

NOTE:

- This product contains a lithium button/coin cell battery. If a new or used lithium button/coin cell battery is swallowed or enters the body, it can cause severe internal burns and can lead to death in as little as 2 hours. Always completely secure the battery compartment. If the battery compartment does not close securely, stop using the product, remove the battery, and keep it away from children. If you think batteries might have been swallowed or placed inside any part of the body, seek immediate medical attention.
- All batteries must be properly disposed of and kept out of reach of children.
- Even used batteries may cause injury.

注意：

- 本產品包含一顆鋰鈕扣/幣型電池。如果新舊鋰鈕扣/幣型電池被誤吞或進入人體，可能會造成嚴重內部灼傷，且可能會在短短2小時內致人死亡。請務必完全固定電池盒。如果電池盒未關緊，請停止使用本產品，拆除電池，請勿讓兒童接觸本產品。如果您認為電池可能經不慎誤吞或放入體內，請立即就醫。
- 應妥善處置所有電池，並使其遠離兒童。
- 即使是廢舊電池也可能會造成傷害。

REPLACING THE REMOTE CONTROL BATTERIES

更換遙控器電池

Always purchase the correct size and grade of battery that is suitable for the intended use.

Replace all batteries within a set at the same time. Do not mix old and new batteries.

Do not mix alkaline, standard (carbon-zinc), or rechargeable (ni-cad, ni-mh, etc.) batteries.

Clean the battery contacts and the contacts on the device.

Ensure the batteries are installed correctly with regard to polarity (+ and -).

Remove batteries from any equipment that will not be used for a long time.

Remove used batteries promptly.

Batteries must be installed, removed and replaced by an adult or under adult supervision.

Dispose of batteries in accordance with local regulations.

Do not attempt to burn batteries or place them near a heat source.

請務必購買適合預期用途的正確尺寸和等級的電池。

需一次更換整組電池。

新舊電池請勿混用。

請勿將鹼性電池、標準電池（碳鋅）或充電電池（鎳鎘、鎳氫等）混用。

清潔電池觸點和裝置上的觸點。

確保電池的極性（+和-）安裝正確。

將長時間不用的設備中的電池取出。

需立刻取出廢舊電池。

必須由成人或在成人監督下安裝、拆卸和更換電池。

根據當地法規處置電池。

請勿嘗試燒毀電池或將其置於熱源附近。

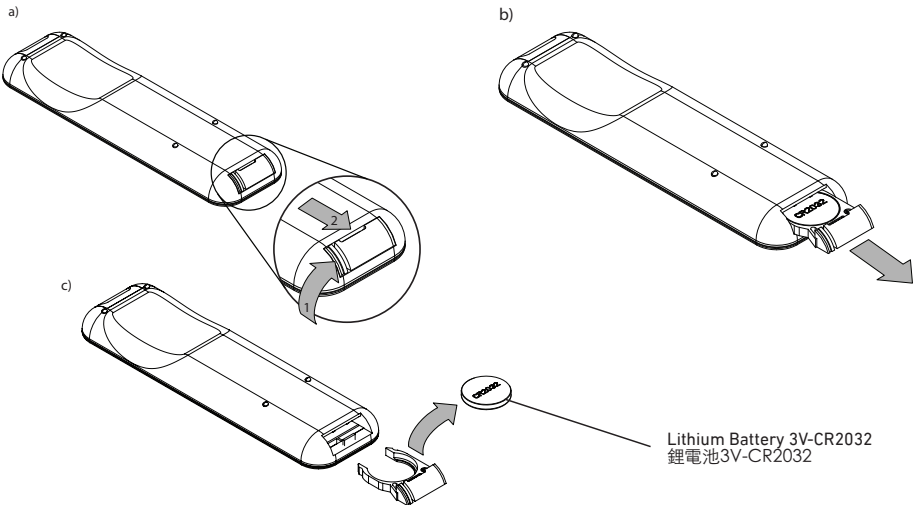

REMOTE CONTROL FUNCTIONS

遙控功能

REMOTE CONTROL PAIRING/UNPAIRING INSTRUCTIONS

1. Turn the fixture power off for at least 10 seconds.
2. Turn the fan on. Press the FAN ON/OFF button (no. 4) and the LIGHT ON/OFF button (no. 2) simultaneously within 10 seconds of turning on the fan. You will hear 1 "beep" sound when the pairing is complete, and 2 "beep" sounds when the unpairing is complete.
3. If pairing/unpairing is not successful, repeat the steps above.

Use one or two remotes to control one or two fans.

遙控器配對/解除配對說明

1. 關閉燈具電源至少10秒鐘。
2. 打開風扇。打開風扇後10秒內，同時按下「風扇打開/關閉」(FAN ON/OFF) 按鈕(編號4)和「燈打開/關閉」(LIGHT ON/OFF) 按鈕(編號2)。配對完成時，將會聽到1聲「嗶」聲，解除配對時則是2聲「嗶」聲。
3. 如果配對/解除配對不成功，請重複上述步驟。使用一個遙控器控制一台風扇或兩個遙控器分別控制兩台風扇。

設備名稱: LED吊扇, 型號 (型式): FAN-AUR-C10BL LED 吊扇						
單元 Unit	限用物質及其化學符號 Restricted substances and its chemical symbols					
	鉛 Lead (Pb)	汞 Mercury (Hg)	鎘 Cadmium (Cd)	六價鉻 Hexavalent chromium (Cr ⁺⁶)	多溴聯苯 Polybrominated biphenyls (PBB)	多溴二苯醚 Polybrominated diphenyl ethers (PBDE)
電源電路板	○	○	○	○	○	○
燈具外殼	○	○	○	○	○	○
LED鋁基板	○	○	○	○	○	○
電源塑料外殼	○	○	○	○	○	○
供電電源線	○	○	○	○	○	○
備考 1. “超出 0.1 wt %” 及 “超出 0.01 wt %” 係指限用物質之百分比含量超出百分比含量基準值。 Note 1: “Exceeding 0.1 wt %” and “exceeding 0.01 wt %” indicate that the percentage content of the restricted substance exceeds the reference percentage value of presence condition. 備考 2. “○” 係指該項限用物質之百分比含量未超出百分比含量基準值。 Note 2: “○” indicates that the percentage content of the restricted substance does not exceed the percentage of reference value of presence. 備考 3. “-” 係指該項限用物質為排除項目。 Note 3: The “-” indicates that the restricted substance corresponds to the exemption.						

REMOTE CONTROL FUNCTIONS

遙控功能

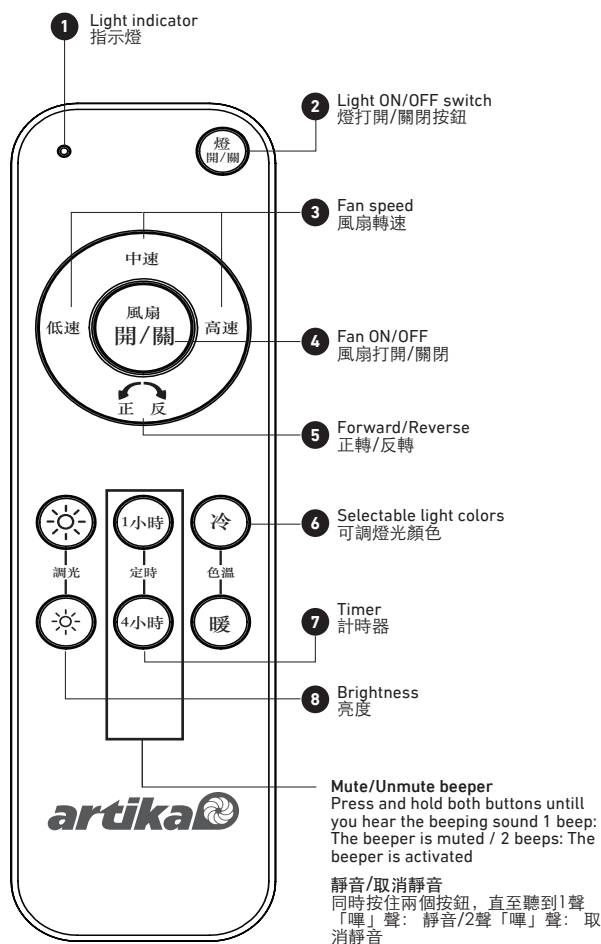

BATTERY WARNING 電池注意事項

(a) KEEP OUT OF REACH OF CHILDREN

(b) If the battery compartment (if applicable) does not close securely, stop using the product and keep it away from children.

(c) If you think batteries might have been swallowed or placed inside any part of the body, seek immediate medical attention.

(a) 請勿讓兒童接觸

(b) 如果電池盒（如適用）未能牢固關閉，請停止使用產品並將其遠離兒童

(c) 如果您懷疑電池可能被誤吞或放入身體任何部位，請立即就醫

NOTE - READ AND SAVE THESE INSTRUCTIONS

注意：閱讀並妥善保存本說明

NOTE:

- To reduce the risk of electric shock, ensure electricity has been turned off at the circuit breaker or fuse box before beginning.
 - After making electrical connections, spliced conductors should be turned upward and pushed carefully up into the outlet box. The wires should be spread apart with the grounded conductor and the equipment-grounding conductor on one side of the outlet box and ungrounded conductor on the other side of the outlet box.
 - Check that the outlet box is securely installed in place such that it is able to support at least the fan weight (total weight of fan approximately 5 Kg).
 - This product contains a lithium button/coin cell battery. If a new or used lithium button/coin cell battery is swallowed or enters the body, it can cause severe internal burns and can lead to death in as little as 2 hours. Always completely secure the battery compartment. If the battery compartment does not close securely, stop using the product, remove the batteries, and keep it away from children. If you think batteries might have been swallowed or placed inside any part of the body, seek immediate medical attention.
 - The cells shall be disposed of properly, including keeping them away from children;
- and
- Even used cells may cause injury.

注意：

- 為降低點擊危險，請確保在開始使用前已關閉斷路器或保險絲盒中的電源。
 - 完成電氣連接後，應將接合的導線向上轉，小心地向上推入插座盒中。電線應分開，將接地導線和設備接地導線置於插座盒的一側，非接地導線置於插座盒的另一側。
 - 檢查插座盒是否牢固安裝到位，使其至少能支撐風扇重量（風扇總重量約5公斤）。
 - 本產品包含一顆鋰鈕扣/幣型電池。如果新舊鋰鈕扣/幣型電池被誤吞或進入人體，可能會造成嚴重內部灼傷，且可能會在短短2小時內致人死亡。請務必完全固定電池盒。如果電池盒未關緊，請停止使用本產品，拆除電池，請勿讓兒童接觸本產品。如果您認為電池可能經不慎誤吞或放入體內，請立即求醫。
 - 應妥善處置電池，包括遠離兒童；
- 和
- 即使是廢舊電池也可能造成傷害。

NCC 警語：

Without permission granted by the ncc, any company, enterprise, or user is not allowed to change frequency, enhance transmitting power or alter original characteristic as well as performance to a approved low power radio-frequency devices. the low power radio-frequency devices shall not influence aircraft security and interfere legal communications; if found, the user shall cease operating immediately until no interference is achieved. the said legal communications means radio communications is operated in compliance with the telecommunications management act. the low power radio-frequency devices must accept any interference from legal communications or ism radio wave radiated devices.

- 取得審驗證明之低功率射頻器材，非經核准，公司、商號或使用者均不得擅自變更頻率、加大功率或變更原設計之特性及功能。

- 低功率射頻器材之使用不得影響飛航安全及干擾合法通信；經發現有干擾現象時，應立即停用，並改善至無干擾時方得繼續使用。

- 前述合法通信，指依電信管理法規定作業之無線電通信。低功率射頻器材須忍受合法通信之干擾，科學及醫療用電波輻射性電機設備之干擾。

Artika for Living Inc.
800, Boulevard Hymus
Saint-Laurent (Québec) H4S 0B5
Canada

support@artika.com
www.artika.com/care

