

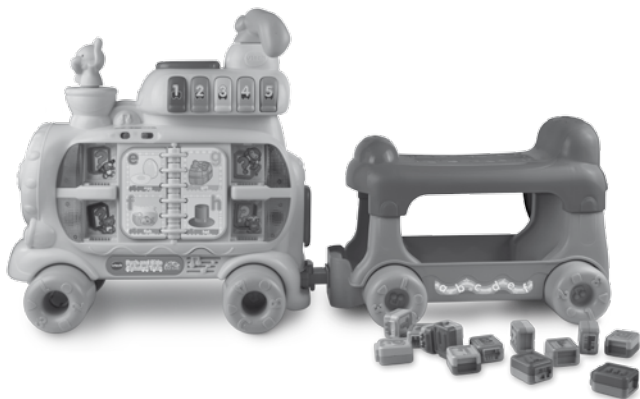

User's Manual

Push and Ride Alphabet Train



© 2012 VTech
Printed in China
91-002305-024[®]

VTech understands that a child's needs and abilities change as they grow and with that in mind we develop our toys to teach and entertain at just the right level...

Pre-School

Interactive toys to develop their imagination and encourage language development

vtech Baby

Toys that will stimulate their interest in different textures, sounds and colours

I am...

...responding to colours, sounds and textures

...understanding cause and effect

...learning to touch, reach, grasp, sit-up, crawl and toddle

Birth-36 months



I want...

...to get ready for school by starting to learn the alphabet and counting

...my learning to be as fun, easy and exciting as can be

...to show my creativity with drawing and music so my whole brain develops

3-6 years



Electronic Learning Computers

Cool, aspirational and inspiring computers for curriculum related learning

I need...

...challenging activities that can keep pace with my growing mind

...intelligent technology that adapts to my level of learning

...National Curriculum based content to support what I'm learning at school

4-10 years



To learn more about this and other VTech® products, visit www.vtechuk.com

INTRODUCTION

Thank you for purchasing the **VTech® Push and Ride Alphabet Train** learning toy!

The **VTech® Push and Ride Alphabet Train** will take your child on a journey through letters, numbers, music and more. Entertaining sound effects, dancing lights and fun melodies reward your child's curiosity.

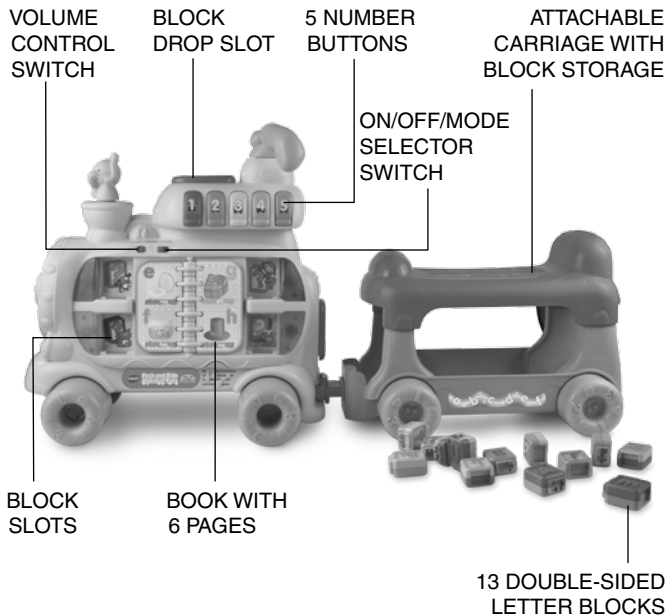

INCLUDED IN THIS PACKAGE

- One engine



- One engine handle



- Two back engine wheels

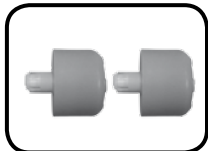

- One soft hinge and two screws

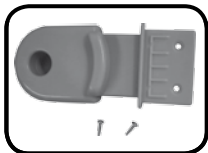

- One instruction manual

- One carriage

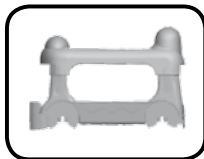

- Two front engine wheels

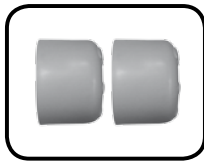

- Four carriage wheels with two axle trees, four blue covers and eight screws

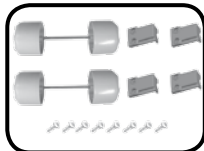

- 13 double-sided letter blocks



WARNING:

All packing materials, such as tape, plastic sheets, packaging locks and tags are not part of this toy, and should be discarded for your child's safety.

NOTE: Please keep user's manual as it contains important information.

GETTING STARTED

BATTERY INSTALLATION

1. Make sure the unit is turned **OFF**.
2. Locate the battery cover on the back of the unit. Use a coin or a screwdriver to loosen the screw.
3. Install 3 new 'AA' (AM-3/LR6) batteries following the diagram inside the battery box.
4. Replace the battery cover and tighten the screw to secure.

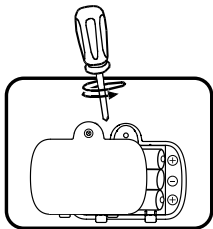

BATTERY NOTICE

- Use new alkaline batteries for maximum performance.
- Use only batteries of the same or equivalent type as recommended.
- Do not mix different types of batteries: alkaline, standard (carbon-zinc) or rechargeable (Ni-Cd, Ni-MH), or new and used batteries.
- Do not use damaged batteries.
- Insert batteries with the correct polarity.
- Do not short-circuit the battery terminals.
- Remove exhausted batteries from the toy.
- Remove batteries during long periods of non-use.
- Do not dispose of batteries in fire.
- Do not charge non-rechargeable batteries.
- Remove rechargeable batteries from the toy before charging (if removable).

- Rechargeable batteries are only to be charged under adult supervision.

Disposal of batteries and product



The crossed-out wheeled bin symbols on products and batteries, or on their respective packaging, indicates they must not be disposed of in domestic waste as they contain substances that can be damaging to the environment and human health.



The chemical symbols Hg, Cd or Pb, where marked, indicate that the battery contains more than the specified value of mercury (Hg), cadmium (Cd) or lead (Pb) set out in Battery Directive (2006/66/EC).

The solid bar indicates that the product was placed on the market after 13th August, 2005.



Help protect the environment by disposing of your product or batteries responsibly.

For more information, please visit:

www.recycle-more.co.uk

www.recyclenow.com

With the **VTech Push and Ride Alphabet Train**, safety comes first. To ensure your child's safety, adult assembly is required. Please ensure that all assembled parts are securely locked into position before use.

Assembly Instructions

1. Install the two green front wheels onto the front of the engine by placing them over the yellow front axles. Push the wheels onto the axles until you hear a click. Once you have installed the wheels, they cannot be removed.



2. Install the two green back engine wheels onto the back of the engine by inserting them into the yellow sockets at the back of the train. Push the wheels into the sockets until you hear a click. Once you have installed the wheels, they cannot be removed.

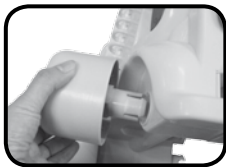

3. Install the four green carriage wheels with axle trees into the sides of the bottom of the carriage. Place the covers over the axles. Use a screwdriver to tighten the screws.

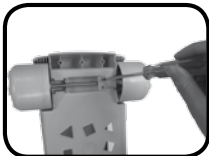
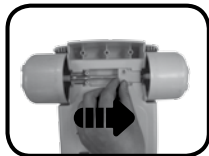
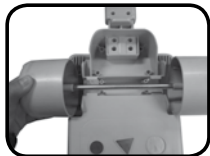

4. Position the handle so that the curved part of the handle faces the back of the engine. Insert the handle into the hole in the top of the engine until you hear a click. Once you have installed the handle, it cannot be removed.

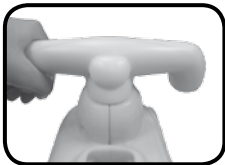

5. Position the soft, blue hinge so that its large hole is facing up and to the front. Insert the hinge into the hole at the front of the carriage, use a screwdriver to tighten the two screws on the bottom of the carriage.

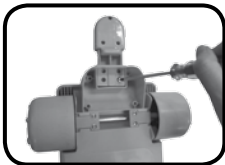

6. To attach the carriage to the engine, insert it into the slot at the back of engine. You will hear a click, which lets you know the carriage is attached correctly.

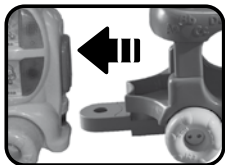

7. To detach the carriage from the engine, press and hold the blue button under the end of the engine, pull the carriage from the slot.

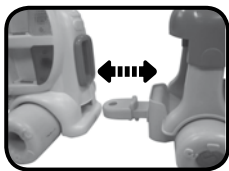
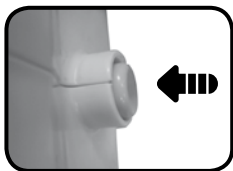

PRODUCT FEATURES

1. ON/OFF/MODE SELECTOR SWITCH

To turn the unit **ON**, slide the red **ON/OFF/MODE SELECTOR SWITCH** located at the top of the engine to the **Learning Mode** (📖) or **Discovery Mode** (🔍) position. To turn the unit **OFF**, slide the **ON/OFF/MODE SELECTOR SWITCH** to the **OFF (OFF)** position.

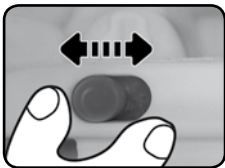

2. VOLUME CONTROL SWITCH

To adjust the volume, slide the **VOLUME CONTROL SWITCH** to the **LOW VOLUME** or the **HIGH VOLUME** position.

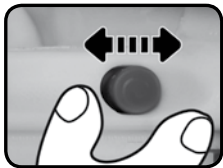

3. AUTOMATIC SHUT-OFF

To preserve battery life, the **VTech® Push and Ride Alphabet Train** will automatically power-down after approximately 78 seconds without input. The unit can be turned on again by pressing any button.

ACTIVITIES

1. Slide the red **on/off/mode selector switch** located at the top of the engine to the **Learning Mode** (📖) or **Discovery Mode** (🔍) position to turn the unit on. You will hear a train engine sound, entertaining phrases and music. The lights will flash with the sounds.

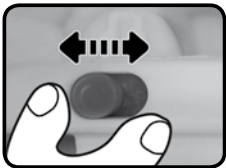

2. Press the **elephant button** to hear an elephant sound effect followed by fun phrases and sing-along songs. The lights will flash with the sounds.



3. Press the **number buttons** to learn about numbers in the **Learning Mode** and learn about colours in the **Discovery Mode**. The lights will flash with the sounds.



4. Turn the **book's pages** to learn about letters and objects and listen to fun stories in both modes. The lights will flash with the sounds.

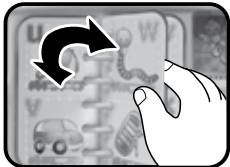

5. Place the **blocks** into the train's block slots to learn letters and objects in both modes. Upbeat melodies and fun sounds will accompany the play. The lights will flash with the sounds.



6. Drop the blocks into the drop block slot at the top of the train and they'll slide out the back into the attachable carriage storage area.



7. If there is no input to the unit after approximately 10 seconds, you will hear a fun sing-along song. After another 10 seconds if there is still no input, you will hear a question, which will encourage the child to find the correct block according to the book page. After another 10 seconds if there is still no input, you will hear the phrase "Bye-bye," then the unit will automatically power-down.

MELODY LIST

1. Baby Elephant Walk
2. I've Been Working on the Railroad
3. Pop! Goes the Weasel
4. Twinkle, Twinkle, Little Star
5. It's Raining, It's Pouring
6. This Old Man
7. Three Little Kittens
8. Humpty Dumpty
9. Hickory Dickory Dock
10. Mulberry Bush

SING-ALONG SONG LYRICS**SONG 1 (Tune of "London Bridge")**

Happily we chug along,
Learning letters, singing songs.
Happily we chug along,
On the train!

SONG 2 (Tune of "Alphabet Song")

A-B-C-D

E-F-G

H-I-J-K

L-M-N-O-P

Q-R-S

T-U-V

W-X

Y and Z.

Now I know my ABCs, come and ride the train with me!

CARE & MAINTENANCE

1. Keep the unit and book pages clean by wiping with a slightly damp cloth.
2. Keep the unit out of direct sunlight and away from any direct heat source.
3. Remove the batteries when the unit is not in use for an extended period of time.
4. Do not drop the unit on hard surfaces and do not expose the unit to moisture or water.

TROUBLESHOOTING

If for some reason the program/activity stops working or malfunctions, please follow these steps:

1. Please turn the unit **OFF**.
2. Interrupt the power supply by removing the batteries.
3. Let the unit stand for a few minutes, then replace the batteries.
4. Turn the unit **ON**. The unit should now be ready to play again.
5. If the product still does not work, replace with a new set of batteries.

If the problem persists, please call our Consumer Services Department at 01235 546810 (from UK), or +44 1235 546810 (outside UK), and a service representative will be happy to help you.

IMPORTANT NOTE:

Creating and developing **VTech®** Products is accompanied by a responsibility that we at **VTech®** take very seriously. We make every effort to ensure the accuracy of the information which forms the value of our products. However, errors sometimes can occur. It is important for you to know that we stand behind our products and encourage you to call our Consumer Services Department at 01235 546810 (from UK), or +44 1235 546810 (outside UK) with any problems and/or suggestions that you might have. A service representative will be happy to help you.

**CLASS 1
LED PRODUCT**

Warning. Not to be used by children over 36 months. Insufficient strength. 20kg max. Regularly check for signs of wear or tear on the snap in or locking devices. If damaged do not use until repaired or replaced. Only to be used under the direct supervision of a competent adult.



vtech®

PRODUCT WARRANTY



Thank you for choosing this quality product from VTech. We hope it will bring many hours of entertainment, imaginative play and learning.

1. The product detailed above is covered by a one year warranty from the date of purchase, against any defects in materials or workmanship.
2. The product may be returned to the place of purchase. Alternatively the product can be returned to VTech Electronics Europe plc (see address below), with proof of purchase, without proof of purchase no replacement will be provided.
3. VTech Electronics Europe plc will examine the product and if it is found to be defective due to faulty materials or workmanship, will replace the product at their discretion.
4. If the product covered by this warranty is damaged due to misuse, modification or unauthorised repair, or because of faulty batteries, battery discharge or incorrect electrical connections, then this warranty becomes void.
5. This warranty is personal to the original purchaser and is not transferable.
6. Breakages to the LCD screen are not covered by the warranty.
7. Returns to VTech Electronics Europe plc should include a cheque or postal order for £1.50 towards the cost of return postage and packaging.
8. Products returned to VTech Electronics Europe plc, should be addressed as follows and packed carefully to avoid damage in transit (Please do not include batteries or adaptor).
Please include details of the fault together with your name and address.

VTech Electronics Europe plc, c/o Tablogix Limited, 200 Milton Park, Abingdon, Oxon OX14 4TA

THIS WARRANTY IS OFFERED AS AN EXTRA BENEFIT AND DOES NOT AFFECT CONSUMERS' STATUTORY RIGHTS.

This warranty is valid for the UK and Eire only. For products purchased outside the UK and Eire, please contact your local distributor or place of purchase.

