

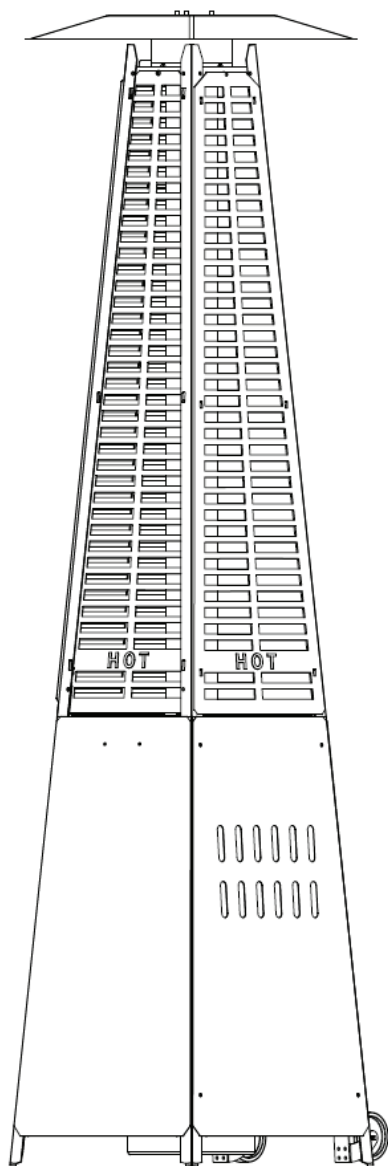

MODERN PYRAMID PATIO HEATER

ITM. / ART. 2127168

ASSEMBLY / CARE & USE INSTRUCTIONS IMPORTANT, RETAIN FOR FUTURE REFERENCE: READ CAREFULLY



DANGER

FOR YOUR SAFETY:

If you smell gas:

1. Shut off gas to the appliance.
2. Extinguish any open flame.
3. If odor continues, keep away from the appliance and immediately call your gas supplier or fire department.

DANGER

Failure to comply with the precautions and instructions provided with this heater can result in death, serious bodily injury and property loss or damage from hazards of fire, explosion, burn, asphyxiation, and/or carbon monoxide poisoning. Only persons who can understand and follow the instructions should use or service this heater.

WARNING

This product can expose you to chemicals including Carbon Monoxide, Lead, Chromium (hexavalent compounds), Di(2-ethylhexyl) phthalate (DEHP) and Diisononyl phthalate (DINP), which are known to the State of California to cause cancer and birth defects or other reproductive harm. For more information, go to www.P65Warnings.ca.gov.

WARNING

Do not store or use gasoline or other flammable vapors and liquids in the vicinity of this or any other appliance. An LP-cylinder not connected for use shall not be stored in the vicinity of this or any other appliance.

WARNING

Improper installation, adjustment, alteration, service or maintenance can cause property damage, injury or death. Read the installation, operation and maintenance instructions thoroughly before installing or servicing this equipment.

WARNING

THIS ITEM IS INTENDED FOR OUTDOOR USE ONLY.



ATTACH YOUR RECEIPT HERE

Keep a copy of your proof of purchase or order confirmation which will be needed if you need to contact us about warranty coverage.

Serial No. _____

Purchase Date _____



Questions, problems, missing parts?

Before returning to your retailer, our Florida-based customer service team is available. *English & Spanish speaking.*

Call Toll-Free **(866) 985-7877**

9 a.m. – 9 p.m., EST

Email **cservice@welltraveled.net**

Live Chat **www.balkenehome.com** 9 a.m. – 9 p.m., EST, Mon – Fri

07262021



English

Page 3

中文

第24頁



TABLE OF CONTENTS

Before You Begin	Page 3
Safety Information	Page 4
Package Contents	Page 5
Hardware Contents	Page 5
Assembly	Page 6-16
Operating Instructions	Page 17-20
Care and Maintenance	Page 21
Troubleshooting	Page 22
Warranty Information	Page 23



BEFORE YOU BEGIN

Please read and understand this entire manual before attempting to assemble, operate or install this appliance. If you have any questions regarding the product, please email us at cservice@welltraveled.net.
English & Spanish speaking.

This manual contains important information about the assembly, operation and maintenance of this patio heater. General safety information is presented in the first few pages and is also located throughout this manual. Keep this manual for future reference and to educate new users of this appliance. This manual should be read in conjunction with the labeling on the appliance. Safety precautions are essential when any mechanical or propane fueled equipment is involved. These precautions are necessary when using, storing, and servicing. Using this appliance with the respect and caution demanded will reduce the possibilities of personal injury or property damage. The symbols shown on the following page are used extensively throughout this manual. Always heed these precautions, as they are essential when using any mechanical or propane fueled equipment.

DANGER

EXPLOSION—FIRE HAZARD

- Keep solid combustibles, such as building materials, paper, or cardboard a safe distance away from the heater as recommended by the instructions.
- Provide adequate clearances around air openings into the combustion chamber.
- Never use the heater in spaces which do or may contain volatile or airborne combustibles, or products such as gasoline, solvents, paint thinner, dust particles, or unknown chemicals.
- During operation, this appliance can be a source of ignition. Keep heater area clear and free from combustible materials, gasoline, paint thinner, cleaning solvents and other flammable vapors and liquids. Do not use heater in areas with high dust content. Minimum heater clearances from combustible materials: 3 feet/36 inches from top and 2 feet/24 inches from sides.
- Never store propane near high heat, open flames, pilot lights, direct sunlight, other ignition sources, or where temperatures exceed 120° F (49° C).
- Propane vapors are heavier than air and can accumulate in low places. If you smell gas, leave the area immediately.
- Never install or remove a propane cylinder while the heater is lighted, near flame, pilot lights, or other ignition sources or while heater is hot to the touch.
- This heater is red hot during use and can ignite flammables too close to the burner. keep flammables at least 3.3 feet/40 inches/1 meter) from top and sides. keep gasoline and other flammable liquids and vapors well away from heater.
- Store the propane cylinder outdoors in a well-ventilated space out of the reach of children. Never store the propane cylinder in an enclosed area (house, garage, etc.). If heater is to be stored indoors, disconnect the propane cylinder for outdoor storage.

WARNING: FOR OUTDOOR USE ONLY



CARBON MONOXIDE HAZARD

This appliance can produce carbon monoxide which has no odor. Using it in an enclosed space can kill you. Never use this appliance in an enclosed space such as a camper, tent or home.

DANGER

CARBON MONOXIDE HAZARD

- This heater is a combustion appliance. All combustion appliances produce carbon monoxide (CO) during the combustion process. This product is designed to produce extremely minute, non-hazardous amounts of CO if used and maintained in accordance with all warnings and instructions. Do not block the air flow into or out of the heater.
- Carbon Monoxide (CO) poisoning produces flu-like symptoms, water eyes, headaches, dizziness, fatigue, and possibly death. You can't see and you can't smell it. It is an invisible killer. If these symptoms are present during operation of this product, get fresh air immediately!
- For outdoor use only.
- Never use inside house or other unventilated or enclosed areas.
- This heater consumes air (oxygen). Do not use in unventilated or enclosed areas to avoid endangering your life.

WARNING

WARNING indicates an imminently hazardous situation which, if not avoided, will result in death or serious injury.

WARNING

BURN HAZARD

- Never leave heater unattended when hot or in use.
- Keep out of reach of children.

WARNING

Certain materials or items, when stored under the heater, will be subject to radiant heat and could be seriously damaged.

CAUTION

CAUTION indicates an imminently hazardous situation which, if not avoided, may result in minor or moderate personal injury, or property damage.

CAUTION

SERVICE SAFETY

- Keep all connections and fittings clean. Make sure propane cylinder valve outlet is clean.
- During set up, check all connections and fittings for leaks using soapy water, never use a flame to check for leaks.
- Use as a heating appliance only. Never alter in any way to use with any device.

WARNING

- This product is fueled by propane gas. Propane gas is invisible, odorless, and flammable. An odorant is normally added to help detect leaks and can be described as having a "rotten egg" smell. The odorant can fade over time so leaking gas is not always detectable by smell alone.
- Propane gas is heavier than air and leaking propane will sink to the lowest level possible. It can ignite by ignition sources including matches, lighters, sparks or open flames of any kind many feet away from the original leak. Use only propane gas set up for vapor withdrawal.
- Store and use propane gas in compliance with local ordinances and codes or with ANSI/NFPA 58. Always turn off propane when not in use.
- Alert children and adults to the hazards of high surface temperatures. Stay away from these surfaces to avoid burning skin or igniting clothing.
- Carefully supervise young children when in the vicinity of the heater.
- Do not hang clothing or any other flammable materials from the heater, or place near the heater.
- Replace any guard or protective device removed for servicing the appliance prior to placing back in service.
- Installation and repair should be done by a qualified service person. The heater should be inspected before each use, and annually by a qualified service person. More frequent cleaning may be required as necessary. It is imperative that the control compartment, burners, and circulating air passageway of the appliance be kept clean.

PACKAGE CONTENTS

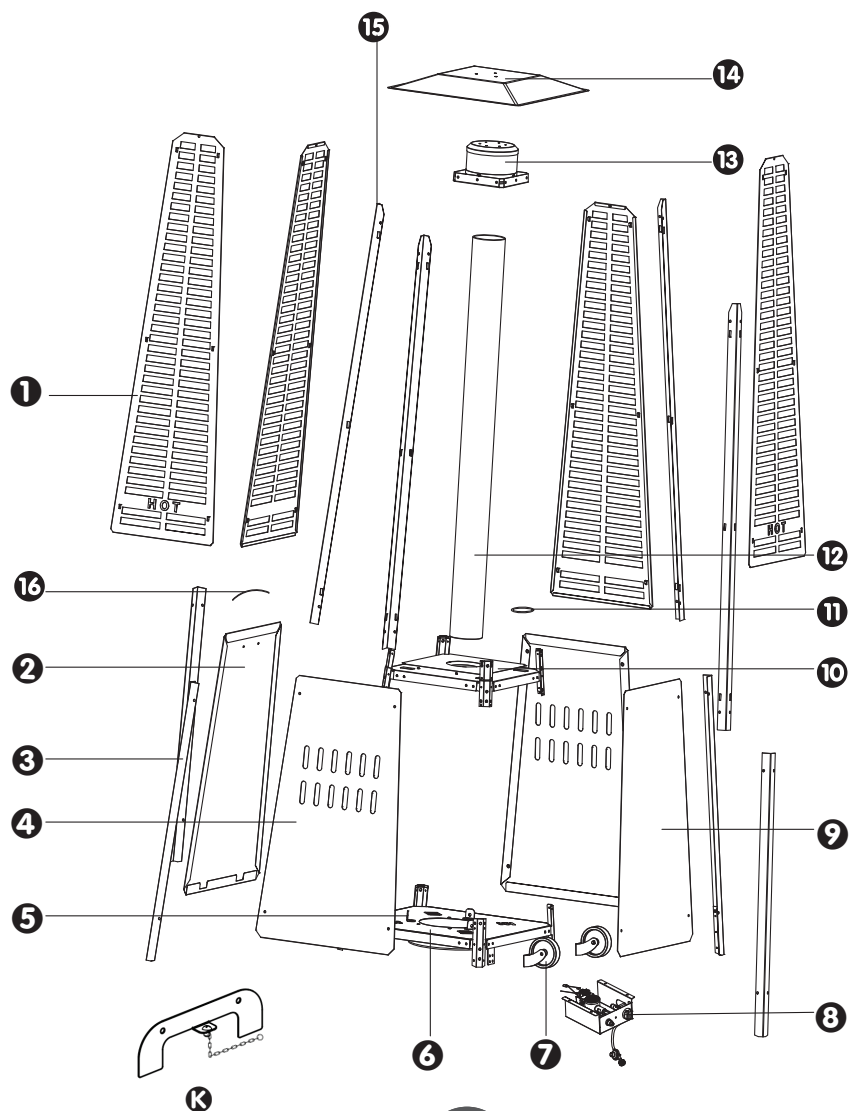

PART	DESCRIPTION	QTY
1	Guard Screen	4
2	Door Panel	1
3	Lower Support	4
4	Side Panel	2
5	Gas Cylinder Bracket	3
6	Base Plate	1
7	Wheel	2
8	Control Box	1
9	Back Panel	1
10	Middle Plate	1
11	Silicone Ring	1
12	Flame Tube	1
13	Emitter	1
14	Reflector	1
15	Upper Support	4
16	Handle	1
K	Handle Bracket (<i>pre-installed</i>)	1

Requires one AA battery (not included).
Install behind Igniter Button.



HARDWARE CONTENTS

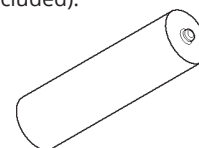

A
x2



B
x3

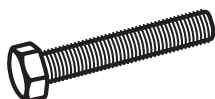

C
x3



D
x2

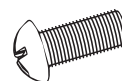

E
x64



F
x3



G
x3

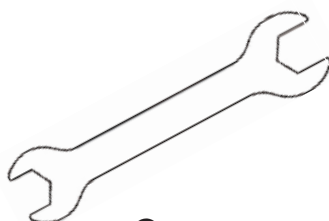

H
x2



I
x1



J
x6



PREPARATION

Before beginning assembly of this appliance, make sure all parts are present. Compare all parts with package contents list and hardware contents as listed on page 5 of this manual. If any part is missing or damaged, do not attempt to assemble this product. Contact customer service for replacement parts.

ESTIMATED ASSEMBLY TIME: 90 minutes

Tools Required for Assembly (NOT included): Adjustable Crescent Wrench, Leak Test Solution, AA Battery

Note: This heater has an Electronic Ignition and will require installation of 1 – AA battery. The battery should be installed by unscrewing the IGNITER BUTTON – battery not included.

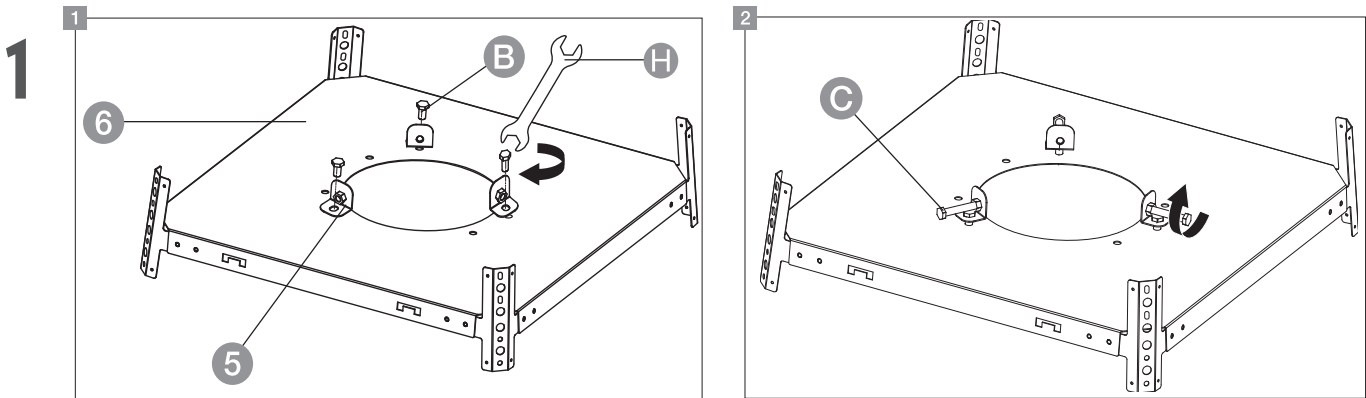

Hardware used: Short Bolt B x3, Long Bolt C x3

1 Attach the gas cylinder brackets **5** to the base plate **6**: Align the gas cylinder brackets with the eyelets in the base plate surrounding the large center hole. Fasten the gas cylinder brackets to the base plate using 3 short bolts **B**. Rotate the vertical portion of the brackets toward the middle of the base plate. Tighten the short bolts using a wrench **H**.

2 Insert 3 long bolts **C** into the nuts welded onto the gas cylinder brackets eyelets. Do not tighten the long bolts completely (this will be done in step 13 when securing the gas cylinder).

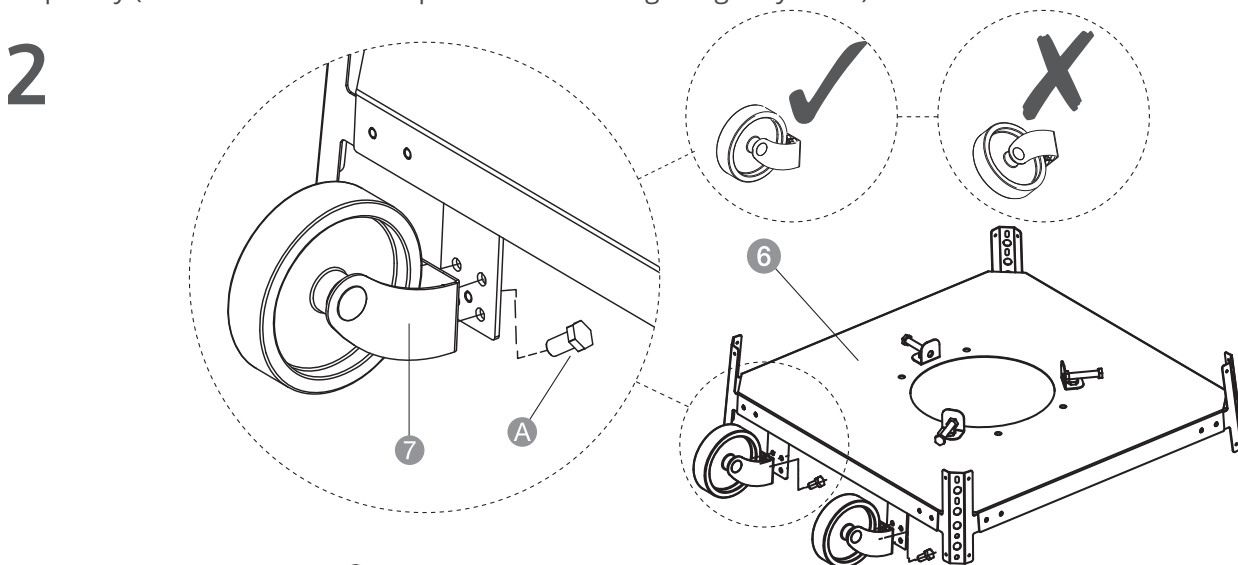

Hardware used: Bolt A x2

Attach 2 wheels **7** to the base plate **6** with 2 bolts **A**. Pay attention to the direction of the wheels when attaching. Make sure the wheel brackets point towards the upper side of the base plate (the side where the gas cylinder brackets are attached). For easier installation, turn the base plate over before attaching the wheels.

3

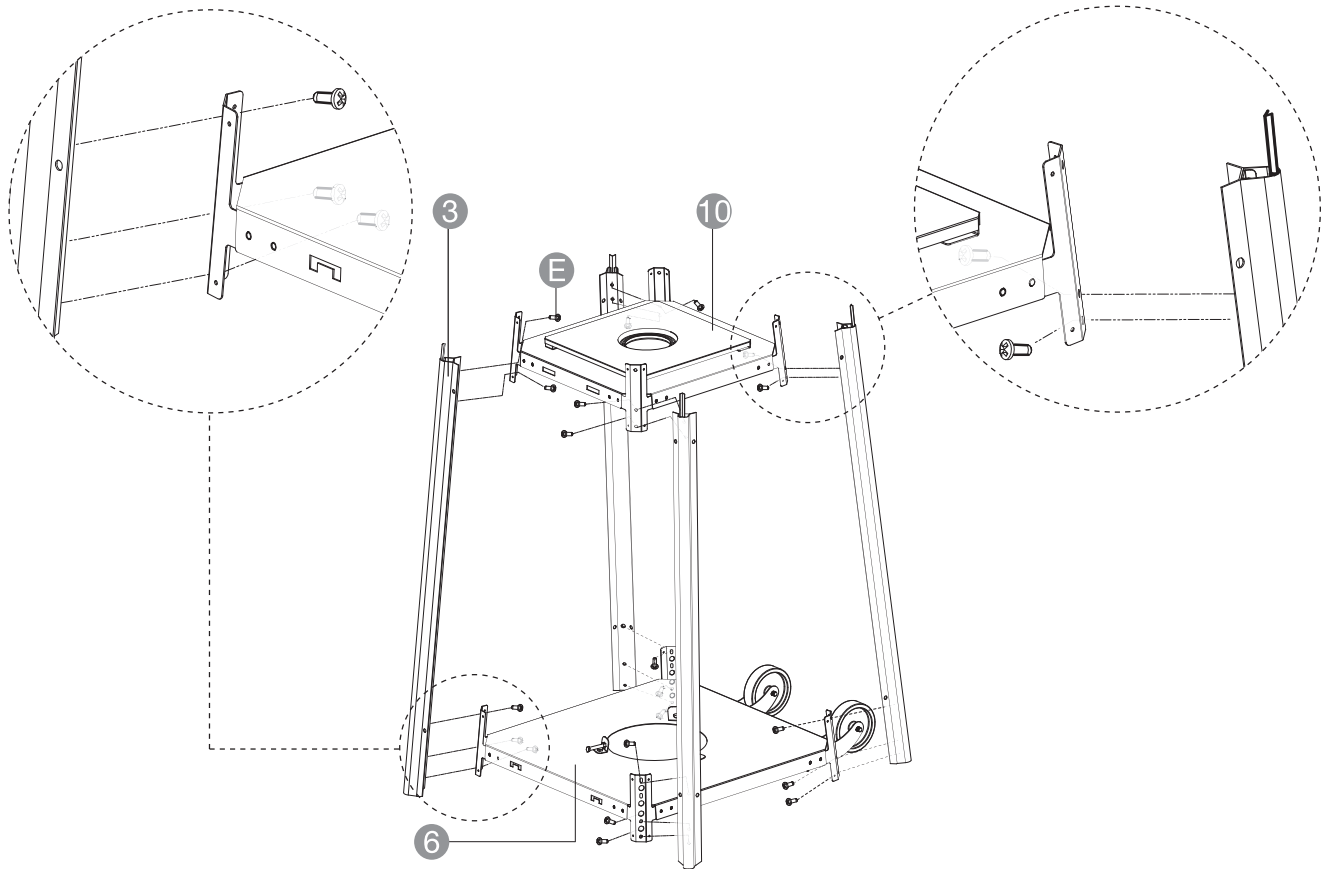

Hardware used: Screw **E** x20

Assemble the lower frame. Align the eyelets at the bottom of lower supports **3** with the small eyelets on the corners of the base plate **6**. Fasten the lower supports to the base plate using 12 screws **E**. Attach the middle plate **10** at the top of the lower supports using 8 screws **E**.

The arrow sticker on the middle plate must point in the same direction as the corresponding sticker on the base plate.

4

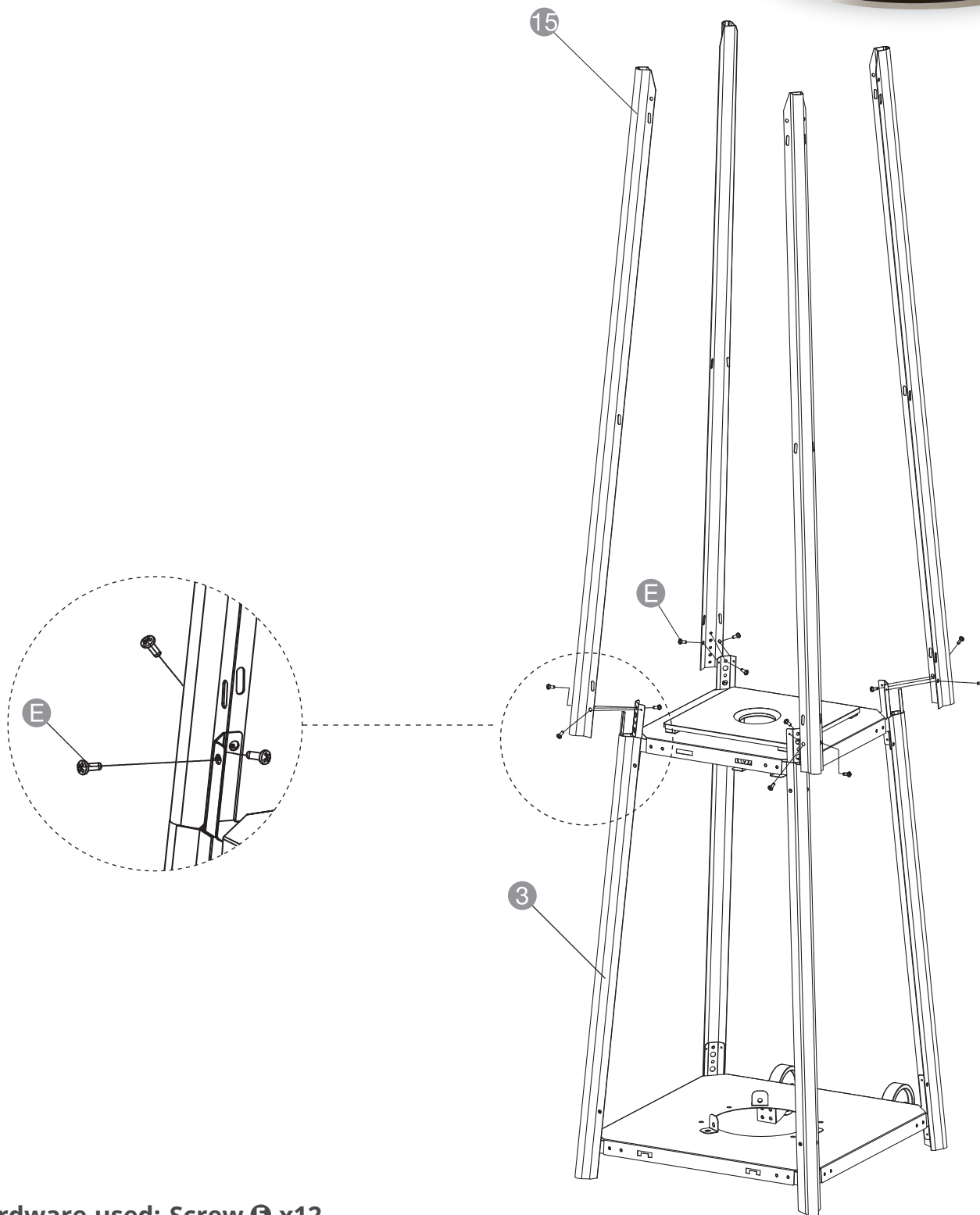
**Hardware used: Screw E x12**

- 1 Slide the 4 upper supports 15 onto the lower supports 3.
- 2 Slide the corresponding opening of the upper supports onto the v-shaped rail of the lower supports.
- 3 The upper and lower support brackets need to fit flush. Secure the connections using 12 screws E.

5

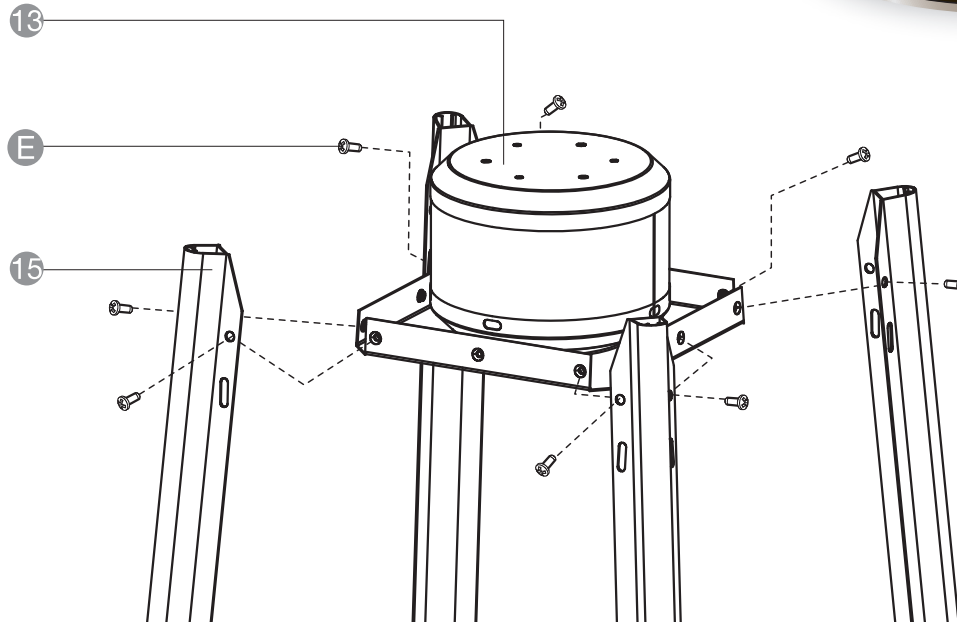

Hardware used: Screw E x8

Attach the emitter 13 to the upper supports 15 using 8 screws E.

▲ NOTICE: Assembly step 5 may require a ladder. Follow safety precautions when working on a ladder.

6

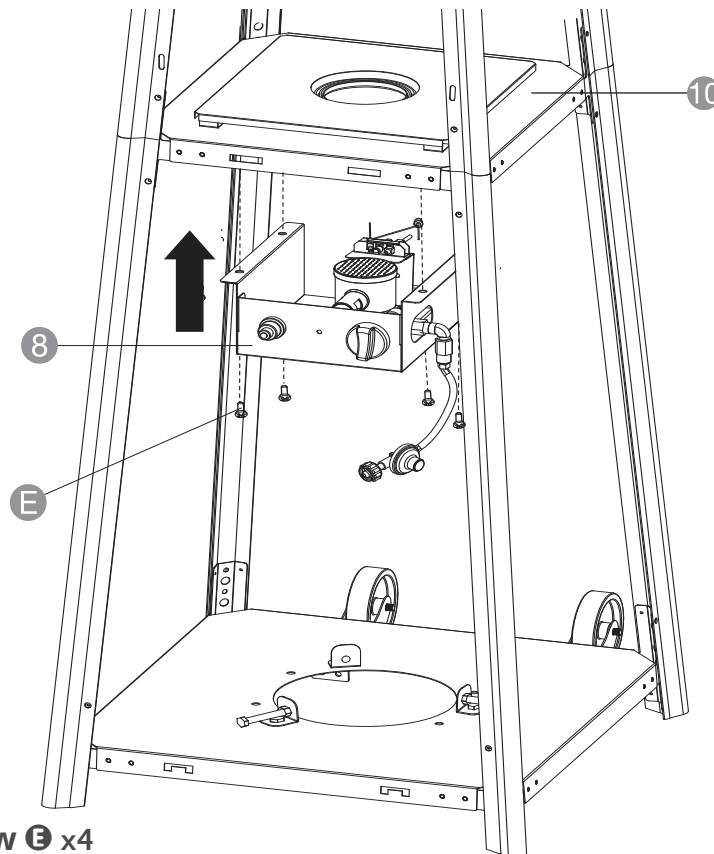

Hardware used: Screw E x4

Attach the control box 8 to the bottom of the middle plate 10 using 4 screws E.

▲ NOTICE: From step 6 on, you may continue the assembly without battery, or insert 1 AA battery (not included) into the control box at any time (see section "Operation-Inserting Battery").

7

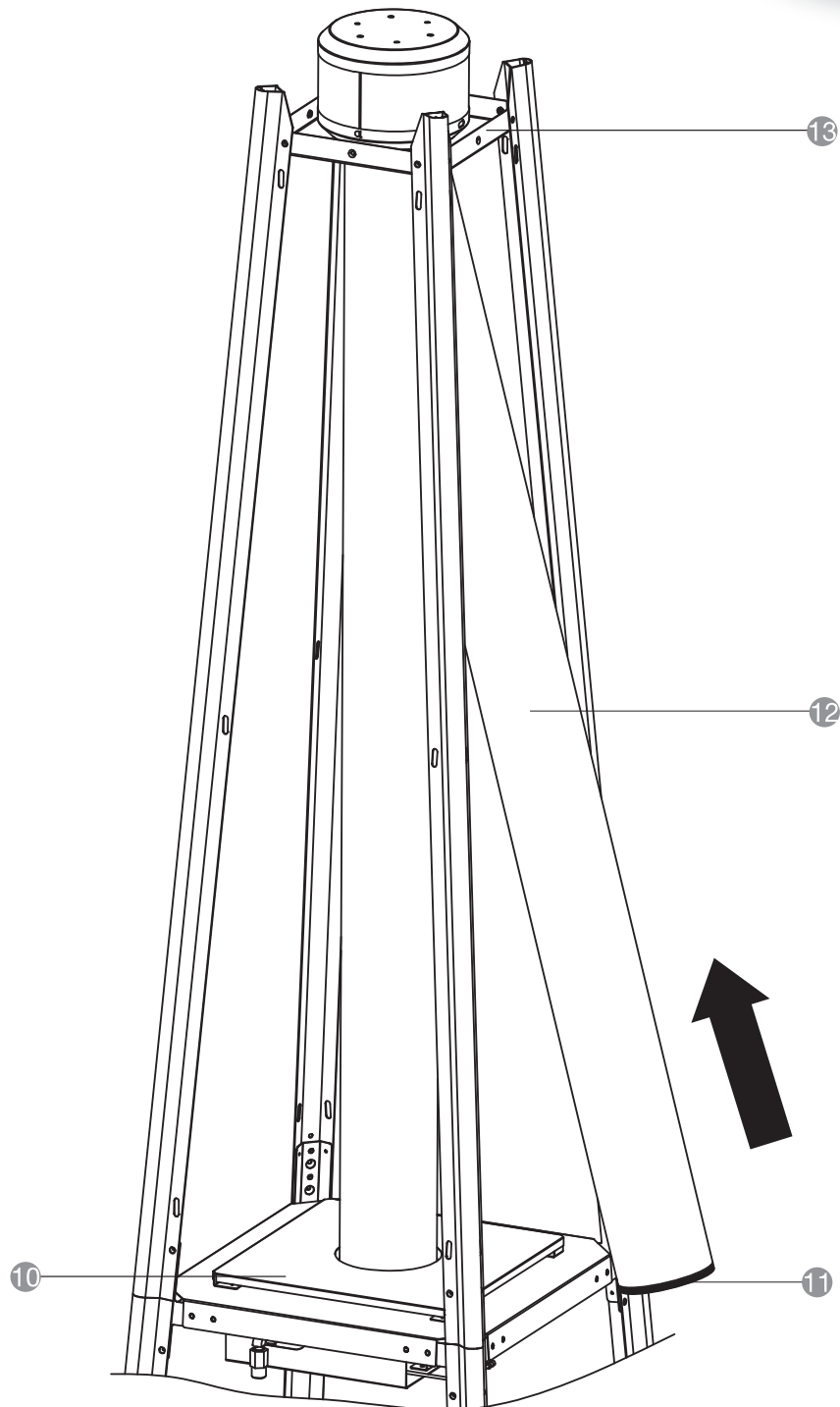
**⚠ WARNING**

The black silicone ring **11** must be in place around the lower rim of the flame tube **12** prior to operating the product.

Place the black silicone ring around the bottom edge of the flame tube.

Carefully install the flame tube by guiding it up into the open bottom of the emitter **13**. Do not force the tube.

Slide the bottom of the flame tube laterally into place and settle it into the hole in the center of the middle plate **10**.

Ensure that the tube is positioned properly to completely cover the hole.

8

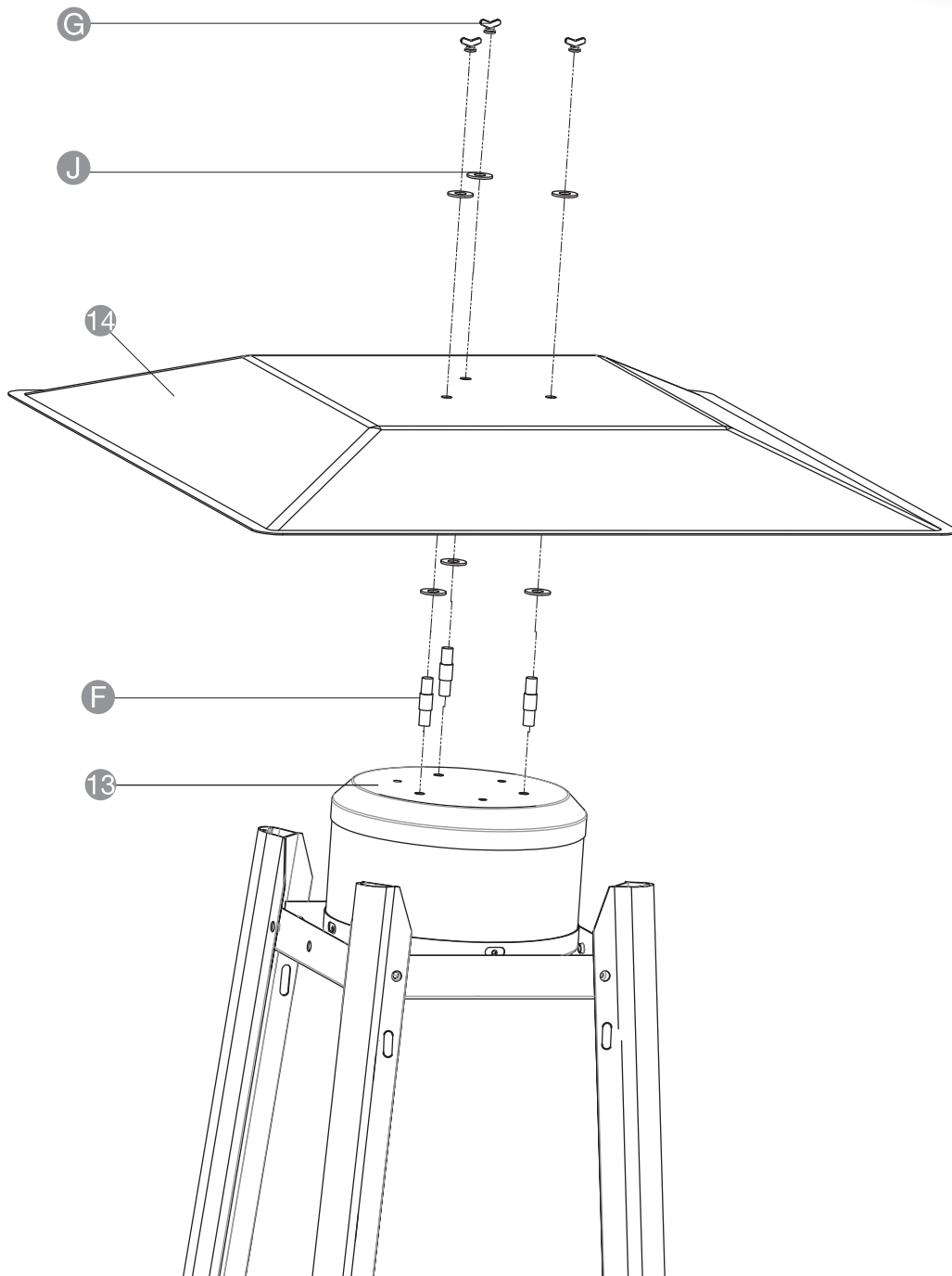

Hardware used: Stud **F** x3, Washer **J** x6, Wing Nut **G** x3

Attach the reflector **14** to the emitter **13**. Screw the 3 reflector studs **F** into the top of the emitter, then slide 3 washers **J** onto the studs.

Slide the reflector's drilled holes onto the studs.

Slide 3 washers onto the studs and secure the connection with 3 wing nuts **G**.

▲ NOTICE: Assembly step 8 may require a ladder. Follow safety precautions when working on a ladder.

9

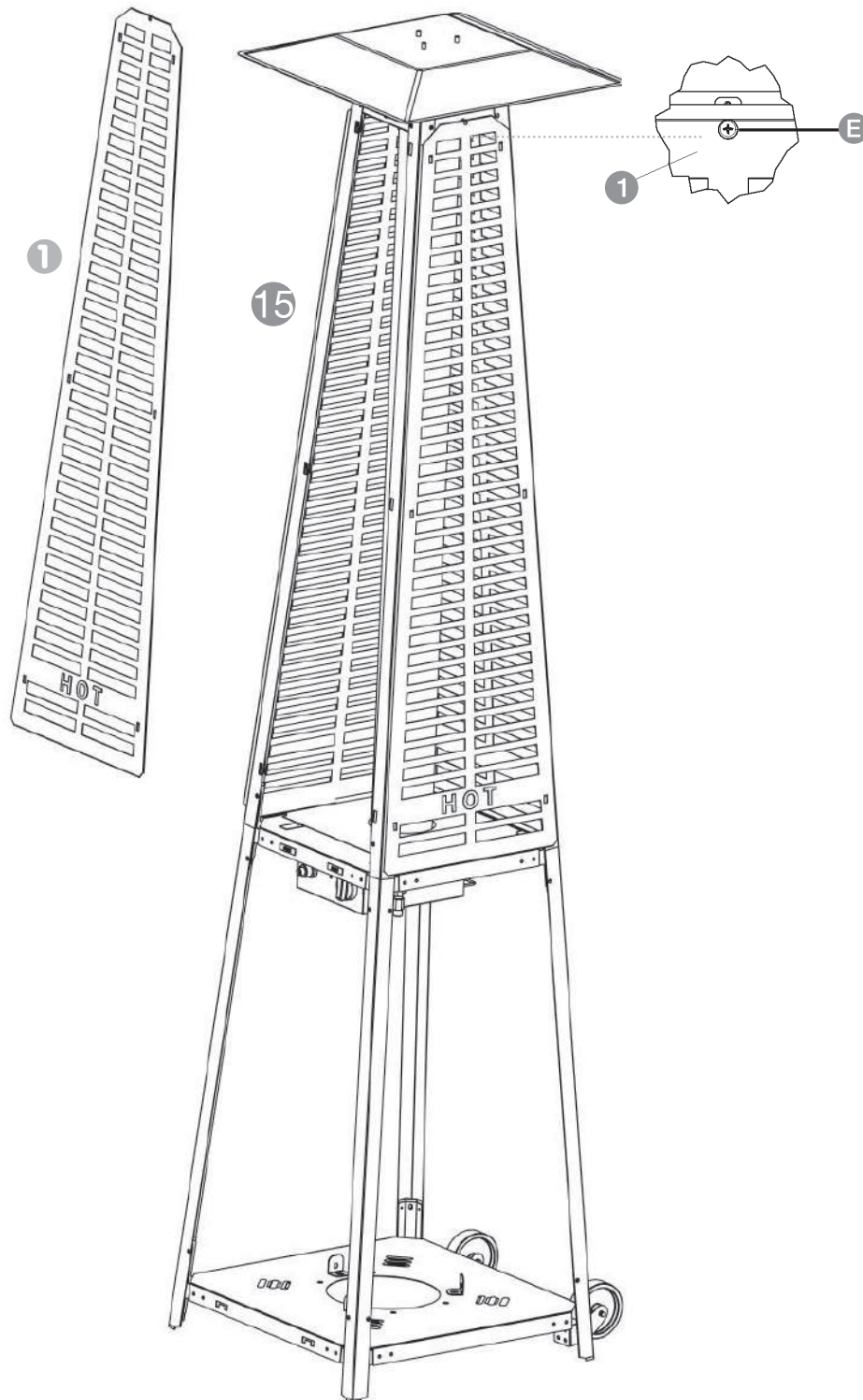

Hardware used: Screw ③ x4

Install the guard screens ①:

Hang the hooks of the guard screens into the holes near the top, middle, and bottom of the upper supports ⑮.

Secure the guard screens by inserting and tightening a screw ③ at the top of each screen.

10

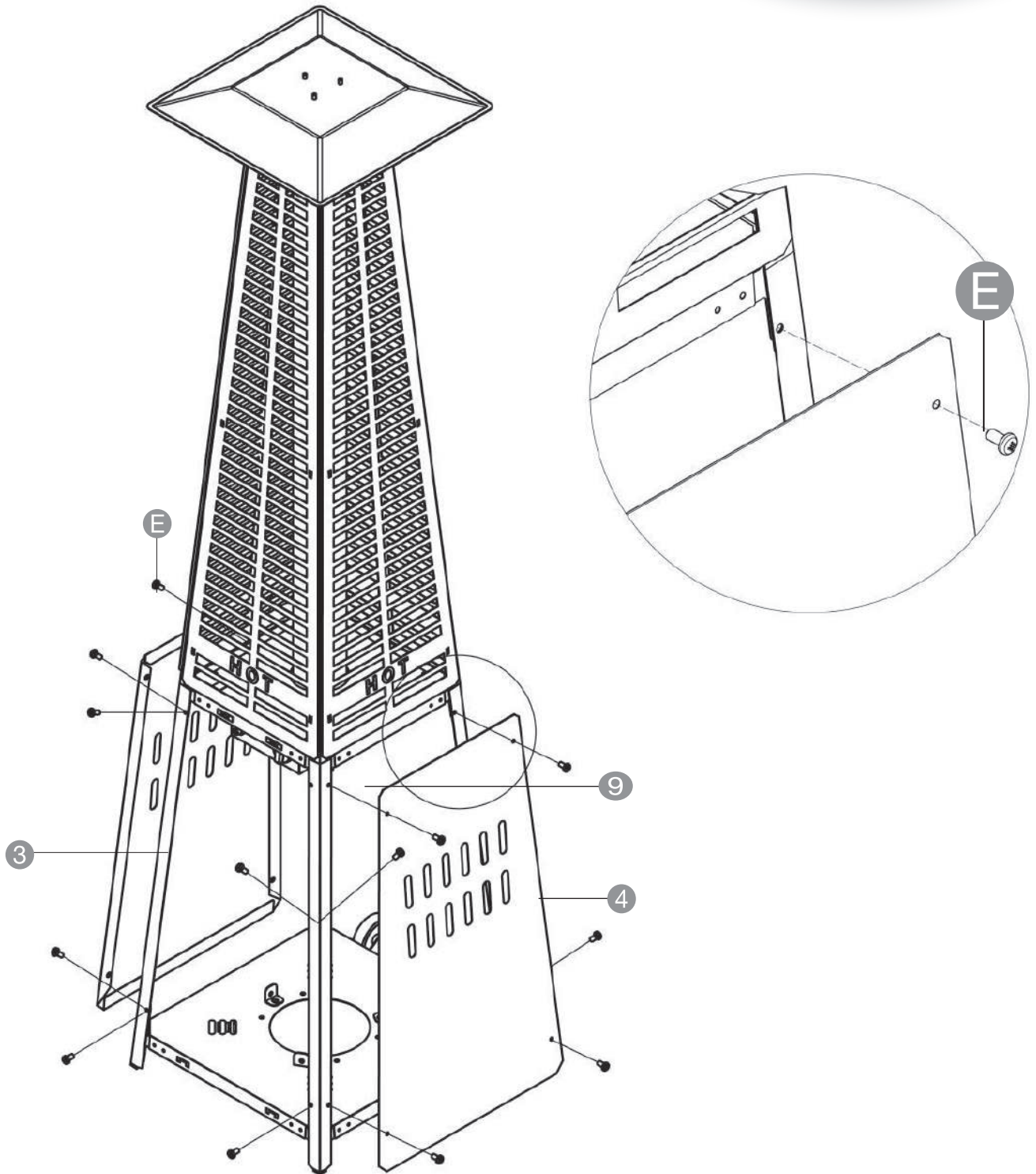
**Hardware used: Screw E x16**

Attach the side panels 4 and the back panel 9 to the product using 4 screws E per panel.

On the front side, insert the 4 screws E directly into the matching holes on the lower supports 3.

▲ NOTICE: Do not cover the front (where the control knob of the control box faces).

11

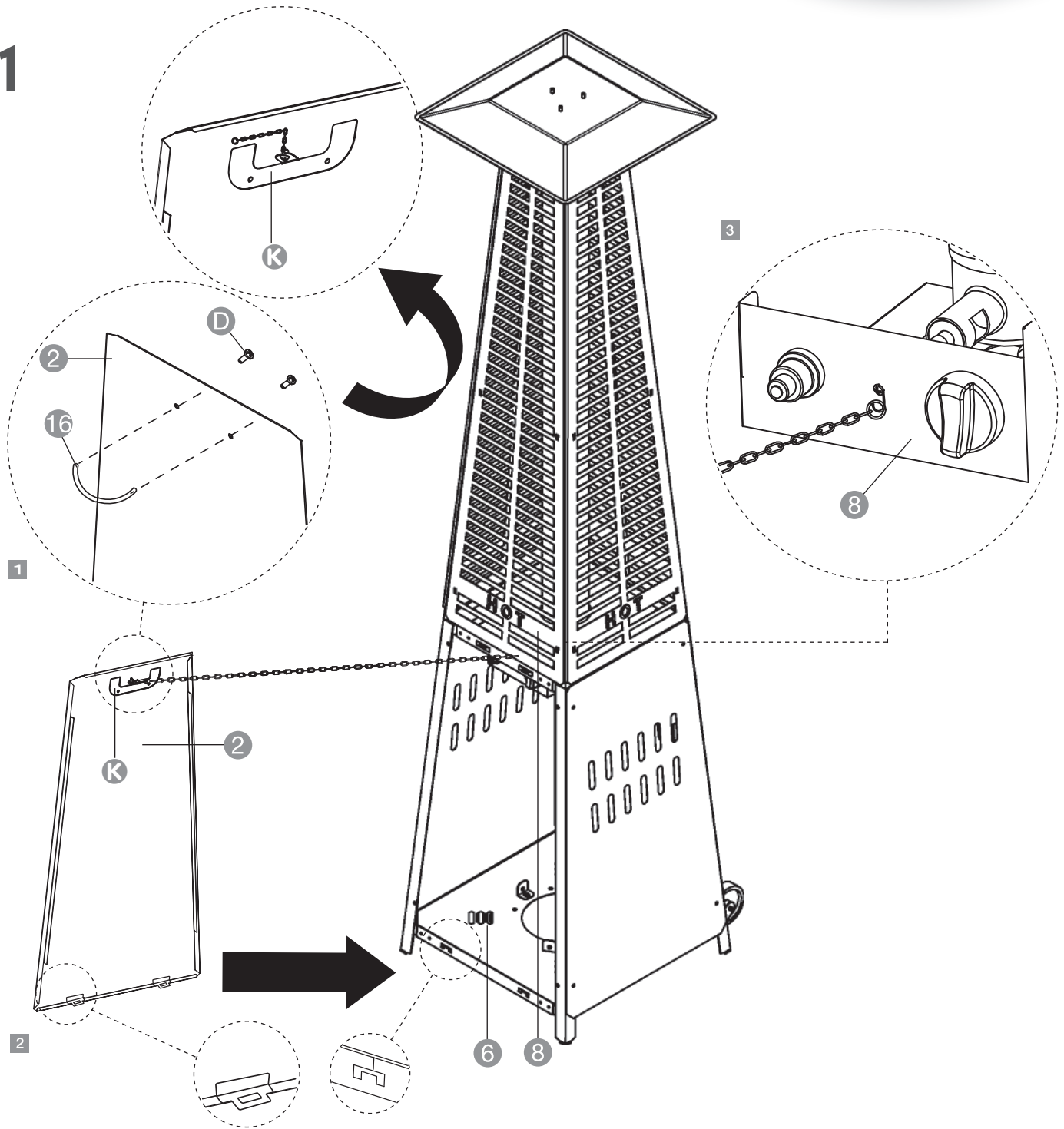

Hardware/Parts used: Screw ① x2, Handle Brace ①

- 1 Attach the handle ① to the outside of the door panel ② and connect it with the handle brace ① on the inside of the door panel using 2 screws ①.
- 2 Insert the tabs on the bottom of the door panel into the tab holes at the front of the base plate ⑥.
- 3 Attach the chain at the hook on the front of the control box ⑧.

12

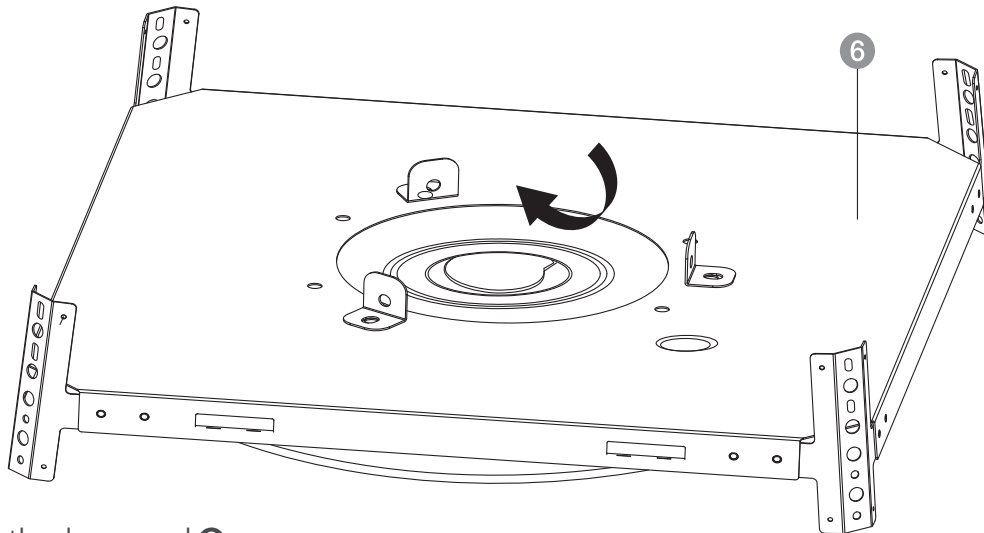

Remove the door panel **2**.

Pry open the plastic cap of the sandbox (pre-installed under the base plate **6**).

Fill the sandbox with sand or water, then securely close the plastic cap.

13

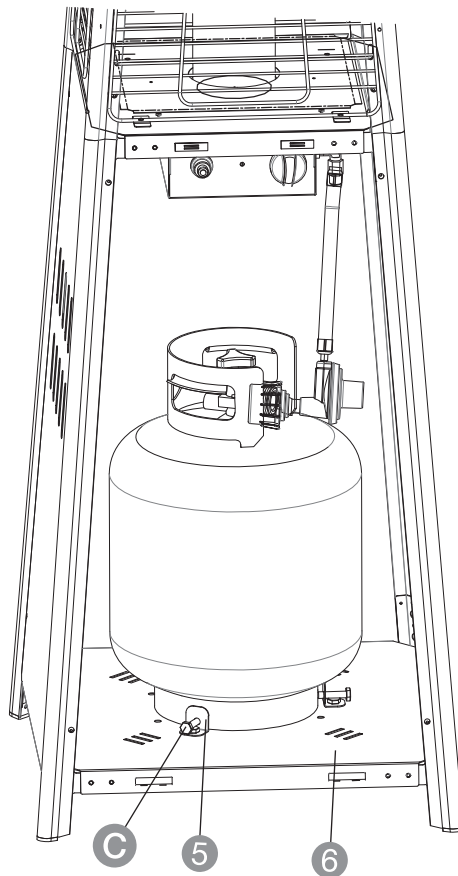

Place an LPG cylinder (not included) on the base plate **6**. Connect the regulator end of the gas hose with the LPG cylinder (not included). Do not cross-thread. Secure the LPG cylinder with the gas cylinder brackets **5** by tightening the 3 long bolts **C**.

⚠ NOTICE: Only use a standard 20 lb LPG cylinder.

Information on Gas Cylinders

- Use this product only with a LPG vapor withdrawal supply system.
- Storage of the product indoors is permissible only if the cylinder is disconnected and removed from the product. A cylinder must be stored outdoors in a well-ventilated area out of the reach of children. A disconnected cylinder must have dust caps tightly installed and must not be stored in a building, garage or any other enclosed area.
- The pressure regulator and hose assembly supplied with the product must be used.
- Check the hose and regulator before use.
- Inspect the visible hose portion of the regulator before use. Check it completely at least annually.
- Replacements of the hose and regulator must be those specified by the manufacturer.
- The hose and regulator must be UUCSA certified, the outlet pressure of the regulator must be according to the table in the "Specifications" chapter. Suitable spare parts are available from specialist dealers.
- The installation must conform with local codes.
- A dented, rusted or damaged LPG cylinder may be hazardous and should be checked by your LPG supplier. Never use a LPG cylinder with a damaged valve connection.
- The length of the hose cannot exceed 4.6 ft.
- The cylinder must have a listed overfilling prevention device.
- The cylinder must have a connection device compatible with the connection for the product.
- The cylinder must include a collar to protect the cylinder valve.
- Never connect an unregulated LPG cylinder to the product.
- Do not store a spare LPG cylinder under or near this product.
- Never fill the cylinder beyond 80 % full.
- Place the dust cap on the cylinder valve outlet whenever the cylinder is not in use. Only install the type of dust cap on the cylinder valve that is provided with the cylinder valve. Other types of caps or plugs may result in leakage of LPG.

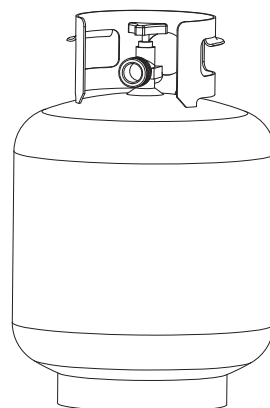

OPERATION

Inserting Battery

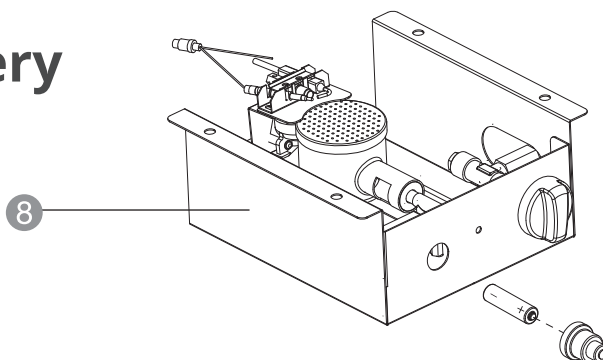

- Unscrew the ignition switch button on the control box ⑧. Install 1 AA battery (not included) with the + polarity end facing OUT.
- Screw the ignition switch button back in.

⚠ NOTICE: Always insert the battery with correct polarity (+ and -) orientation marked on the battery and product.

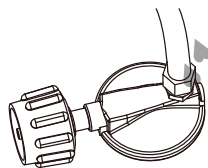
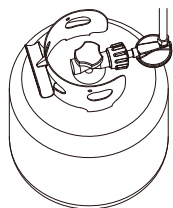
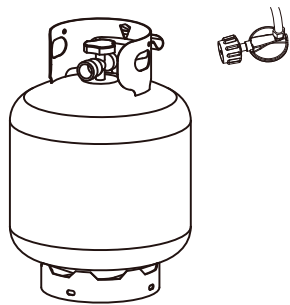

Hose / Regulator
Connection

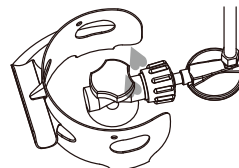

Regulator / Cylinder
Connection

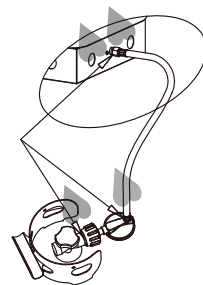

A minimum supply pressure of .5 psi is required for the purpose of input adjustment of propane gas. Storage of this patio heater indoors is permissible only if the cylinder is disconnected and removed from the appliance. A cylinder must be stored outdoors in a well-ventilated area out of the reach of children. A disconnected cylinder must have dust caps tightly installed and must not be stored in a building, garage, or any other enclosed area. The minimum permissible gas supply pressure of 11 W.C. is required for purpose of hose adjustment. The minimum hourly of 17,500 BTU is required input rating for a heater for automatic operation rating less than full input rating.

The pressure regulator and hose assembly supplied with the appliance must be used.

The installation must conform with local codes, or in the absence of local codes, with national fuel gas code, ANSI Z223.1/NFPA54, natural gas and propane Installation Code, CSA B149.1, or propane storage and handling code, B149.2

A dented rusted or damaged propane cylinder may be hazardous and should be checked by your local cylinder supplier. Never use a propane cylinder with a damaged valve connection. The propane cylinder must be constructed and marked in accordance with the specifications for LP gas cylinders of the U.S. Department of Transportation (DOT) or the standard for cylinders, spheres and tubes for transportation of dangerous goods and commission, CAN/CSA-B339.

- Do not store a spare LP-gas cylinder under or near this appliance.
- Never fill the cylinder beyond 80 percent full.
- Place the dust cap on the cylinder valve outlet whenever the cylinder is not in use. Only install the type of dust cap on the cylinder valve that is provided with the cylinder valve. Other types of caps or plugs may result in leakage of propane.

- The cylinder must have a listed overfilling prevention device.
- The cylinder must have a connection device compatible with the connection for the appliance.
- The cylinder used must include a collar to protect the cylinder valve.
- Never connect an unregulated propane cylinder to the heater.

OPERATING INSTRUCTIONS



LEAK TEST

1. Make 2–3 oz. of leak test solution (one part liquid dish washing detergent and three parts water).
2. Apply several drops of solution where hose attaches to regulator.
3. Apply several drops of solution where regulator connects to cylinder.
4. Make sure all patio heater valves are OFF.
5. Turn cylinder valve ON.



WARNING

- Perform all leak tests outdoors.
- Extinguish all open flames.
- NEVER leak test when smoking
- Do not use heater until all connections have been leak tested and show no signs of leakage.

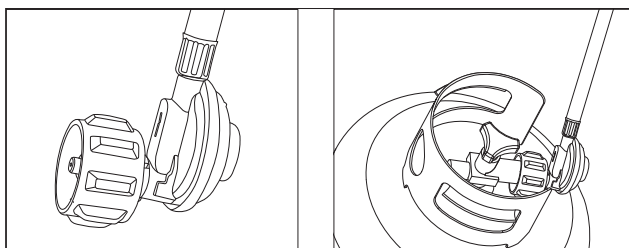

IF BUBBLES APPEAR AT ANY CONNECTION, THERE IS A LEAK.

1. Turn cylinder valve OFF.
2. If leak is detected at hose/regulator connection, tighten connection and perform another leak test. If bubbles continue to appear, call our customer service hotline at **(866) 985-7877**, 9 a.m. – 9 p.m., EST.
3. If leak is detected at regulator/cylinder valve connection, disconnect, reconnect, and perform another leak test. If you continue to see bubbles after several attempts, cylinder valve is defective. Call our customer service hotline at **(866) 985-7877**, 9 a.m. – 9 p.m., EST.

IF NO BUBBLES APPEAR AT ANY CONNECTION, THE CONNECTIONS ARE SECURE.

Note: Whenever gas connections are loosened or removed, you must perform a complete leak test.



WARNING: FOR OUTDOOR USE ONLY



CARBON MONOXIDE HAZARD

This appliance can produce carbon monoxide which has no odor. Using it in an enclosed space can kill you. Never use this appliance in an enclosed space such as a camper, tent or home.

Caution: Do not attempt to operate this appliance until you have read and understand all Safety Information in this manual and all assembly is complete and leak tests have been performed.

BEFORE TURNING GAS SUPPLY ON:

1. Your heater was designed and approved for **OUTDOOR use only**. Do NOT use it inside a building, garage, or any other enclosed area.
2. Make sure surrounding areas are free of combustible materials, gasoline, and other flammable vapors or liquids.
3. Ensure that there is no obstruction to air ventilation. Be sure all gas connections are tight and there are no leaks.
4. Be sure the cylinder cover is clear of debris. Be sure any component removed during assembly or servicing is replaced and fastened prior to starting.

BEFORE LIGHTING:

1. Heater should be thoroughly inspected before each use, and by a qualified service person at least annually. If re-lighting a hot heater, always wait at least 5 minutes.
2. Inspect the hose assembly for evidence of excessive abrasion, cuts, or wear. Suspected areas should be leak tested. If the hose leaks, replace it prior to operation. Only use the replacement hose assembly specified by the manufacturer.

Lighting Instructions

NOTE: For initial start, or after any cylinder change, depress control knob for 2 minutes to purge air from gas lines before proceeding.

1. Ensure the control knob is in the OFF position. Slowly open the LPG cylinder valve.
2. Press and turn the control knob to the **PILOT** position (counterclockwise). While depressing the control knob, press the red igniter button. You should hear a sparking/clicking sound of the electronic igniter.
3. Continue to hold in the control knob and check for the pilot flame through the glass tube. If the pilot does not light, turn the control knob clockwise to the **OFF** position. Repeat steps 2-3.

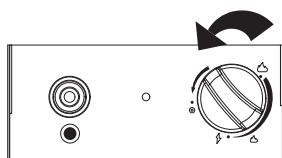

Figure 1

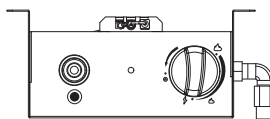

Figure 2

4. Once the pilot flame is lit, release the control knob and turn clockwise to **HIGH** or the preferred heat level.
5. To turn the heater off, turn the control knob clockwise to **PILOT**. Depress the control knob and turn clockwise to **OFF**. Close the valve on the LPG cylinder when the product is not in use.

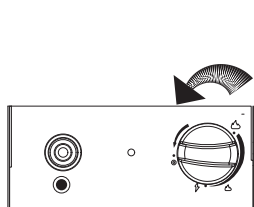

Figure 3

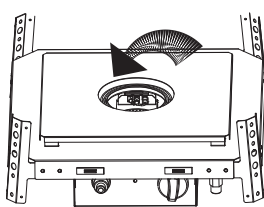

Figure 4

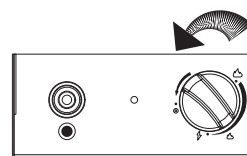

Figure 5

NOTICE If pilot fails to remain lit, close all valves and wait at least 5 minutes before attempting to light again.

CAUTION Avoid inhaling fumes emitted from the heater's first use. Smoke and odor from the burning of oils used in manufacturing may appear. Both smoke and odor will dissipate after about 30 minutes. The heater should not produce thick black smoke.

NOTICE The burner may be noisy when initially turned on. To eliminate excessive noise from the burner, turn the control knob to the **PILOT** position. Then, turn the knob to the desired heat level.

NOTICE Under normal conditions, the flame height at **HIGH** setting is approximately 2/3 of the height of the flame tube, and the flame height at **LOW** setting is approximately 1/3 of the height of the flame tube. The flame should be stable and bright, and not produce noise at a distracting level or create smoke. If you notice noise or smoke, this is abnormal operation.

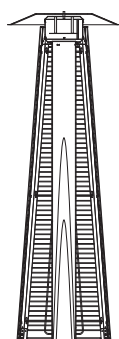

Normal flame

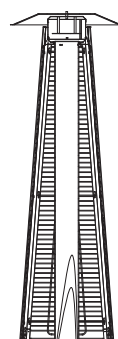

Abnormal flame

WARNING **Risk of injury!** Be careful when attempting to manually ignite this product. Holding in the control knob for more than 10 seconds before igniting the gas will cause a ball of flame upon ignition.

OPERATING INSTRUCTIONS



OPERATION CHECKLIST:

For a safe and pleasant heating experience, perform this check before each use:

BEFORE OPERATING:

- I am familiar with entire owner's manual and understand all precautions noted.
- All components are properly assembled, intact and operable.
- No alterations have been made.
- All gas connections are secure and do not leak.
- Wind velocity is below 10 mph.
- Heater is for use outdoors (outside any enclosure).
- There is adequate fresh air ventilation.
- Heater is away from gasoline or other flammable liquids or vapors.
- Heater is away from windows, air intake openings, sprinklers and other water sources.
- Heater has at least 3.3'/40"/1m clearance overhead and on on sides from combustible materials.
- Heater is on a hard and level surface.
- There are no signs of spider or insect nests in heater orifices.
- All burner passages are clear.
- All air circulation passages are clear.
- Clothing or other protective material should not be hung from the heater, or placed on or near the heater.
- Any guard or other protective device removed for servicing the heater must be replaced prior to operating the heater.
- Installation and repair should be done by a qualified service person. The heater should be inspected before each use and at least annually by a qualified service person.

OPERATION INFORMATION AND SAFETY:

- Unit will operate at reduced efficiency below 40°F.
- Alert children and adults to the hazards of high surface temperatures and should stay away to avoid burns or clothing ignition.
- Carefully supervise young children in the area of the heater.
- More frequent cleaning may be required as necessary. It is imperative that control compartment burner and circulating air passageways of the heater be kept clean and free of debris and/or spider or insect nests.



RE-LIGHTING:

For your safety, the control knob cannot be turned off without first depressing the control knob in the **PILOT** position and then rotating it to the **OFF** position.

1. Turn the control knob to **OFF**. Wait at least 5 minutes for gas to dissipate.
2. Repeat the steps under **LIGHTING INSTRUCTIONS** on the previous page.



DURING OPERATION:

Flame should be mostly blue and yellow. If excessive flame or smoke is detected, turn off heater and consult "Troubleshooting" section of manual.



WARNING

FOR YOUR SAFETY
Heater will be hot after use. Handle with extreme care.



SHUT DOWN:

1. Turn control knob clockwise to **OFF** while depressing the knob. (Normally, burner may make a slight popping noise when extinguished).
2. Turn cylinder valve clockwise to **OFF** and disconnect regulator when heater is not in use.

NOTE: After use, some discoloration of the emitter screen is normal.



AFTER OPERATION:

1. Turn gas control knob to **OFF** position.
2. Turn gas tank valve **OFF**.
3. Disconnect gas line.
4. Store heater upright in a secure location.



To enjoy years of outstanding performance from your heater, make sure you perform the following maintenance activities on a regular basis:

KEEP EXTERIOR SURFACES CLEAN.

1. Use soapy water for cleaning. Never use flammable or corrosive cleaning agents.
2. While cleaning your unit, be sure to keep the area around the burner and control compartment dry at all times. Do not submerge the control valve assembly. If the gas control is submerged in water, do NOT use it. It must be replaced.
3. Air flow must be unobstructed. Keep controls, burner, and circulating air passageways clean. Signs of possible blockage include:
4. Gas odor with extreme yellow tipping of flame.
5. Heater does NOT reach the desired temperature.
6. Heater glow is excessively uneven.
7. Heater makes popping noise.
8. Spiders and insects can nest in burner or orifices. This dangerous condition can damage heater and render it unsafe for use. Clean burner holes by using a heavy-duty pipe cleaner. Compressed air may help clear away smaller particles.
9. Carbon deposits may create a fire hazard. Clean dome and burner screen with warm soapy water if any carbon deposits develop.

Note: In a salt-air environment (such as near an ocean), corrosion occurs more quickly than normal. Frequently check for corroded areas and repair them promptly.



TIP FOR STAINLESS STEEL MODELS:

Use high-quality automobile wax to help maintain the appearance of your heater. Apply to exterior surfaces from the post down. DO NOT apply to emitter screen or domes.



WARNING

FOR YOUR SAFETY

- Do NOT touch or move heater for at least 45 minutes after use.
- Reflector is hot to the touch.
- Allow reflector to cool before touching.

STORAGE:

Between uses:

- Turn control knob OFF.
- Disconnect LP source.
- Store heater upright in an area sheltered from direct contact with inclement weather (such as rain, sleet, hail, snow, dust and debris).
- If desired, cover heater to protect exterior surfaces and to help prevent build-up in air passages. Never leave LPG tank exposed to direct sunlight or excessive heat.

Note: Wait until heater is cool before covering.

SERVICE:

Only a qualified service person should repair gas passages and associated components.

Caution: Always allow heater to cool before attempting service.



PROBLEM	POSSIBLE CAUSE	CORRECTIVE ACTION
Main burner will not light	Gas valve may be off	Turn gas valve ON
	Fuel tank may be empty	Refill LPG tank
	Orifice blocked	Clean or replace orifice
	Air in supply system	Purge air from lines. Open gas lines and depress control knob for 2-3 minutes.
	Loose connection	Check all fittings
	Igniter fails	Check igniter cable connection at back of igniter
	Gas pressure low with valve open full	Replace cylinder or regulator
	New cylinder or 1st ignition	Purge air from lines
	Cylinder valve on, no gas flow	Replace hose/regulator assembly
	Dead battery	Replace AA battery behind igniter button
Low burner flame	Pressure is low	Replace LPG tank
	Tank is low on fuel	Fill LPG tank
	Gas hose is kinked	Check and straighten or replace
Burner unit	Carbon on reflector and emitter screen	Clean components as needed
	Thick black smoke	Blockage in burner assembly—thoroughly clean burner



塔狀戶外瓦斯暖爐

品項 / 商品編號 2127168

組裝 / 維護與使用說明

內含重要說明，請保留以供日後參考：請詳閱

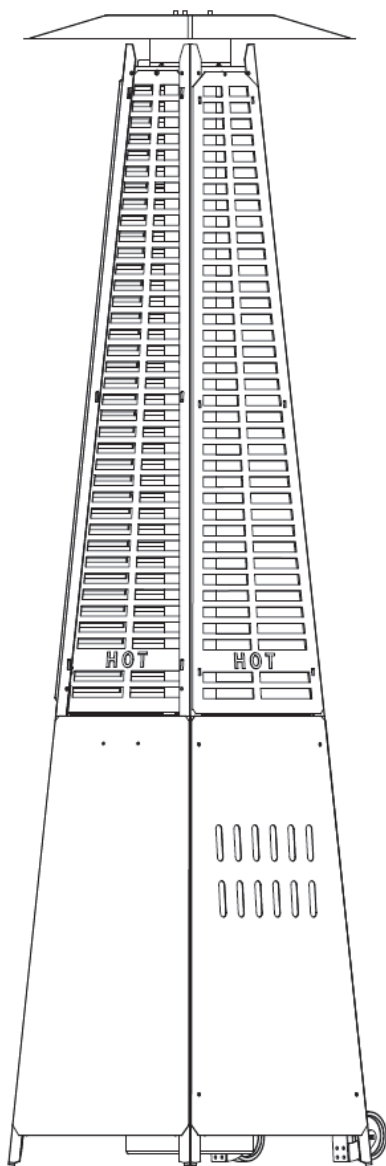

⚠ 危險

為了您的安全：
如果聞到瓦斯味：
1. 關閉與設備連接的瓦斯。
2. 熄滅所有的未遮蓋火焰。
3. 若仍持續聞到異味，請遠離本產品並立即聯絡瓦斯供應商或消防局。

⚠ 危險

未能遵照本產品所提供的注意事項及指示說明會導致因火災、爆炸、燒傷、窒息以及 / 或一氧化碳中毒的危害所造成的死亡、嚴重的身體傷害及財產損失或損壞。只有了解並遵照說明指示的人員才能使用或維修本產品。

⚠ 警告

本產品僅適用於戶外。

⚠ 警告

本產品會使您暴露於包括一氧化碳、鉛、鉻（六價化合物）、鄰苯二甲酸二（2-乙基己基）酯（DEHP）以及酞酸二異壬酯（DINP），其為加州認定會導致癌症以及出生缺陷或是其他生殖傷害之物質。
請至網址www.P65Warnings.ca.gov搜尋更多資訊。

⚠ 警告

不當的安裝、調整、改裝、維修或保養可能會造成財產損失、受傷或死亡。安裝或維修本產品之前請仔細地閱讀安全、操作及保養說明。

⚠ 警告

請勿在本產品或其他任何設備附近存放或使用汽油或其他易燃揮發氣或液體。未連接使用的液化石油瓦斯桶不應擺放在本產品或其他任何裝置附近。



此處黏貼收據

請留存購貨證明或是訂購確認單，若您需要針對保固涵蓋項目與我們聯絡時，會需要提供這些資料。

序號 _____

購買日期 _____



遇到問題、疑難、零件遺失？

在將商品退回零售商之前，可先聯絡位於佛羅里達州的客服團隊總部。
提供英語與西班牙語服務。

撥打免費電話

電子郵件

線上客服

(866) 985-7877

cservice@welltraveled.net

www.balkenehome.com

上午9點至下午9點（東岸標準時間）

週一至週五，上午9點至下午9點（東岸標準時間）



目錄

使用前說明	第25頁
安全事項	第26頁
包裝內容物	第27頁
五金零件內容物	第27頁
組裝	第28 - 38頁
操作說明	第39 - 42頁
維護與保養說明	第43頁
故障排除	第44頁
產品保固資訊	第45頁



使用前說明

嘗試組裝、操作或安裝本產品之前請閱讀並了解本手冊完整的內容說明。
若有任何有關於本產品的問題，請寄送電子郵件至 cservice@welltraveled.net。
(我們提供英語與西班牙語的服務。)

本手冊內含本產品組裝、操作及保養的重要資訊。手冊中除了前幾頁有一般安全事項的說明之外，其他的頁面也有相關內容。請保留本手冊以供日後參考並教導新的使用者有關本產品的相關資訊。本手冊應與產品上的標籤內容一起閱讀。這些安全注意事項在所有涉及機械或丙烷燃料設備都是不可或缺的。這些注意事項在使用、收納及維修本產品時都是必要的。依要求的重視與謹慎態度使用本產品，會降低人身傷害或財產損失的可能性。以下頁面所顯示的符號會廣泛地運用於本手冊內。務必遵守這些注意事項，因為在使用所有機械或燃料設備時它們都是必要的。

危險

爆炸 - 火災的危險

- 將諸如建築材料、紙或紙板的易燃固體，依手冊所建議的與本產品保持一個安全距離。
- 與燃燒室相通的通風口周圍應提供足夠的間隔距離。
- 切勿在存在或可能含有揮發性或空氣浮游的易燃物，或製造諸如汽油、溶劑、油漆稀釋劑、塵粒或未知的化學物的空間內使用本產品。
- 本產品在使用操作時會成為一個點火源。其擺放的區域應清空並且無擺放可燃材料、汽油、油漆稀釋劑、清潔溶劑及其他易燃揮發氣與液體。請勿在高含塵量的區域使用本產品。本產品與易燃材料的最小間距：頂端間距3英尺 / 36英寸 (91公分) 而四周間距為2英尺 / 24英寸 (61公分)。
- 切勿將丙烷存放在靠近高溫、露焰、引火、陽光直射、其他點火源或溫度超過120° F (49°C) 的地方。
- 丙烷揮發氣較空氣重，並會累積在低位處。若聞到瓦斯味，請立即離開該區域。
- 切勿在本產品點燃、靠近火舌、引火或其他點火源，或是產品依舊燙手時安裝或移動桶裝瓦斯。
- 本產品使用時極為熾熱，並會點燃太靠近本產品的易燃物。請勿在本產品或其他任何設備附近存放或使用汽油或其他易燃揮發氣或液體。易燃物應與頂端以及四周保持至少3.3英尺 / 40英寸 / 1公尺的距離。汽油及其他易燃液體及揮發氣應與本產品保持適當距離。
- 將桶裝瓦斯存放在戶外通風良好，且為孩童無法接觸到的場所。切勿將桶裝瓦斯收納在封閉區域 (屋內、車庫等處)。若需將本產品收納在室內時，應卸下桶裝瓦斯以便戶外收納。

警告： 僅供戶外使用



一氧化碳危害

本產品會產生無味的一氧化碳。在密閉空間內使用本產品會導致死亡。切勿在諸如露營車、帳篷、車內或家裡等密閉空間內使用本產品。

危險

一氧化碳危害

- 本產品為燃燒裝置。所有燃燒裝置在燃燒的過程中會產生一氧化碳 (CO)。本產品設計可在遵照所有的警告事項及指示說明進行使用及保養時，產生極少量、無害的一氧化碳量。請勿阻擾空氣在本產品的進出流通。
- 一氧化碳 (CO) 中毒會產生類似感冒的症狀、溢淚、頭痛、暈眩、疲勞並造成可能的死亡。它是隱形殺手。若在使用操作本產品時出現這些症狀，請立即呼吸新鮮的空氣。
- 僅供戶外使用。
- 切勿在屋內，或是其他不通風或密閉的區域使用。
- 本產品會消耗空氣 (氧氣)。請勿在不通風或密閉的區域使用以避免危及生命安全。

警告

警告代表一個立即的危險狀況，若未加以避免，可能會造成死亡或嚴重的傷害。

警告

燒傷的危險

- 切勿在本產品仍熱燙或是還在使用時任其無人看顧。
- 孩童應遠離本產品。

警告

某些材料或物品收納於本產品下方時，會因輻射熱的影響而可能造成嚴重的損壞。

小心

小心代表一個立即地危險狀況，若未加以避免，可能會造成輕微或中度的人身傷害或財產損失。

小心

維修安全事項

- 所有接頭及管件應保持乾淨。確保桶裝瓦斯閥的出口乾淨清潔。
- 裝設時，以肥皂水檢查所有接頭及管件是否洩露。切勿以火檢查是否洩露。
- 只能作為取暖設備使用。切勿以任何方式改裝或與任何裝置搭配使用。

警告

- 本產品是以丙烷氣作為燃料。丙烷氣無色、無味且易燃。通常會加入氣味劑以助檢測洩漏的發生，該氣味會被形容成「壞掉的蛋」(“rotten egg”)。氣味劑會隨著時間而漸漸消失，因此瓦斯漏氣並非總是能單靠嗅覺便能察覺。
- 丙烷氣較空氣重，而洩漏的丙烷會停留在最低位處。它可能被點火源 (包括火柴、打火機、火花或是距離原洩漏處幾呎外的所有種類的露焰) 點燃。只能使用安裝揮發氣回收的丙烷氣。
- 收納或使用丙烷氣時，應遵照當地法令及法規或是ANS/NFPA 58規範。務必在不使用時關閉丙烷氣。
- 應警告孩童及成人表面高溫的危險。遠離這些表面以避免皮膚燒傷或是衣物被點燃。
- 幼童在本產品的鄰近區域時，應小心地加以看顧。
- 請勿在本產品或是在靠近本產品的位置吊掛衣物或其他任何的易燃材料。
- 重新安裝使用前，應將為維修而移除的所有防護或保護裝置安裝歸位。
- 安裝及維修應由合格的維修服務人員執行。本產品應在每次使用前以及每年，由合格的維修服務人員進行檢查。可視需要更為頻繁地清理本產品。本產品的操控室、燃燒器以及空氣循環通道保持清潔是極為重要的。

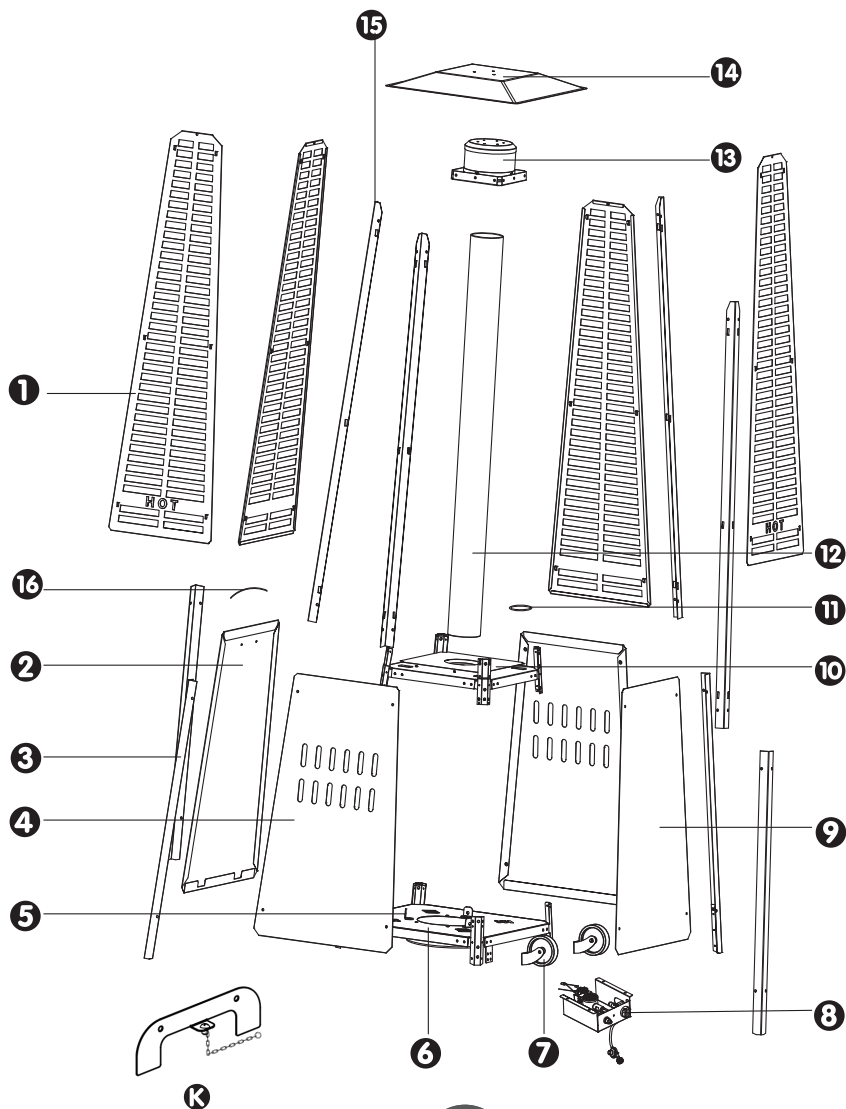

零件編號	內容說明	數量
①	防護網	4
②	門板	1
③	下端支撐杆	4
④	側板	2
⑤	瓦斯桶托座	4
⑥	底板	1
⑦	滑輪	2
⑧	控制盒	1
⑨	背板	1
⑩	中間隔板	1
⑪	橡膠環	1
⑫	焰管	1
⑬	放射器	1
⑭	反光罩	1
⑮	上端支撐杆	4
⑯	把手	1
K	把手支架 (預先安裝)	1

需使用一顆三號 (AA) 電池
(本產品未附)。
安裝於點火器按鈕後方。

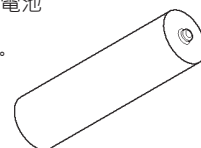

五金零件內容物



A
x2



B
x3

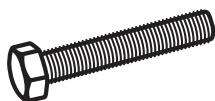

C
x3



D
x2

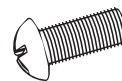

E
x64



F
x3



G
x3

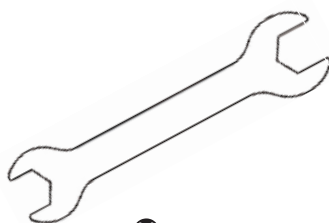

H
x2

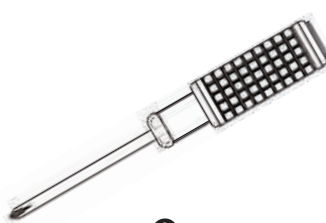

I
x1



J
x6



準備工作

開始組裝本產品之前，確保所有零件都已包含在內。所有的零件以本手冊第27頁所列的包裝內容物以及五金零件內容物的明細進行對照。若有任何零件遺失或損壞時，請勿嘗試組裝本產品。聯絡客服以取得替換零件。

預估組裝時間：90分鐘

組裝所需的工具（本產品未附）：可調月牙形扳手、洩漏檢測溶液、三號（AA）電池。

附註：本產品附電子點火裝置，需要安裝一顆三號（AA）電池。電池在安裝時必須先將點火器按鈕鬆開後才可進行安裝 - 本產品並未附電池。

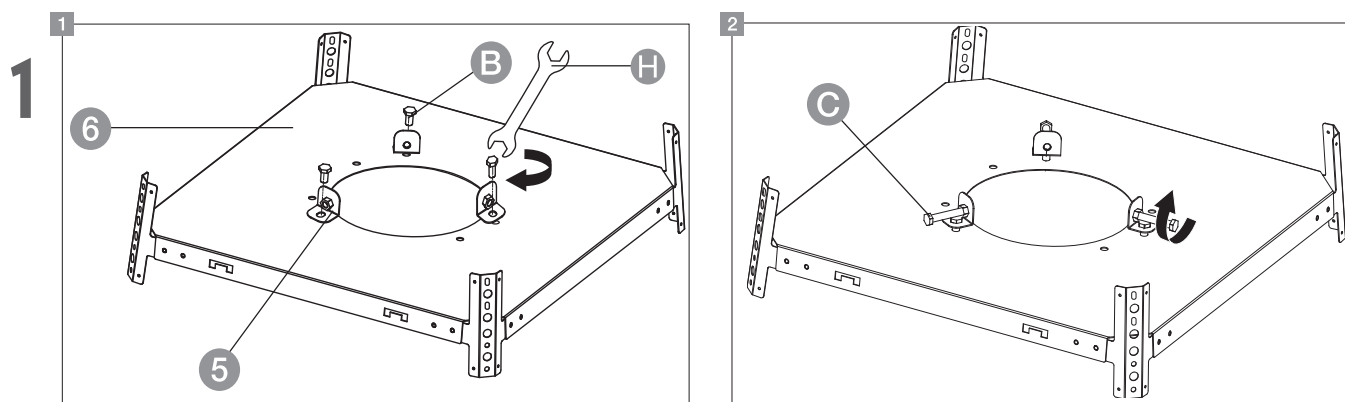

使用的五金零件：短螺栓 **B** x3、長螺栓 **C** x3

- 1** 將瓦斯桶托座**6**安裝於底板**6**：瓦斯桶托座對準底板中央大型孔洞周圍的小孔。以3顆短螺栓**B**將瓦斯桶托座固定於底板。轉動托座直立的部分將其對著底板的中間。以扳手**H**將短螺栓鎖緊。
- 2** 3顆長螺栓**C**插入連結在瓦斯桶托座小孔上的螺帽。請勿將長螺栓完全鎖緊（在步驟13固定瓦斯桶時才需確實鎖緊）。

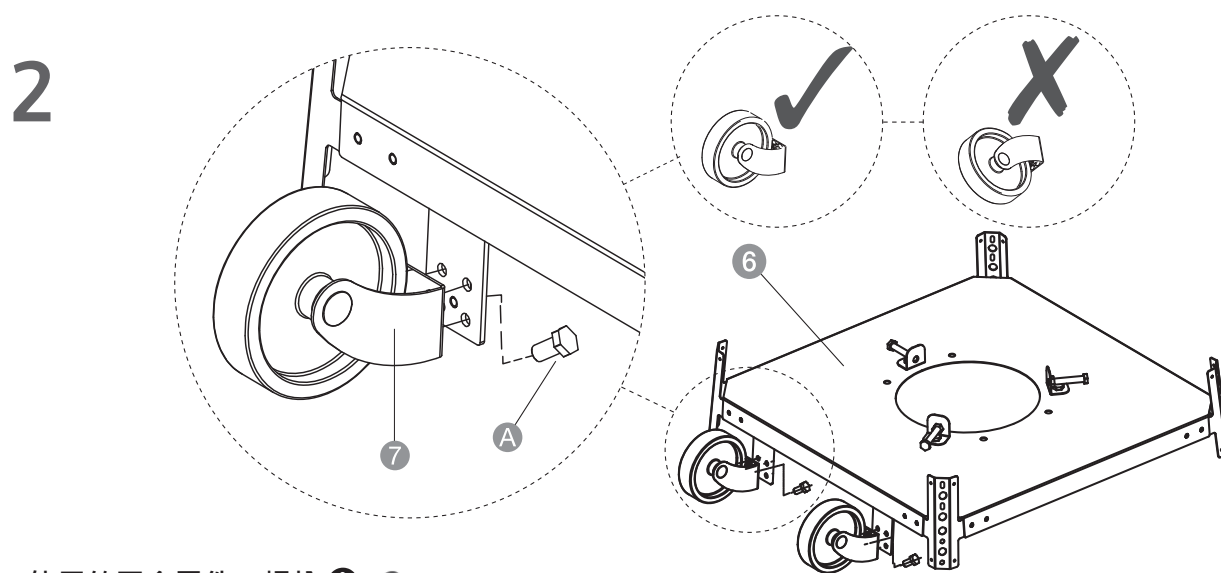

使用的五金零件：螺栓 **A** x2

以2顆螺栓**A**將滑輪**7**安裝於底板**6**。安裝時請留意滑輪的方向。確保滑輪托座指向底板上端（瓦斯桶托座安裝的那一面）。滑輪安裝前可先將底板翻面，在安裝時能更為輕鬆。

3

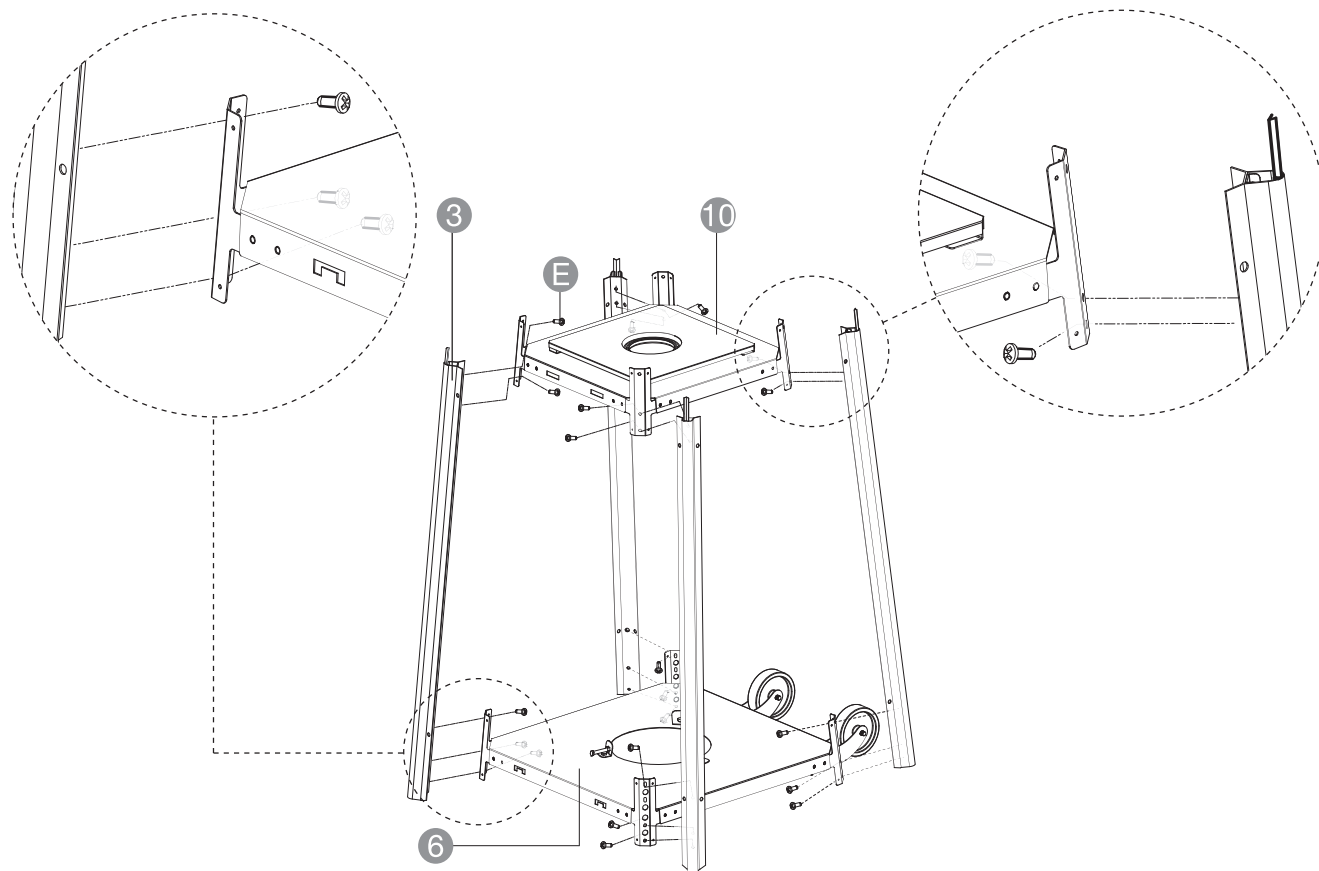

使用的五金零件：螺絲 **E** x20

組裝下端支架。下端支撐杆**3**底部的小孔對準底板**6**角落的小孔。使用12顆螺絲**E**將下端支撐杆固定於底板。以8顆螺絲**E**將中間隔板**10**安裝在下端支撐杆的頂端。中間隔板的箭頭標籤必須與底板對應的標籤指向相同的方向。

4

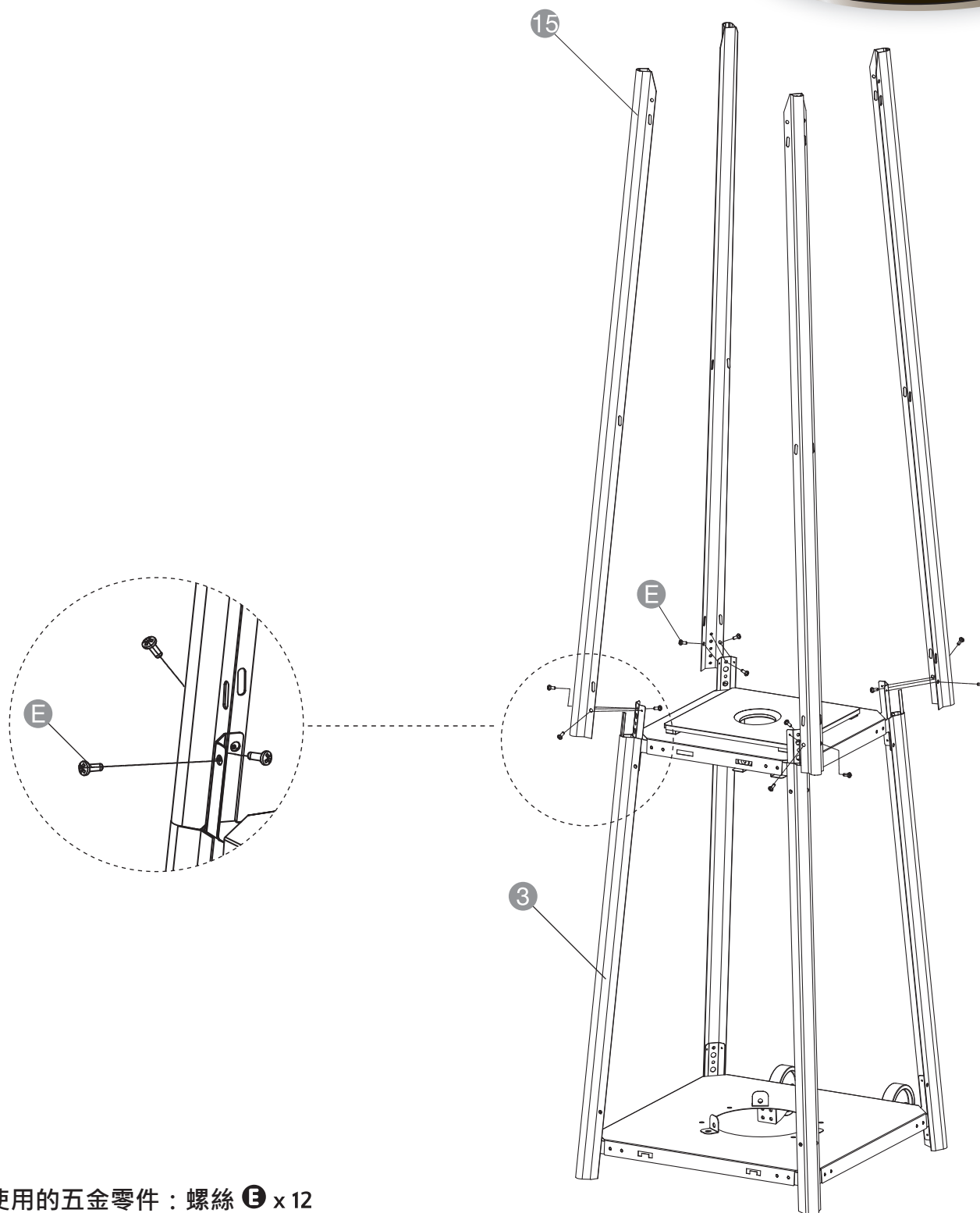

使用的五金零件：螺絲 ③ x 12

- 1 將4支上端支撐杆 ⑮ 推入下端支撐杆 ③ 。
- 2 將上端支撐杆相對應的開口推入下端支撐杆的V型軌道。
- 3 上端與下端支撐杆裝配時應對齊。以12顆螺絲 ③ 將接合處安裝固定。

5

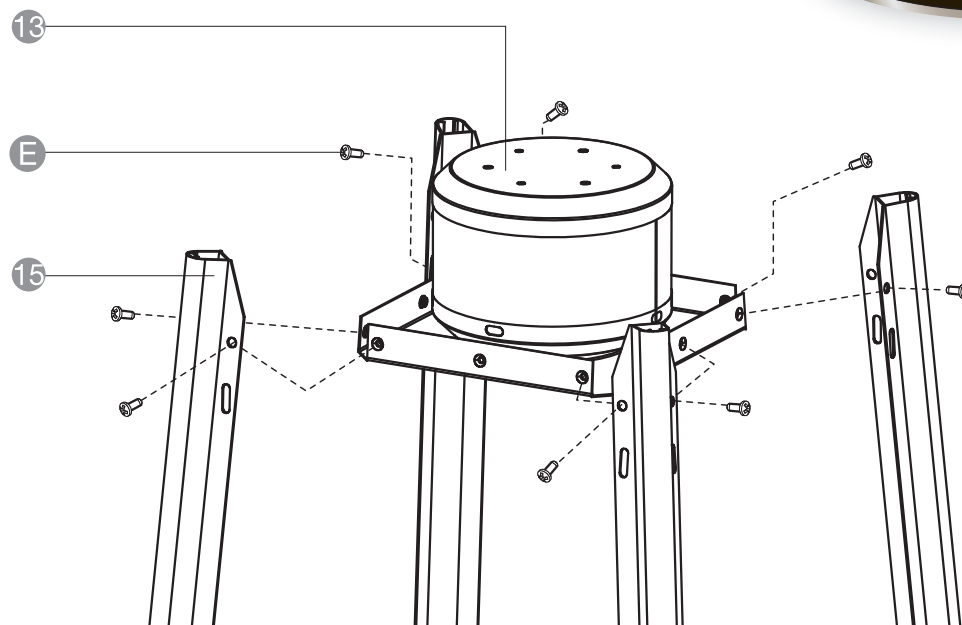

使用的五金零件：螺絲 ③ x8

使用8顆螺絲 ③ 將放射器 ⑬ 與上端支撐杆 ⑮ 安裝相接。

▲ 注意：步驟5的組裝作業會需要使用梯子。在梯子上作業時應遵守安全注意事項。

6

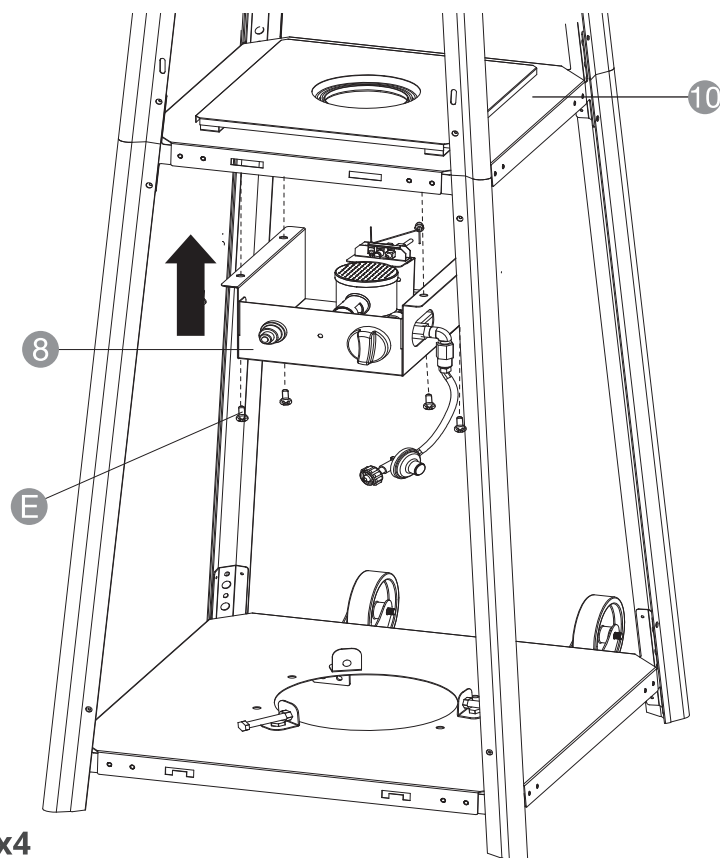

使用的五金零件：螺絲 ③ x4

使用4顆螺絲 ③ 將控制盒 ⑧ 與中間隔板 ⑩ 底部安裝相接。

▲ 注意：從步驟6開始，可以在無電池的情況下持續進行組裝，或是隨時在控制盒內裝入1顆三號（AA）電池（本產品未附）（請見「操作 - 安裝電池」段落）。

7

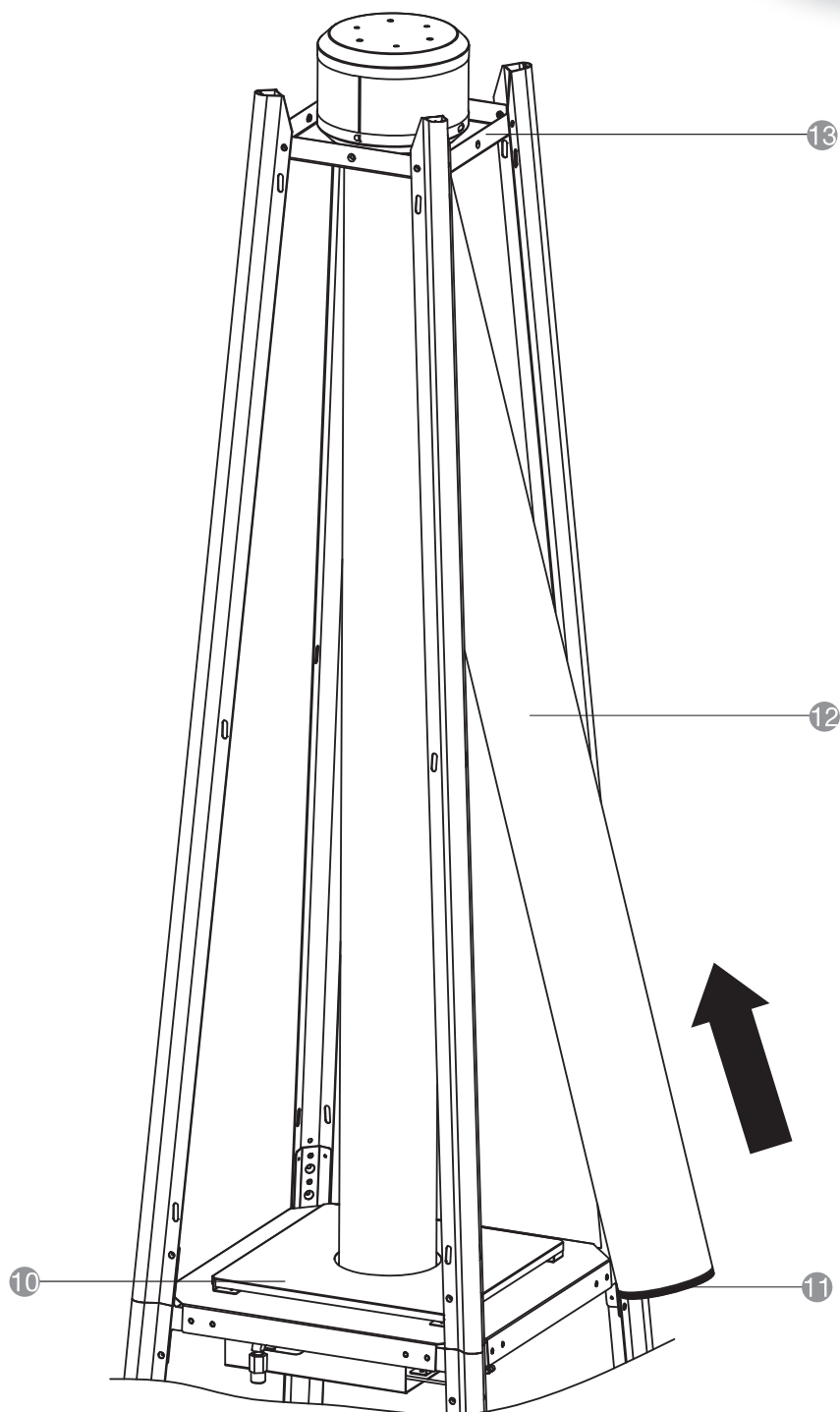
**⚠ 警告**

使用本產品之前，黑色的橡膠環**11**必須安裝在焰管**12**下方的周圍邊框。

將黑色的橡膠環裝設在焰管底部的周圍邊緣。

小心地將焰管向上導入放射器**13**的底部開口以便安裝焰管。請勿對焰管強行施力。將焰管側向推滑就定位，並將其裝設於中間隔板**10**中央的孔洞內。

確認焰管的定位正確，能夠確實地將孔洞填滿。

8

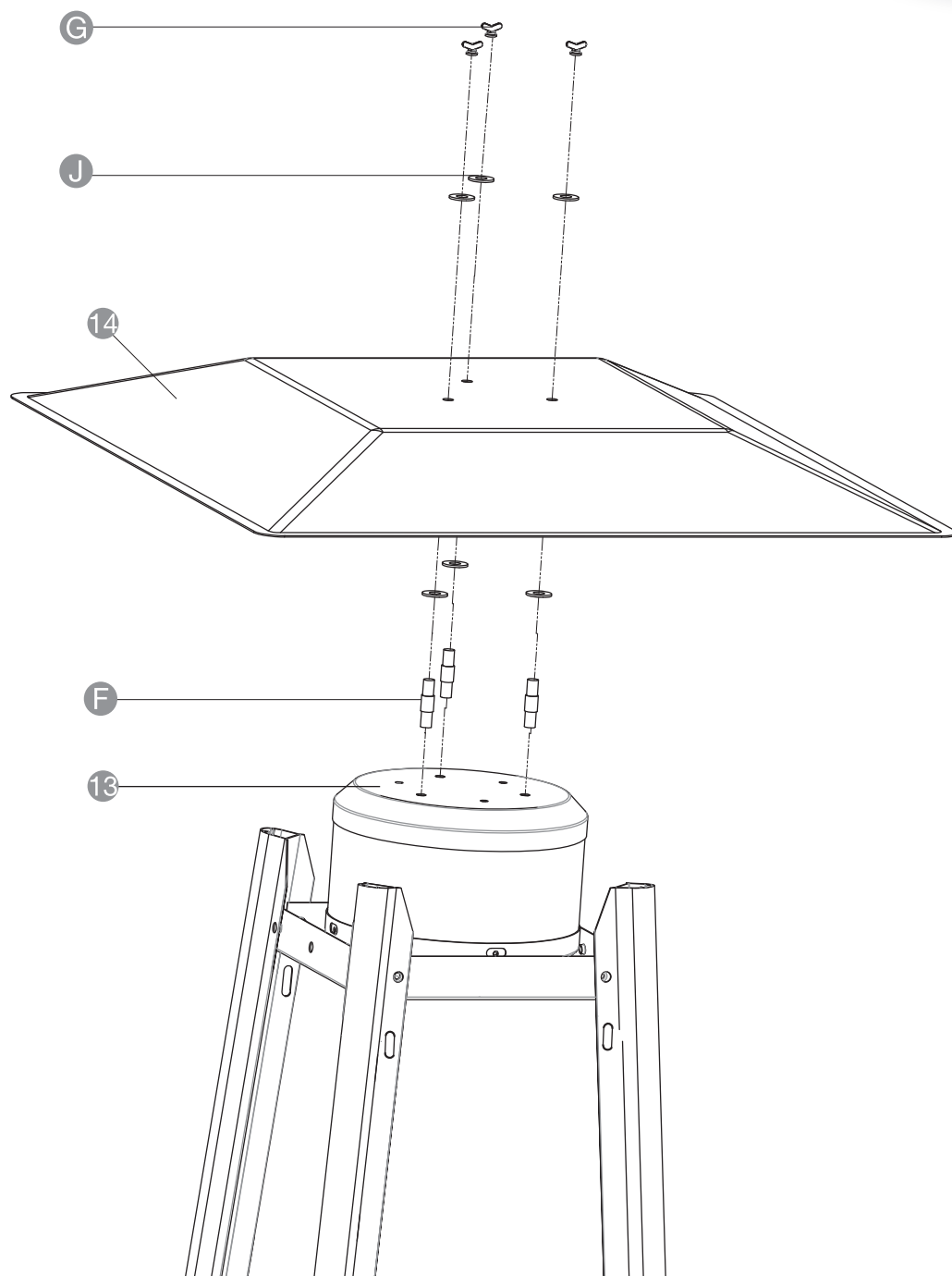

使用的五金零件：雙頭螺栓 **F** x3、墊圈 **J** x6、翼形螺帽 **G** x3

將反光罩**14**安裝於放射器**13**。放射器頂端以3顆雙頭螺栓**F**栓緊，接著在雙頭螺栓上方分別套入3個墊圈**J**。

把反光罩的鑽孔套入雙頭螺栓。

在雙頭螺栓上方分別套入3個墊圈，並以3個翼形螺帽**G**將接合處加以固定。

▲ 注意：步驟8的組裝作業會需要使用梯子。在梯子上作業時應遵守安全注意事項。

9

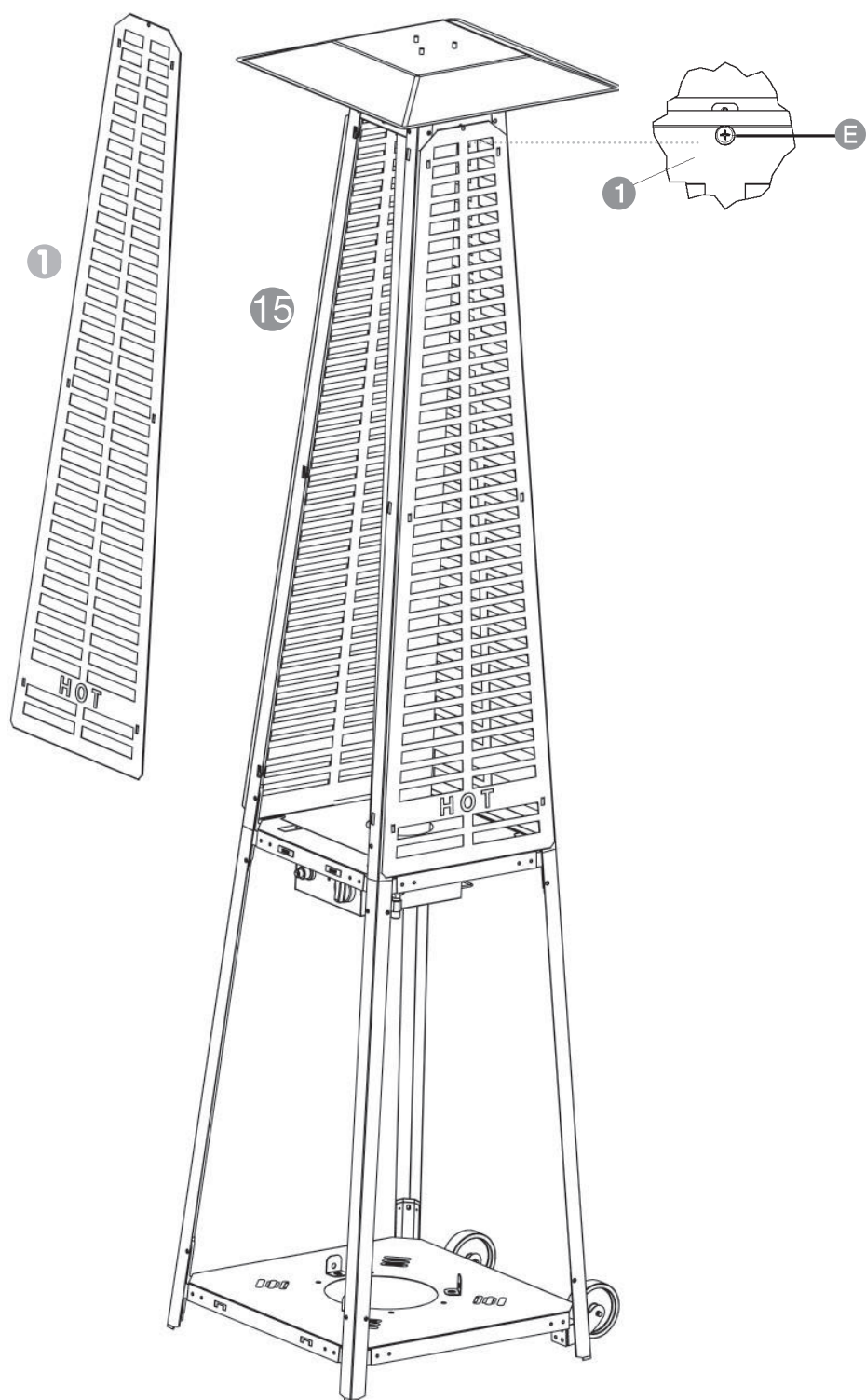

使用的五金零件：螺絲 ③ x4

安裝防護網 ①：

將防護網的鉤子掛上靠近上端支撐杆 ⑮ 頂端、中間及底部的孔洞內。
裝上並鎖緊各個防護網頂端的螺絲 ③ 以固定防護網。

10

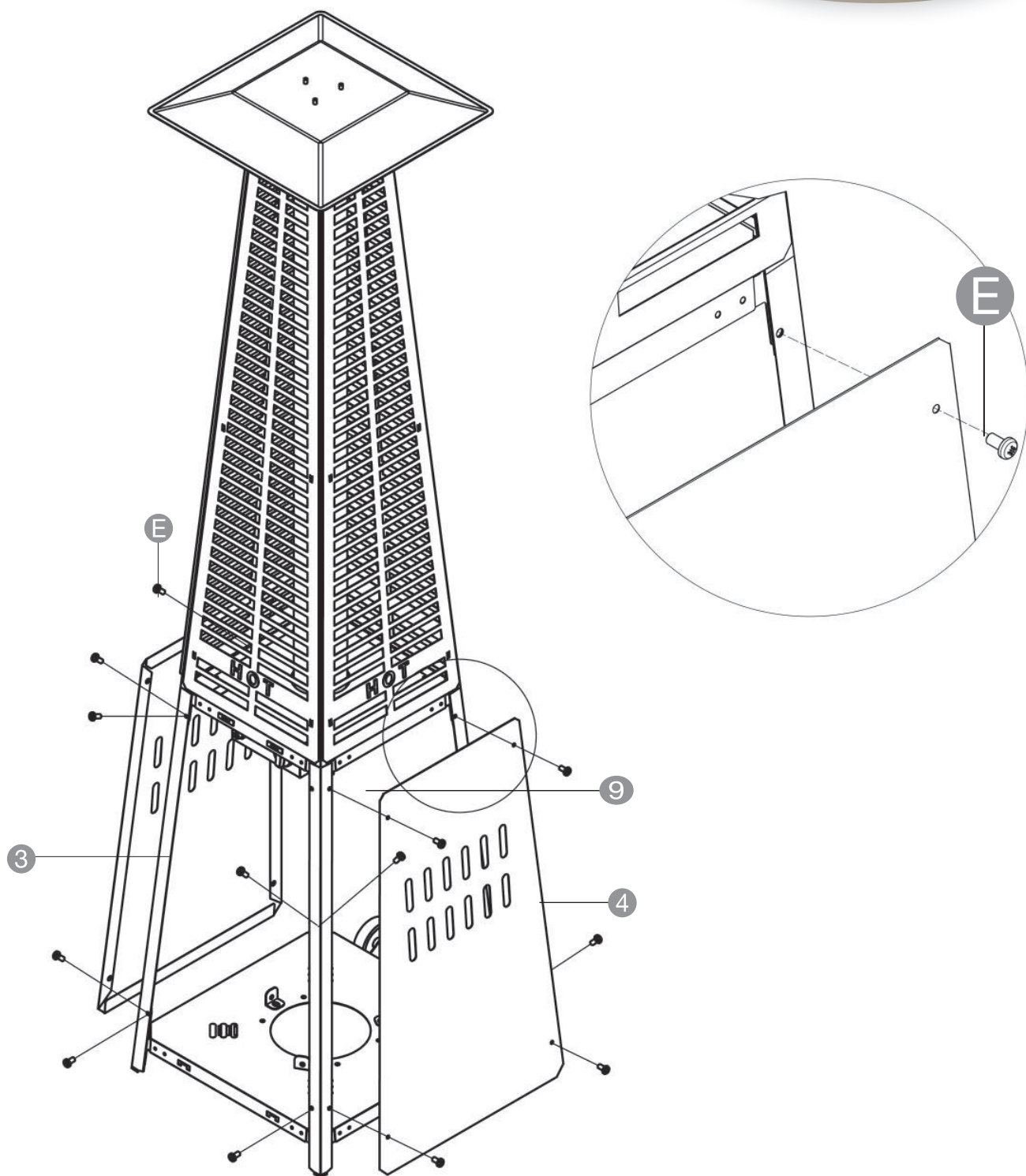

使用的五金零件：螺絲 ③ x16

每片板子使用4顆螺絲③，將側板④及背板⑨與本產品安裝相接。
正面處，直接以4顆螺絲③裝入下端支撐杆③對應的孔洞。

⚠ 注意：請勿將正面封起來（面向控制盒的控制旋鈕那側）

11

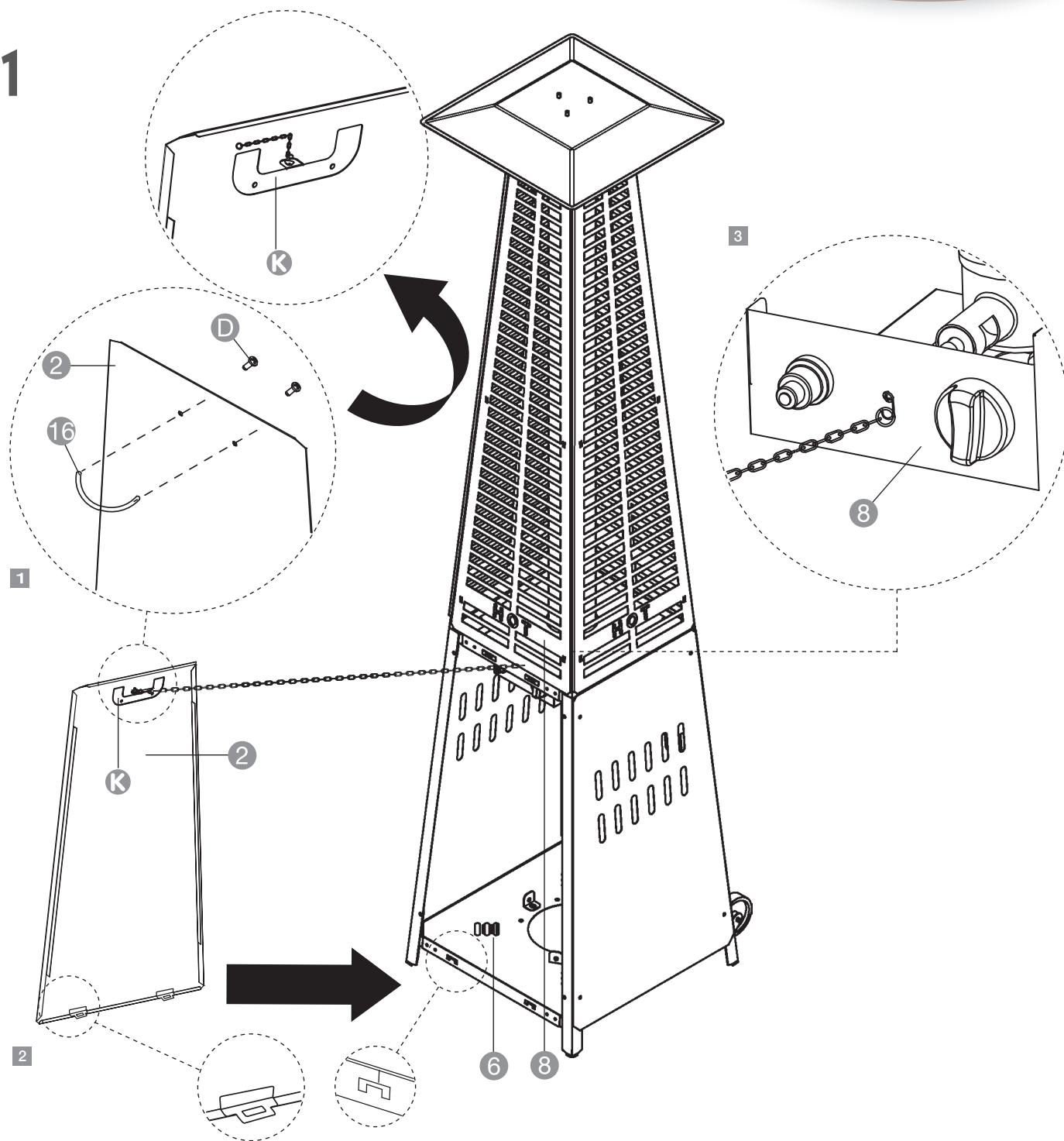

使用的五金零件：螺絲 **D** x2、把手支架 **K**

- 1 將把手**16**安裝在門板**2**外側，並以2顆螺絲**D**將其與門板內側的把手支架**K**固定相接。
- 2 把門板底部的垂片插入底板**6**前方的垂片對接孔內。
- 3 將鉤子上的鏈條裝在控制盒**8**的前方。

12

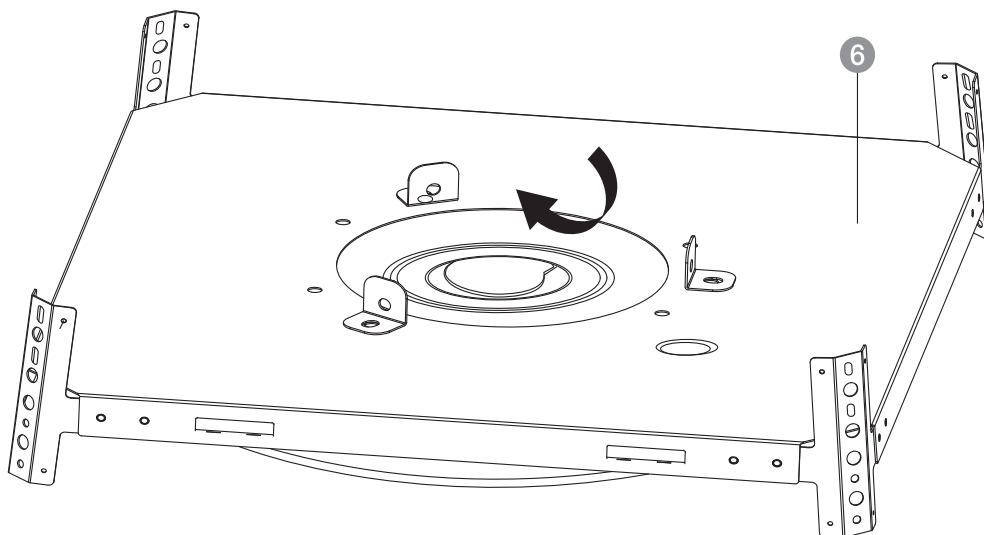

移開門板 ②。

撬開沙箱的塑膠蓋（已預先安裝在底板 ⑥ 下方）。

沙箱內裝入沙或水，接著將塑膠蓋確實地鎖緊。

13

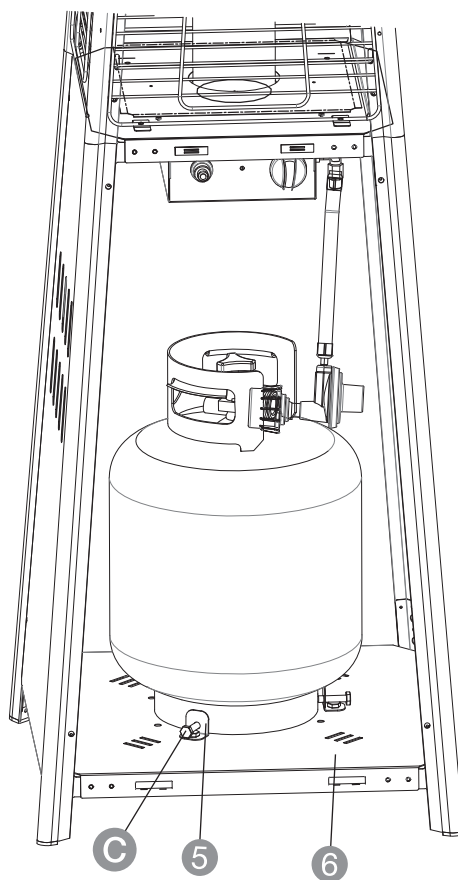

把液化石油氣（以下簡稱LPG）瓦斯桶（本產品未附）放在底板上 ⑥。將瓦斯管的調節器尾端與瓦斯桶（本產品未附）相接。請勿錯扣螺紋。鎖緊3顆長螺栓 ③，以瓦斯桶托座 ⑤ 將瓦斯桶固定。

▲ 注意：只能使用標準的20磅LPG瓦斯桶。

瓦斯桶資訊

- 只能在有裝設LPG揮發氣回收供應裝置時才可使用本產品。
- 只能在拆下瓦斯桶並且與本產品切斷連結後才能將產品收納在室內。瓦斯桶必須存放在戶外通風良好，且為孩童無法接觸到的區域。未連接安裝的瓦斯桶必須以防塵蓋緊密地鎖好，並且不得貯存在建築物、車庫或其他任何的封閉區域內。
- 必須使用本產品所提供的壓力調節器及瓦斯管組件。
- 使用前應先檢查瓦斯管與調節器。
- 使用前檢查調節器的瓦斯管目視可看到的部分。每年至少徹底檢查一次。
- 應更換製造商所指定的瓦斯管和調節器。
- 瓦斯管與調節器必須經UUCSA認證，調節器的輸出壓力必須依據「規格」章節內的表格。指定的零售商處可取得合適的零件。
- 安裝必須符合當地法規
- 凹陷、生鏽或受損的LPG瓦斯桶可能有危害，應該由LPG供應商進行檢查。切勿使用閥接頭已受損的LPG瓦斯桶。
- 瓦斯管的長度不能超過140公分（4.6英呎）。
- 瓦斯桶必須有登記載列的預防填充過量裝置。
- 瓦斯桶必須有能與本產品相容的連接裝置。
- 瓦斯桶必須包含可保護瓦斯桶閥的護圈。
- 本產品切勿連接未調節的LPG瓦斯桶。
- 請勿將備用的LPG瓦斯桶貯存在本產品下方或是靠近本產品。
- 瓦斯桶填充不得超過總容量的80%。
- 每當不使用瓦斯桶時，應在瓦斯桶閥出口放置防塵蓋。瓦斯桶閥安裝的防塵蓋，只能是與瓦斯桶閥提供的防塵蓋相同種類。其他種類的防塵蓋或塞子可能會導致LPG洩漏。

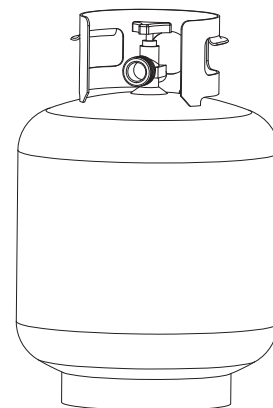

操作 安裝電池

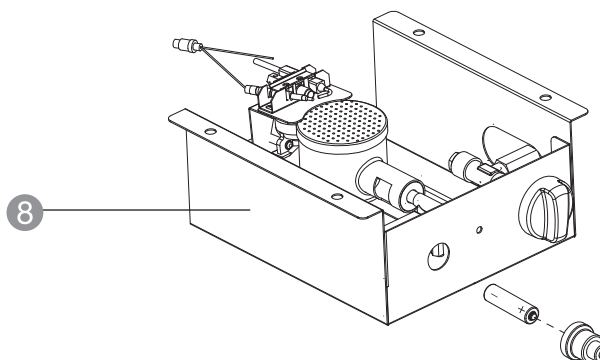

- 鬆開控制盒 ⑧ 上的點火開關按鈕。以正極 (+) 尾端面向外的方向，安裝1顆三號 (AA) 電池 (本產品未附)。將點火開關按鈕重新鎖上歸位。

▲ **注意：**務必以電池及產品上標示的正確極性 (+ 與 -) 方位安裝電池。

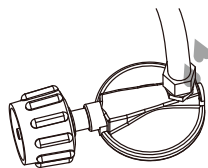
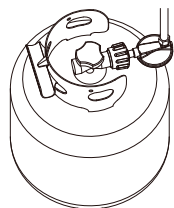
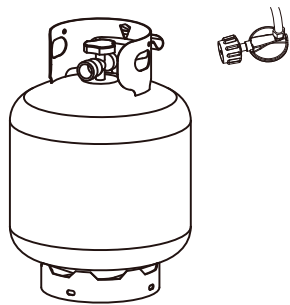

瓦斯管 / 調節器
接頭

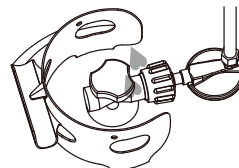

調節器 / 瓦斯桶
接頭

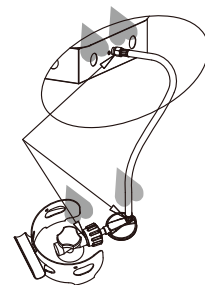

需要最小供應壓力0.5 psi以作為丙烷氣的輸入調節之用。只能在拆下瓦斯桶並且與本產品切斷連結後才能將產品收納在室內。瓦斯桶必須存放在戶外通風良好，且為孩童無法接觸到的區域。未連接安裝的瓦斯桶必須以防塵蓋緊密地鎖好，並且不得貯存在建築物、車庫或其他任何的封閉區域內。最小容許燃氣供應壓力必須要有11 W.C.，以作為調整瓦斯管之用。自動操作的額定值少於全輸入額定值的暖爐，必須要有最少17,500 BTU / h的輸入額定值。

必須使用本產品所提供的壓力調節器及瓦斯管組件。

安裝必須符合當地法規，或無當地法規時，應符合國家燃氣法規、ANSI Z223.1/NFPA54、天然氣及丙烷安裝法規、CSA B149.1，或是丙烷貯存與處置法規，B149.2之規範。

凹陷、生鏽或受損的桶裝瓦斯可能具有危險，應由瓦斯桶供應商進行檢查。切勿使用瓦斯閥接頭已受損的瓦斯桶。桶裝瓦斯必須依美國運輸部 (DOT) 的液化石油瓦斯桶規格，或是遵照作為危險物品運輸及委任製作的瓦斯桶、圓桶和瓦斯管的加拿大標準規範，CSA-B339，予以建構及標示。

- 瓦斯桶必須有登記載列的預防填充過量裝置。
- 瓦斯桶必須有能與本產品相容的連接裝置。
- 使用的瓦斯桶必須包含可保護瓦斯桶閥的護圈。
- 本產品切勿連接未調節的桶裝瓦斯。

- 請勿將備用的液化石油氣瓦斯桶貯存在本產品下方或是靠近本產品。
- 填充瓦斯桶時，切勿超過總容量的百分之80。
- 每當不使用瓦斯桶時，應在瓦斯桶閥出口放置防塵蓋。瓦斯桶閥安裝的防塵蓋，只能是與瓦斯桶閥提供的防塵蓋相同種類。其他種類的防塵蓋或塞子可能會導致丙烷洩漏。



警告：

- 所有洩漏檢測應在戶外執行。
- 熄滅所有露焰。
- 在執行洩漏檢測時切勿抽菸。
- 請勿使用本產品直到所有的接點皆已檢測完畢且無洩漏的跡象。

洩漏檢測：

1. 製作2-3盎司的洩漏檢測液（液態洗碗清潔劑與水的比例1:3）。
2. 滴幾滴溶液在瓦斯管與調節器的接合處。
3. 滴幾滴溶液在調節器與瓦斯桶的接合處。
4. 確認所有的戶外用暖爐閥皆已關閉。
5. 開啟瓦斯桶閥。

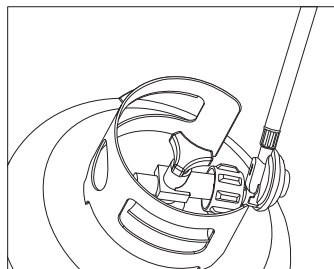
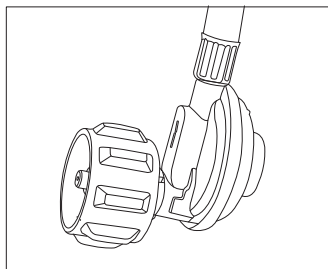

若有任何接點出現氣泡，便表示該處有洩漏。

1. 關閉瓦斯桶閥。
2. 若在瓦斯管 / 調節器的接頭處檢測出洩漏，將接頭鎖緊後，再次執行洩漏檢測。若氣泡仍持續出現，請撥打我們的客服熱線：(866) 985-7877，來電請於上午9點至下午9點（東岸標準時間）。
3. 若洩漏出現在調節器 / 瓦斯桶閥的接頭處，應將接頭拆下、重新安裝並再次執行洩漏檢測。若在多次嘗試後仍持續看到氣泡，則代表瓦斯桶閥已出現瑕疵。請撥我們的客服熱線：(866) 985-7877，來電請於上午9點至下午9點（東岸標準時間）。

若所有接點皆未出現氣泡，則代表接合安全無虞。

附註：每次瓦斯接頭鬆脫或拆卸時，必須執行一次完整的洩漏檢測。

在開啟瓦斯供應之前：

1. 本產品設計並許可僅供戶外使用。請勿在建築物、車庫或其他任何的封閉區域內使用。
2. 確保周圍區域並無可燃材料、汽油以及其他易燃的揮發氣或液體。
3. 確認空氣流通並未受阻。確保所有瓦斯接點皆已鎖緊固定且無洩漏。
4. 確保瓦斯桶蓋並無碎屑。確保所有在組裝或維修時移除的配件在啟動之前已歸位並鎖緊固定。

點火之前：

1. 本產品在每次使用前都應進行徹底地檢查，且至少每年需由合格的維修服務人員進行檢查。若要將熱燙的暖爐重新點火時，務必至少等待5分鐘後再點火。
2. 檢查瓦斯管組件是否有過度耗損、切割或是磨損的跡象。可疑區域應進行洩漏檢測。若瓦斯管出現洩漏，必須在使用之前進行更換。只能使用製造商指定使用的替換瓦斯管組件。



警告：

僅供戶外使用



一氧化碳危害

本產品會產生無味的一氧化碳。在密閉空間內使用本產品會導致死亡。切勿在諸如露營車、帳篷或家裡等密閉空間內使用本產品。

小心：請勿試圖操作本產品，除非您已閱讀並理解本手冊所有的安全事項，並完成所有組裝且已執行洩漏檢測。

點火操作說明：

附註：首次啟動或是在更換瓦斯桶之後，壓下控制旋鈕2分鐘以便在繼續進行之前將瓦斯管線內的空氣排出。

1. 確認控制旋鈕位於OFF（關閉）位置。慢慢地打開LPG瓦斯桶閥。
2. 壓下控制旋鈕並轉至**PILOT**（引火）位置（逆時針轉動）。在壓下控制旋鈕的同時，按壓紅色點火器按鈕。您應該會聽到電子點火器發火花 / 咔嗒的聲響。
3. 持續壓著控制旋鈕並透過玻璃管檢查是否有出現引火焰。若引火焰並未點燃，將控制旋鈕以順時針方向轉至**OFF**（關閉）位置。重複步驟2-3。



圖1



圖2

4. 一旦引火焰點燃後，放開控制旋鈕並以順時針方向轉至**HIGH**（高溫）或是想要的熱度。
5. 關閉暖爐時，將控制旋鈕以順時針方向轉至**PILOT**（引火）位置。壓下控制旋鈕並以順時針方向轉至**OFF**（關閉）位置。不使用產品時應關閉LPG瓦斯桶閥。

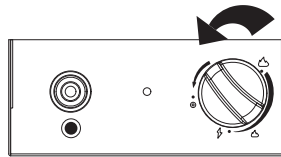

圖3

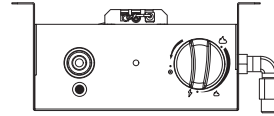

圖4

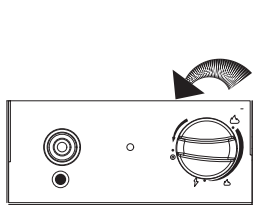

圖5

注意 若引火焰無法持續點燃，應關閉所有旋鈕並至少等待5分鐘的時間，再嘗試點火。

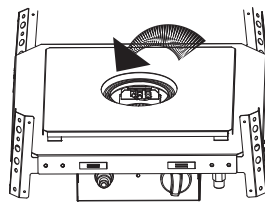
小心 避免吸入本產品首次使用時所排出的煙霧。製造時所使用的油類在燃燒時會出現煙霧及異味。煙霧及異味會在大約30分鐘後消散。本產品不應產生濃厚的黑煙。

注意 燃燒器可能會在首次啟動時發出噪音。為能消除燃燒器所發出的過度噪音，可將控制旋鈕轉至**PILOT**（引火）位置。接著，轉動旋鈕至想要的熱度。

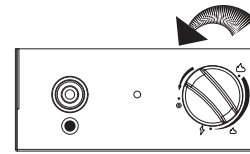
注意 正常狀況下，**HIGH**（高溫）設定的火焰高度大約會在焰管2/3的高度位置，而**LOW**（低溫）設定的火焰高度大約會在焰管1/3的高度位置。火焰應該是穩定且明亮，並且不會產生具干擾程度的噪音或是產生煙霧。若發現出現噪音或是煙霧，則代表操作異常。

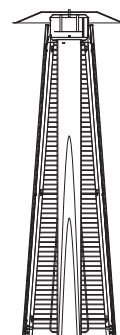

正常火焰

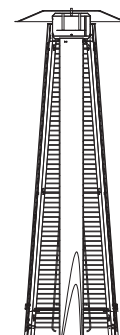

異常火焰

警告 受傷的危險！嘗試以手動方式點燃本產品時請小心。點燃瓦斯之前持續壓著控制旋鈕10秒以上，會在點火時出現火焰球。



操作檢核表：

為能有一個安全及愉快的使用體驗，請在每次使用前執行本檢查作業。

操作前：

- 已熟悉使用手冊的全數內容並了解所有注意事項。
- 所有配件已確實地組裝完成、無缺損並可操作。
- 並未進行改裝。
- 所有瓦斯接點皆已固定且無洩漏。
- 風速低於10 mph。
- 本產品為戶外（所有封閉空間之外）使用。
- 有足夠新鮮的空氣流通。
- 本產品遠離汽油或其他易燃液體或揮發氣。
- 本產品遠離窗戶、進氣口、灑水器和其他水源。
- 本產品與可燃材料之間的架空與周圍間隙應至少保持3.3英呎 / 40英吋 / 1公尺。
- 本產品應擺放在堅硬且平穩的表面。
- 暖爐的孔口並無蜘蛛或昆蟲巢穴的蹤跡。
- 燃燒器的所有通道皆保持乾淨。
- 所有空氣循環通道皆保持乾淨。
- 不應將衣物或其他保護用材料吊掛在本產品或是放置其上或是靠近本產品。
- 本產品因維修而移除的任何防護或其他保護設備，必須在操作本產品之前重新安裝歸位。
- 安裝及維修作業應由合格的維修服務人員執行。
- 本產品應在使用前及至少每年由合格的維修服務人員進行檢查。

操作事項與安全

- 裝置在低於5°C (40°F) 的溫度下操作時，效率會降低。
- 警告孩童及成人表面高溫的危險，並應遠離以避免燒傷或衣物被點燃。
- 幼童若在本產品的周圍區域時，應予以仔細地看顧。
- 可視需要更為頻繁地清理本產品。本產品的操控室、燃燒器以及空氣循環通道予以維持清潔並且無殘渣以及 / 或是蜘蛛或昆蟲巢穴是極為重要的。

重新點火：



為了您的安全，控制旋鈕無法直接關閉，而是必須先壓入PILOT（引火）位置，接著再轉至OFF（關閉）位置。

1. 轉動控制旋鈕至OFF（關閉）位置。等待至少5分鐘的時間，讓瓦斯消散。
2. 重複上一頁「點火操作說明」中的步驟。



使用時：

火焰大部分應是帶著藍色及黃色。若發現過大的火焰或煙霧時，應關閉暖爐並查詢本手冊的「故障排除」段落。



警告

為了您的安全
本產品使用後會變燙。操作時
請格外留意。



關閉：

1. 將控制旋鈕以順時針方向轉至OFF（關閉）位置。（一般而言，燃燒器在熄滅時會發出輕微的爆裂聲。）
2. 將瓦斯桶閥以順時針方向轉至OFF（關閉），並在不使用暖爐時拆下調節器。

附註：使用後，放射網篩會有一些變色是正常現象。



使用後：

1. 將瓦斯的控制旋鈕轉至OFF（關閉）位置。
2. 瓦斯桶閥轉至OFF（關閉）。
3. 拆卸瓦斯管。
4. 將暖爐以直立的方式收納於安全的位置。

為能使本產品長年擁有出色的性能表現，應確保定期執行以下的保養作業：

保持外部表面清潔。

1. 使用肥皂水進行清理作業。切勿使用易燃或具腐蝕性的清潔劑。
2. 在清理本產品時，隨時確保燃燒器與操控室的周圍區域保持乾燥。請勿將控制閥裝配件浸入水裡。若瓦斯控制器浸入水裡，請勿使用。應予以更換。
3. 空氣流動不得受阻。請保持控制器、燃燒器及空氣循環通道乾淨。阻塞可能的徵兆包括：
 4. 有瓦斯味且頂端的火焰特別黃。
 5. 暖爐無法達到想要的溫度。
 6. 發光極為不均勻
 7. 暖爐發出爆裂聲。
8. 蜘蛛及昆蟲會在燃燒器或孔口內築巢。此危險狀況會使本產品受損，並造成使用上的危險。使用強力清管劑清理燃燒器孔洞。壓縮空氣可協助將較小的微粒清除乾淨。
9. 積碳會引發火災的危險。若有任何積碳形成，應以溫肥皂水清潔圓頂以及燃燒器的網篩。

附註：在空氣中含鹽的環境（例如靠近海邊的地方），腐蝕的狀況會比一般環境更快發生。經常檢查是否有受到腐蝕的區域，並馬上進行維修。



不鏽鋼型號產品的提示：

使用優質的汽車蠟，有助於保養本產品的外觀。由支撐杆的外部表面向下塗抹。請勿塗抹在放射網篩或是圓頂上。

警告

為了您的安全

- 使用後，至少再過45分鐘再觸摸或移動本產品。
- 反光罩很燙，不得觸摸。
- 等反光罩冷卻後再接觸。

收納： 使用間：

- 將控制旋鈕轉至OFF（關閉）。
- 斷開液化石油油的來源。
- 將本產品直立收納在有遮蔽可避免直接與惡劣氣候（例如雨水、霰、冰雹、雪、灰塵及碎屑）接觸的區域。
- 若有需要，將本產品加以遮蓋以保護外部表面並有助於避免通風道堆積異物。切勿將LPG瓦斯桶直接暴露於陽光下或過多的熱量。

附註：等到本產品完全冷卻後再予以遮蓋。

維修作業：

只能由合格的維修服務人員修理瓦斯通路及關聯的組件。

小心：務必讓本產品冷卻後再嘗試進行維修保養。

問題	造成問題的可能因素	矯正措施
主燃燒器無法點燃 	瓦斯閥可能未開啟	打開瓦斯桶閥
	瓦斯桶內的瓦斯已用完	重新填充LPG瓦斯桶
	孔口阻塞	清潔或更換孔口
	供應系統內有空氣	將瓦斯管線內的空氣排出。展開瓦斯管線並壓下控制旋鈕2-3分鐘
	接頭鬆脫	檢查所有接頭配件
	點火器故障	檢查點火器後方的點火器電纜接線
	瓦斯桶閥全開時氣體壓力不足	更換瓦斯桶或是調節器
	新的瓦斯桶或是首次點燃使用	將瓦斯管線內的空氣排出
	瓦斯桶閥開啟時，無瓦斯流量	更換瓦斯管 / 調節器組件
	電池沒電	更換點火器按鈕後方的三號 (AA) 電池
燃燒器的火焰不足	氣壓過低	更換LPG瓦斯桶
	瓦斯桶燃料不足	填充LPG瓦斯桶
	瓦斯管絞纏在一起	進行檢查並將瓦斯管拉直或是予以更換
燃燒器裝置	反光罩及放射網篩上積碳	視需要清理零組件
	厚厚的黑煙	燃燒器組件阻塞-徹底清理燃燒器