

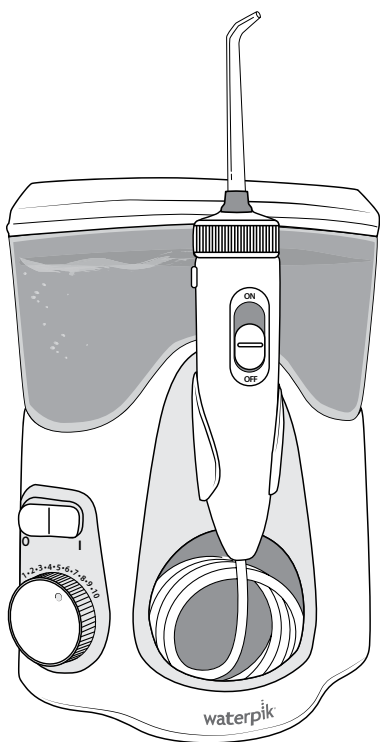

Waterpik® Water Flosser Model WP-150 Series

Waterpik® 沖牙機
型號 WP-150



.....
www.waterpik.com

20030488-FAA_WP-150EC_Traditional_IM_r4.indd 1

4/29/21 9:05 AM

samcooper**design**

DO NOT PRINT

DATE: 04.26.2021
CLIENT: WATERPIK

FILENAME: 20030488-FAA_WP150EC_Traditional_IM_r4.indd
DESCRIPTION: WP-150 Instruction Manual
LANGUAGES: 2 [Eng, Traditional Chinese]
FILE TYPE: Adobe InDesign CC
SCD JOB# / PREPARED BY: 21WPOH6841 / AM
CLIENT ROUND: r4

SCALE: 100%
UPC: N/A
SIZE: 10" x 7" flat; 5" x 7" folded
FORM NUMBER: 20030488-F AA
INK: Process Black
NOTES:

IMPORTANT SAFEGUARDS

- For household use only.

When using electrical products, especially when children are present, basic safety precautions should always be followed, including the following:

READ ALL INSTRUCTIONS BEFORE USING.

DANGER:

To reduce the risk of electrocution:

- Always unplug product after using.
- Do not handle plug with wet hands.
- Do not place in or drop into water or other liquid.
- Do not use while bathing.
- Do not place or store product where it can fall or be pulled into a tub or sink.
- Do not reach for a product that has fallen into water. Unplug immediately.
- Check the power supply cord for damage before the first use and during the life of the product.
- The supply cord cannot be replaced. If the cord is damaged, the appliance should be scrapped.

WARNING:

To reduce the risk of burns, electrocution, fire, or injury to persons:

- Do not plug this device into a voltage system that is different from the voltage system specified on the device or charger.
- Do not use this product if it has a damaged cord or plug, if it is not working properly, if it has been dropped or damaged, or dropped into water. Contact Water Pik, Inc. at www.waterpik.com or InternationalService@waterpik.com
- Do not direct water under the tongue, into the ear, nose or other delicate areas. This product is capable of producing pressures that may cause serious damage in these areas.
- Use this product only as indicated in these instructions or as recommended by your dental professional.
- Only use flossing brush heads and accessories recommended by Water Pik, Inc.
- Do not drop or insert any foreign object into any opening or hose.

- Keep electrical cord away from heated surfaces.
- Do not use outdoors or operate where aerosol (spray) products are being used or where oxygen is being administered.
- Do not use iodine or water insoluble concentrated essential oils in this product. Use of these can reduce performance and will shorten the life of the product. Use of these products may void warranty.
- Fill reservoir with water or other dental professional recommended solutions only.
- Remove any oral jewelry prior to use of this product.
- Do not use if you have an open wound on your tongue or in your mouth.
- If your physician or cardiologist has advised you to receive antibiotic premedication before dental procedures, you should consult your dentist and/or medical professional before using this product or any other oral hygiene aid.
- Close supervision is necessary when this product is used by, on or near children or invalids.
- If the Pik Pocket™ tip (not included in all models) separates from the shaft for any reason, discard tip and shaft and replace with new Pik Pocket™ tip.
- Do not use this product for more than 5 minutes in each two-hour period.
- This appliance has a polarized plug (one blade is wider than the other). As a safety feature, this plug is intended to fit into a polarized outlet only one way. If the plug does not fit fully into the outlet, reverse the plug. If it still does not fit, contact a qualified electrician. Do not attempt to modify the plug in any way.
- This appliance is not intended for use by persons (including children) with reduced physical, sensory or mental capabilities, or lack of experience and knowledge, unless they have been given supervision or instruction concerning the use of the appliance by a person responsible for their safety.
- Children should be supervised to ensure that they do not play with the appliance.

SAVE THESE INSTRUCTIONS

Product Description	5
Getting Started	6
Cleaning and Troubleshooting Your Waterpik® Water Flosser	8
Limited Three-Year Warranty	9

- 1. Reservoir cover w/ tip storage
- 2. Tip eject button
- 3. Reservoir valve
- 4. Power ON/OFF
- 5. Pressure control dial
- 6. Tip
- 7. Rotating direction control knob
- 8. Reservoir
- 9. Water ON/OFF switch
- 10. Handle
- 11. Base

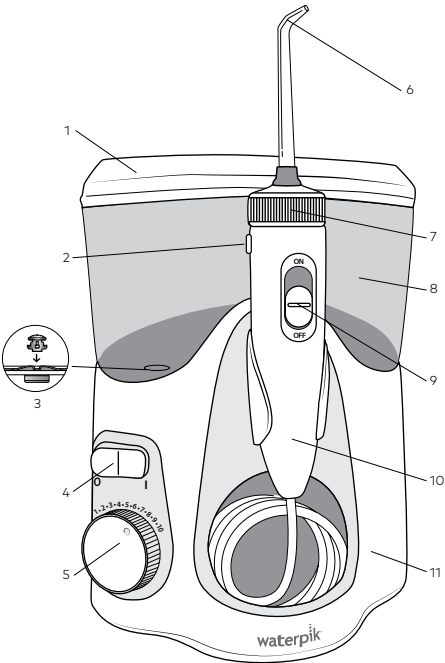

TIPS

- A. Orthodontic Tip***
- Braces/General Use
- B. Pik Pocket™ Tip***
- Periodontal Pockets/
Furcations
- C. Plaque Seeker™ Tip***
- Implants/Crowns/Bridges/
Retainers/General Use
- D. Toothbrush Tip***
- General Use
- E. Classic Jet Tip****
- General Use
- F. Tongue Cleaner****
- Fresher Breath

NOT ALL TIPS INCLUDED IN ALL MODELS

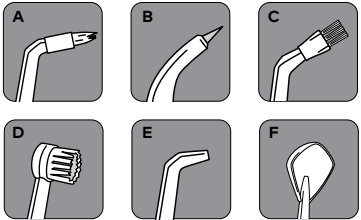

**Replace Every 3 months **Replace Every 6 months*
To find detailed information about tips, other accessories, and product usage please visit our website at www.waterpik.com or email at InternationalService@waterpik.com.

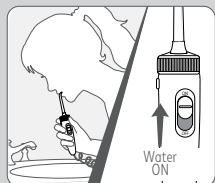
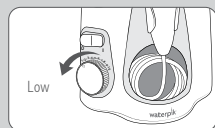
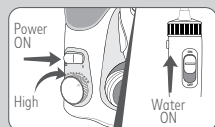
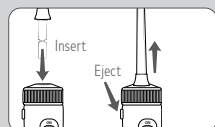
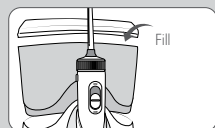

Powering the Unit

Plug the cord into an electrical outlet. If the outlet is controlled by a wall switch, be sure it is turned on.

Preparing the Reservoir

Remove the reservoir and lid from the base. Fill the reservoir with warm water. Return the reservoir to the base and press down firmly.

Inserting and Removing Tips

Insert tip into the center of the Water Flosser handle, pressing down firmly until the tip clicks into place. The colored ring will be flush with the top of the handle if the tip is correctly locked into place. To remove tip from the handle push the tip eject button on the handle.

Prime Unit (First Time Use Only)

Set pressure control dial on base to high (pressure setting No.10), point the handle and tip into sink. Turn power and water ON until water flows from the tip. Turn unit OFF.

Adjusting the Pressure Setting

Turn the pressure control dial on the base of the unit to the lowest setting (pressure setting No.1) for first-time use. Gradually increase pressure over time to the setting you prefer – or as instructed by your dental professional.

Using the Water Flosser

Always place the tip in your mouth before turning the water ON. With water switch on handle in OFF position, turn power on.

Lean over sink and slightly close lips enough to prevent splashing while still allowing water to flow from mouth into the sink. Turn water switch ON.

When finished, turn water switch and power OFF. During use you can stop the flow of water by sliding the water switch on handle to the OFF position.

NOTE: Motor will continue to run.

Recommended Technique

For best results, start with back teeth and work toward the front teeth. Direct the stream at a 90-degree angle to your gumline with tip in mouth. Glide tip along gumline and pause briefly between teeth. Continue until you have cleaned the inside and outside of both the upper and lower teeth.

When Finished

Turn the unit off. Empty any liquid left in the reservoir.

NOTE: If you used mouthwash or other solution besides water, see "Using Mouthwash and Other Solutions" section.

NOTE: NOT ALL TIPS INCLUDED WITH ALL MODELS.

TIP USAGE

Pik Pocket™ Tip

The Pik Pocket™ tip is specifically designed to deliver water or anti-bacterial solutions deep into periodontal pockets.

To use the Pik Pocket™ tip, **set the unit to the lowest pressure setting.** Place the soft tip against a tooth at a 45-degree angle and gently place the tip under the gumline, into the pocket.

Orthodontic Tip

To use the orthodontic tip, gently glide tip along gumline, pausing briefly to lightly brush area between teeth and all around orthodontic bracket, before proceeding to the next tooth.

Tongue Cleaner Tip

Set to lowest pressure setting, place tip in the center/middle of your tongue about half way back. Pull forward with light pressure. Increase pressure as you prefer.

Plaque Seeker™ Tip

To use the Plaque Seeker™ tip, place the tip close to the teeth so that the bristles are gently touching the teeth. Gently glide tip along gumline, pausing briefly between teeth to gently brush and allow the water to flow between the teeth.

Toothbrush Tip

Place the toothbrush tip in mouth with the brush head on the tooth at the gumline. The toothbrush tip can be used with or without toothpaste. Using a light pressure (bristles should not bend) massage the brush back and forth with very short strokes – much like you would with a manual toothbrush.

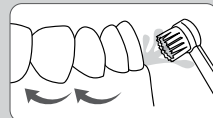
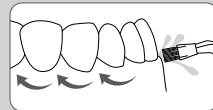
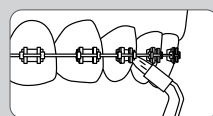
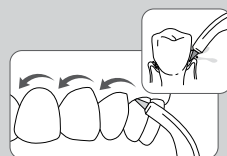

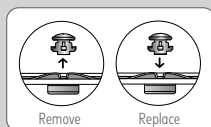

Using Mouthwash and Other Solutions

Your Waterpik® Water Flosser can be used to deliver mouthwash and antibacterial solutions. After using any special solution, rinse unit to prevent clogging by partially filling reservoir with warm water and running unit with tip pointed into sink until unit is empty.

Cleaning

Before cleaning, unplug from the electrical outlet. Clean the product when necessary by using a soft cloth and mild non-abrasive cleanser.

The water reservoir is removable for easy cleaning and is top rack dishwasher safe if temperature does not exceed 140° Fahrenheit (60° Celsius).

It is recommended that the reservoir is removed and cleaned weekly.

NOTE: Remove reservoir valve by pushing up from bottom of reservoir, before placing reservoir in dishwasher.

Removing Hard Water Deposits / General Cleaning

Hard water deposits may build up in your unit, depending on the mineral content of your water. If left unattended, it can hinder performance.

Cleaning internal parts: add 2 tablespoons of white vinegar to a full reservoir of warm water. Point the handle and tip into sink. Turn unit ON and run until reservoir is empty. Rinse by repeating with a full reservoir of clean warm water.

This process should be done every 1 to 3 months to ensure optimal performance.

Leakage

If leaking due to a damaged hose, replacement hoses and handles can be purchased at www.waterpik.com or contact Water Pik Inc. customer service for a self service repair kit at InternationalService@waterpik.com.

If leakage occurs from the reservoir, ensure the valve is right side up or contact Water Pik Inc. customer service for a replacement valve.

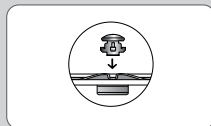

Service Maintenance

Waterpik® Water Flossers have no consumer-serviceable electrical items and do not require routine service maintenance. For all accessories go to www.waterpik.com or contact InternationalService@waterpik.com.

Refer to the serial and model numbers in all correspondence. These numbers are located on the bottom of your unit. Replacement tips can be purchased from www.waterpik.com or by contacting InternationalService@waterpik.com.

Water Pik, Inc. warrants to the original consumer of this new product that it is free from defects in materials and workmanship for 3 years from the date of purchase.

Consumer will be required to submit the original purchase receipt as proof of purchase date and if requested, the entire product, to support a warranty claim. Water Pik, Inc. will replace at its discretion the product, which in its opinion is defective, provided the product has not been abused, misused, altered or damaged after purchase, was used according to instructions, and was used only with accessories or consumable parts approved by Water Pik, Inc. This limited warranty excludes accessories or consumable parts such as tips, etc. **Use with improper voltage will damage product and VOID warranty.**

This warranty gives you specific legal rights. You may also have other rights that vary, depending on the law in your place of residence.

重要安全事項

- 僅限家庭使用。

當使用電氣產品時，尤其有兒童在場時，請務必遵循下列基本的安全防範措施：

請在使用前閱讀所有說明。

危險：

為降低觸電危險，請注意以下事項：

- 用完後務必拔掉產品的電源插頭。
- 切勿用濕手插拔插頭。
- 切勿把產品放入或掉進水或其他液體中。
- 切勿在洗澡時使用。
- 切勿將產品放置或存放於可能掉落或被拉扯入浴盆、盥洗池的位置。
- 如果產品不慎落入水中，切勿伸手去取。而應立即拔掉電源插頭。
- 無論是首次使用本產品之前，還是在本產品的使用期間，應始終注意檢查電源線是否已損壞。
- 電源線無法更換。電源線損壞後，相應設備應需報廢。

警告：

為降低燒傷、觸電、火災或個人生命傷害的風險，請謹記：

- 切勿將本設備連接至本設備或充電器規定之外的電壓系統。
- 如果產品電源線或插頭損壞、或產品工作不正常、或產品被摔、損壞或掉入水中，不要使用它。請聯繫 Water Pik, Inc.：www.waterpik.com 或 InternationalService@waterpik.com
- 切勿將水注入舌下，耳朵，鼻子或其他敏感部位。本產品產生的壓力可能對這些部位造成嚴重傷害。
- 按照本說明書的規定或者您牙醫的建議使用本設備。
- 僅允許使用Waterpik®公司推薦的刷頭和附件。
- 切勿在任何開口或者軟管中放入或插入異物。

- 電線須遠離加熱表面。
- 切勿在戶外、使用氣霧劑（噴霧器）或供氧的場所使用或操作本產品。
- 不要在產品中使用碘或水不溶性濃縮精油。使用它們能降低產品性能並縮短產品壽命。使用這些東西可能會讓保修作廢。
- 用水或牙醫推薦的溶液將水箱注滿。
- 使用本產品前摘除所有牙飾。
- 如若口腔或舌頭有傷口，請勿使用。
- 如果醫師或心臟病專家建議您在治療前服用抗生素，應在使用本儀器前或其他任何口腔衛生輔助設備之前，向您的牙醫諮詢。
- 兒童或傷殘人士操作，使用或在其附近使用本產品時，應予以密切監督。
- 如果Pik Pocket深層/牙周噴頭（並非所有的型號均包含此噴頭）由於任何原因與手柄分開，請丟掉該噴頭和手柄，更換新的Pik Pocket深層/牙周噴頭。

- 在每兩個小時之內，使用本產品的時間不得超過5分鐘。
- 本設備附有一個極性插頭（其中一個插頭片比另外一個大）。作為一種安全裝置，這種插頭被設計成只能以一個方向插入極性插座。如果插頭不能完全插入插座，請翻轉插頭。如果仍然不合適，請聯繫合格的電工。切勿試圖以任何方式改裝插頭。
- 本設備不得用於身體、感官或心理能力較弱或缺乏經驗和知識的個人（包括兒童），除非有負責其安全的人員給予有關使用本設備的監護和指導。
- 請避免兒童玩弄本設備。

務必謹記上述說明。

產品說明	13
使用前的準備事宜	14
Waterpik® 沖牙機的清洗和故障排除	16
三年有限保固	17

- 1. 帶噴頭存放處的水箱蓋
- 2. 刷頭彈出按鈕
- 3. 水箱閥門
- 4. 電動開關（電機）
- 5. 壓力控制盤
- 6. 噴/刷頭
- 7. 旋轉方向控制旋鈕
- 8. 水箱
- 9. 水開/關閉開關
- 10. 手柄
- 11. 底座

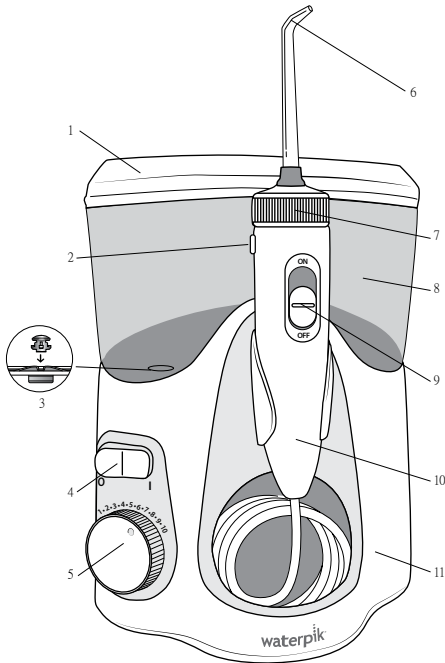

噴/刷頭

- A. 矯正噴頭*
 - 牙箍
 - 一般用途
- B. Pik Pocket 深層/牙周噴頭*
 - 牙周/牙根分叉
- C. Plaque Seeker 牙菌斑噴刷頭*
 - 植牙/
 - 齒冠
 - 牙橋
 - 一般用途
- D. 牙刷頭*
 - 一般用途
- E. 標準噴頭**
 - 一般用途
- F. 舌苔清洗噴頭**
 - 清潔口腔

並非所有的型號均包含所有類型的刷頭。

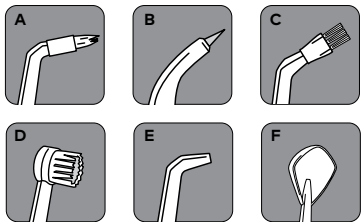

*每3個月進行更換 **每6個月進行更換
有關刷頭、其他配件和產品使用的詳細資訊，請訪問我們的網站www.waterpik.com，或寄送電郵至 InternationalService@waterpik.com。

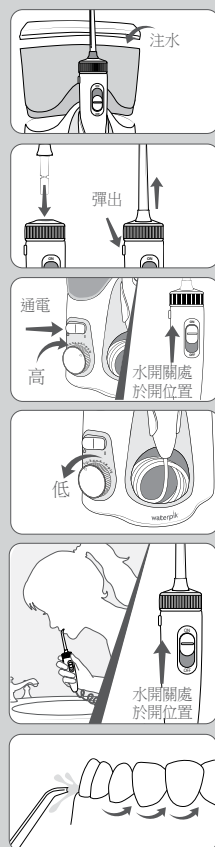

給裝置通電

將電源線插入電源插座。如果電源插座由牆壁開關控制，確保已開啟該牆壁開關。

準備

準備水箱 從底座上取下水箱和水箱蓋。向水箱內注 入溫水。把水箱放回底座，並按壓牢固。

噴/刷頭的插入與移除

將噴/刷頭插入沖牙機手柄的中心，用力向下按，直到噴/刷頭卡入到位。如果噴/刷頭正確定位，有色圓環應與手柄的頂端對齊。要從手柄上取下噴/刷頭，按壓噴頭彈出按鈕即可。

注水裝置（僅供首次使用）

把底座上的壓力操控盤調整到高（10號壓力設置），把手柄和噴頭指向盥洗池。打開電源直到水從噴頭中流出。關閉電器。

壓力調整

首次使用時，旋轉裝置 底座上的壓力控制盤至最低壓力（1號壓力水準）。逐漸增加壓力 到你想要的壓力或牙 醫推薦的壓力。

如何使用Waterpik®沖牙機

每次使用時，在把 水開關滑動至開 位置前，要把噴頭始放在嘴中。在手柄上的水開關位關位置時，啟動裝置。把身體俯在盥洗池上方，閉上嘴巴以避免水流濺射，但要留有一定縫隙 以便讓水持續從嘴中流到盥洗池。滑動水開關至開位置。當清洗結束後，滑動水開關 至關位置，並關閉電源。在使用中，通過滑動手柄上的水開關至關位置可隨時停止水流。注意：電機仍在運轉。

推薦技巧

為獲得最佳效果，從後牙開始朝門牙方向清洗。把噴頭放在口中，使噴射流與牙齦線呈90度角的方向。將噴頭沿牙齦線移動，並在齒間短暫停留。繼續清洗，直到上齒和下齒的內外側都清洗乾淨。

清洗完成後

關閉設備。倒掉殘留在水箱中的所有液體。拔掉設備的電源插頭。

注意：如果除了水之外您還使用漱口水或其他溶液，請參考「使用漱口水和其他溶液」部分。

注意：並非所有的型號均包含所有類型的刷頭。

噴/刷頭的用法

Pik Pocket 深層/牙周噴頭

Pik Pocket 深層/牙周噴頭專為將水或抗菌溶液輸送至深層牙周袋而設計。

使用PikPocket深層/牙周噴頭時，請務必將產品設置為最小壓力值。將柔性 噴頭正對牙齦線呈45度角靠在一顆牙 上，輕緩地移動噴頭直至其置於牙齦偏下位置，進入牙周袋內。開啟設備，沿牙齦 線滑動清洗。

矯正噴頭

使用矯正噴頭時，沿著牙齦線輕輕滑動噴頭，在齒間和矯正托槽周圍所有部位短暫停留並輕刷，然後滑動噴頭清洗下一顆牙齒。

舌苔清洗噴頭

使用舌苔清洗噴頭時，請將壓力設置為最小值。將刷頭放在舌前後部等距的中央/中線位置，然後開啟沖牙機。從低壓開始向前推動。根據您的喜好增加壓力。

Plaque Seeker 牙菌斑噴刷頭

使用Plaque Seeker 牙菌斑噴刷頭時，將刷頭貼近牙齒使得刷毛能夠輕觸牙齒。沿著牙齦線輕柔地滑動刷頭，在牙縫處稍作停留並輕輕地刷動，讓水流經牙縫。

牙刷頭

將牙刷頭置於口腔內，並在牙齦線處將刷頭對準牙齒。牙刷頭可與牙膏配合 使用，也可不使用牙膏。開啟沖牙機，讓水流通過刷頭。用低壓力（不應彎曲刷毛）並以極小的幅度來回刷動牙刷頭——就像使用傳統的牙刷一般。

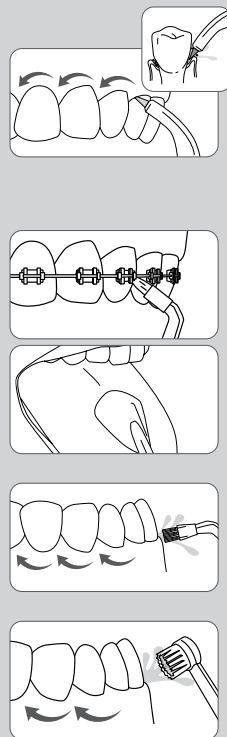

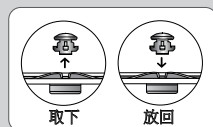

使用漱口液和其他溶液

Waterpik® 冲牙機可以用來輸送漱口液和抗菌溶液。在水箱中使用任何特殊溶液後，應沖洗產品以防堵塞。沖洗方法為：在水箱中注入部分溫水，然後將噴/刷頭對準盥洗池，開啟設備並運轉直至排空水箱為止。

清洗

在清洗產品之前，請先從電源插座上拔掉電源線。如有需要，用一塊軟布蘸溫和的非磨蝕性清潔劑來清洗產品。

水箱可取下以方便清洗。也可把水箱放在洗碗機頂層架上清洗，只要溫度不超過華氏140°（攝氏60°）。

建議每週把水箱取下進行清洗。

注意：在將水箱放入洗碗機之前，請移除水箱閥門。

清除硬水沉積/一般清潔

硬水沉積物可能會在您的電器上積累，這取決於水中的礦物質含量。如果對此不管，會降低電器的性能表現。

清潔內部零件：將水箱灌滿溫水，並加入2湯匙白醋。把手柄和噴頭指向盥洗池內。打開電器，讓其運行，直到水箱變空。再向水箱加滿乾淨溫水，重複上述操作來進行沖洗。

應每隔1至3個月重複該操作，以確保最佳性能。

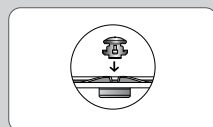

洩漏

如因軟管損壞導致洩漏，可訪問 www.waterpik.com 購買替換的軟管和手柄，或聯繫 Water Pik Inc. 服務尋求自助維修套件：InternationalService@waterpik.com。如果水箱發生洩漏，請確保水箱閥門是正面朝上的，亦可聯繫 Waterpik® 公司客戶服務部獲取更換用的新閥門。

維護服務

Waterpik® 冲牙機不含任何需用戶維護的電氣零件，且無需例行維護操作。所有備件均可訪問 www.waterpik.com，或聯繫：InternationalService@waterpik.com。

通訊時請說明序列號和型號。該號碼位於您產品的底部。替換的噴頭可在 www.waterpik.com 購買，或聯繫 InternationalService@waterpik.com。

Water Pik, Inc. 向這款新產品的原始消費者提供保證，自購買之日起3年內，不存在材料和工藝方面的缺陷。消費者將被要求提交原始購買收據以證明購買日期，並且如有需要，須提交整個產品，以支持保修索賠。Water Pik, Inc. 將自行決定更換其認為有缺陷的產品，前提是確定產品在購買後未被濫用、誤用、塗改或損壞，並且根據說明來使用，僅使用 Water Pik, Inc. 認可的配件或消耗部件。

此有限保修不包括附件或消耗部件，如噴/刷頭等。

使用的電壓不正確會損壞產品並讓保修作廢。

本保修賦予您特定的法律權利。您可能擁有其他權利，具體取決於您居住地的法律。



**Water Pik, Inc., a subsidiary of
Church & Dwight Co., Inc.**



1730 East Prospect Road
Fort Collins, CO 80553-0001 USA
844-821-4873

www.waterpik.com

Designed in USA. Made in China.

美國設計。中國製造。

Form No. 20030488-F AA

©2021 Water Pik, Inc.